

FINISHED FLOOR ELEV. 4693.03'

1063548

1063549

STATE OF COLORADO } ss  
 County of MESA }  
 I hereby certify that this instrument was  
 filed for record

MAR 11 1974

at 1:35 p.m. P. M. and recorded  
 in Book \_\_\_\_\_ Page \_\_\_\_\_  
 ANNIE M. DAVIS, County Clerk & Recorder  
 by \_\_\_\_\_ Deputy

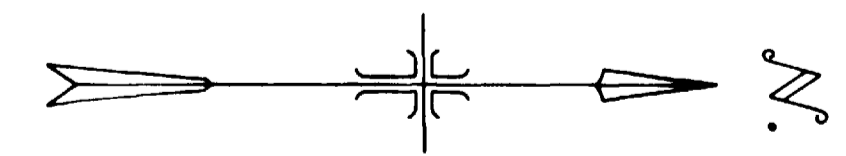

SCALE: 1/8" = 1'-0"

**ELDORADO**  
 3150 LAKESIDE DRIVE  
**LAKEVIEW TERRACE**  
 IN  
**LAKESIDE SUBDIVISION**

SURVEYED L.F. DRAWN R.W.O.  
 WESTERN ENGINEERS, INC. - GRAND JUNCTION, COLO. DWG. 1-429-190

UPPER FLOOR

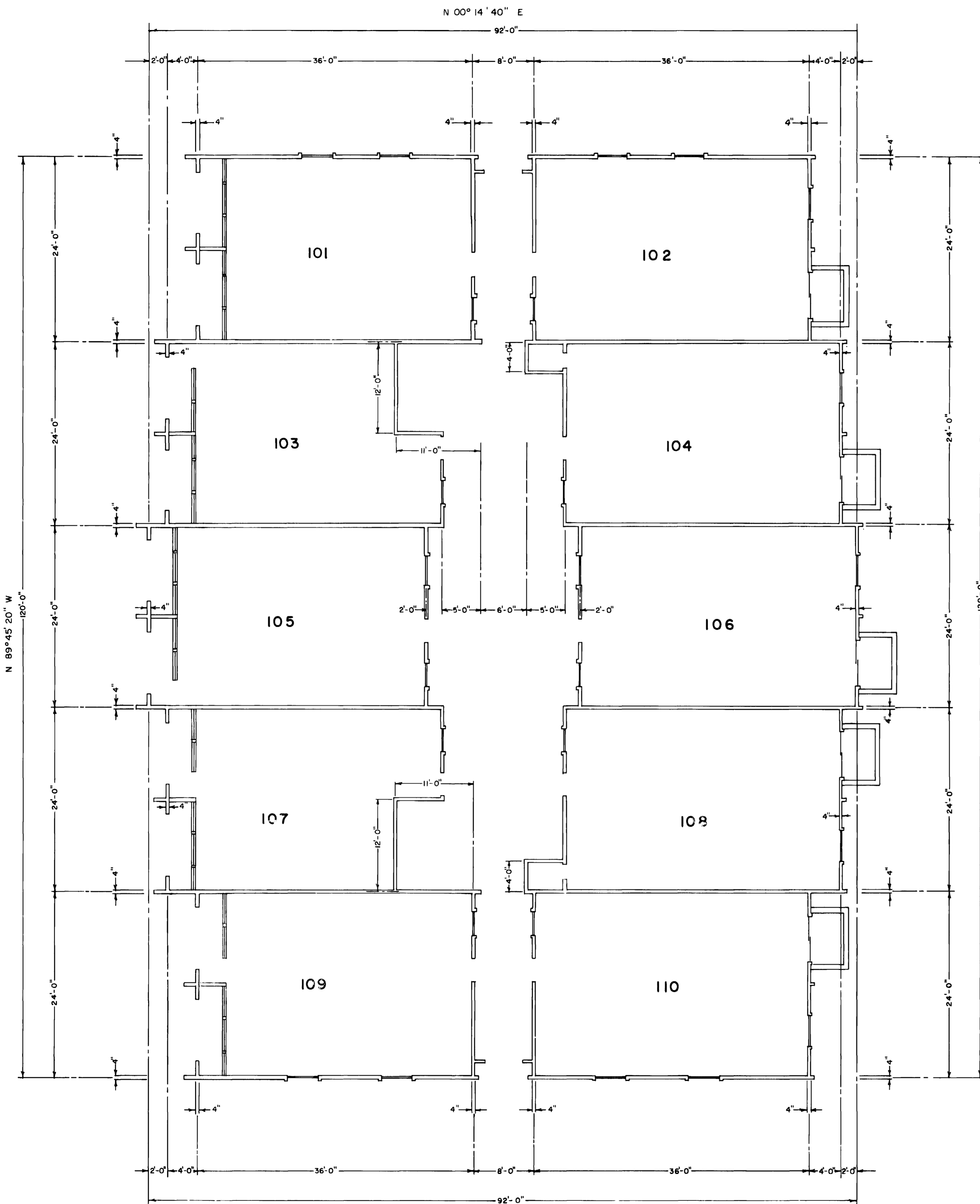

FINISHED FLOOR ELEV. 4675.18

1063  
10635-46

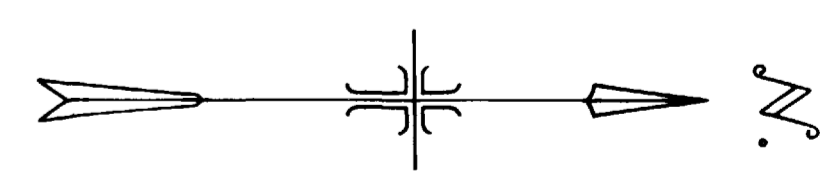

SCALE: 1/8" = 1'-0"

<b>ELDORADO</b>		
3150 LAKESIDE DRIVE		
<b>LAKEVIEW TERRACE</b>		
IN		
<b>LAKESIDE SUBDIVISION</b>		
SURVEYED	L.F.	DRAWN R.W.G.
WESTERN ENGINEERS, INC. GRAND JUNCTION, COLO. DWG. 1-429-19 E		

FIRST FLOOR

01171803.tif

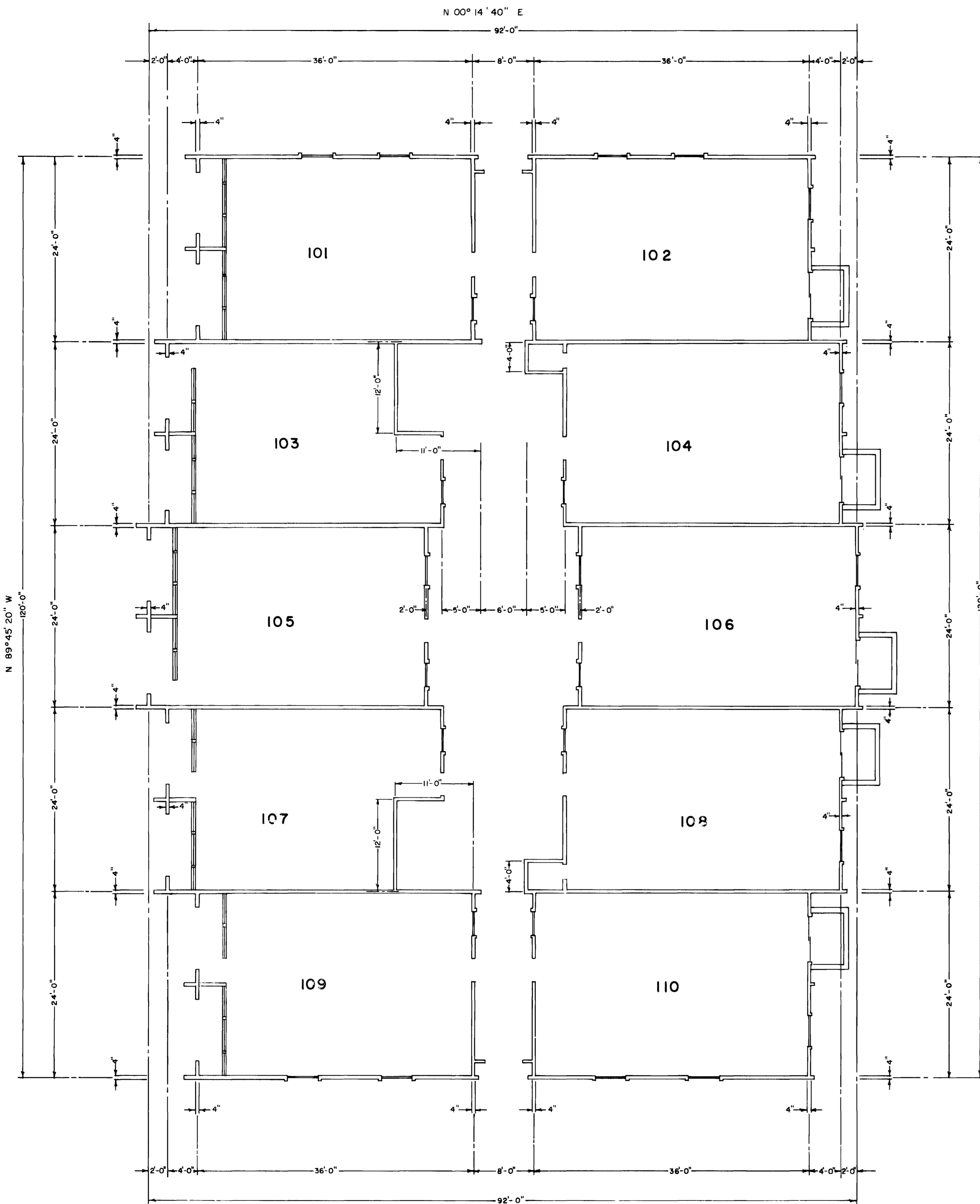

FINISHED FLOOR ELEV. 4675.18

1063  
10635-46

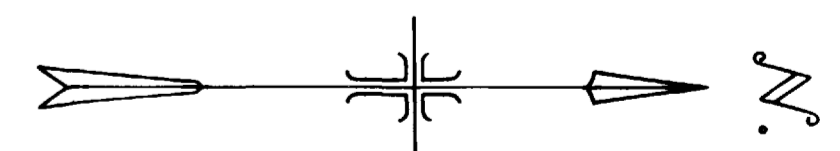

SCALE: 1/8" = 1'-0"

<b>ELDORADO</b>		
3150 LAKESIDE DRIVE		
<b>LAKEVIEW TERRACE</b>		
IN		
<b>LAKESIDE SUBDIVISION</b>		
SURVEYED	L.F.	DRAWN R.W.G.
WESTERN ENGINEERS, INC. GRAND JUNCTION, COLO. DWG. 1-429-19 E		

FIRST FLOOR

01171803.tif