

SCALE: 1/8" = 1'-0"

**BUILDING PLAN**  
 961 LAKESIDE DRIVE  
**CHRISTIANNA BUILDING**  
 IN  
 LAKESIDE SUBDIVISION

ELEV. 4693.35

**UPPER FLOOR**

SURVEYED D.B. DRAWN R.W.G. CHECKED C.J.B.  
 WESTERN ENGINEERS, INC. - GRAND JUNCTION, COLO. DWG. 1011, 429, 54, F

01175701.tif

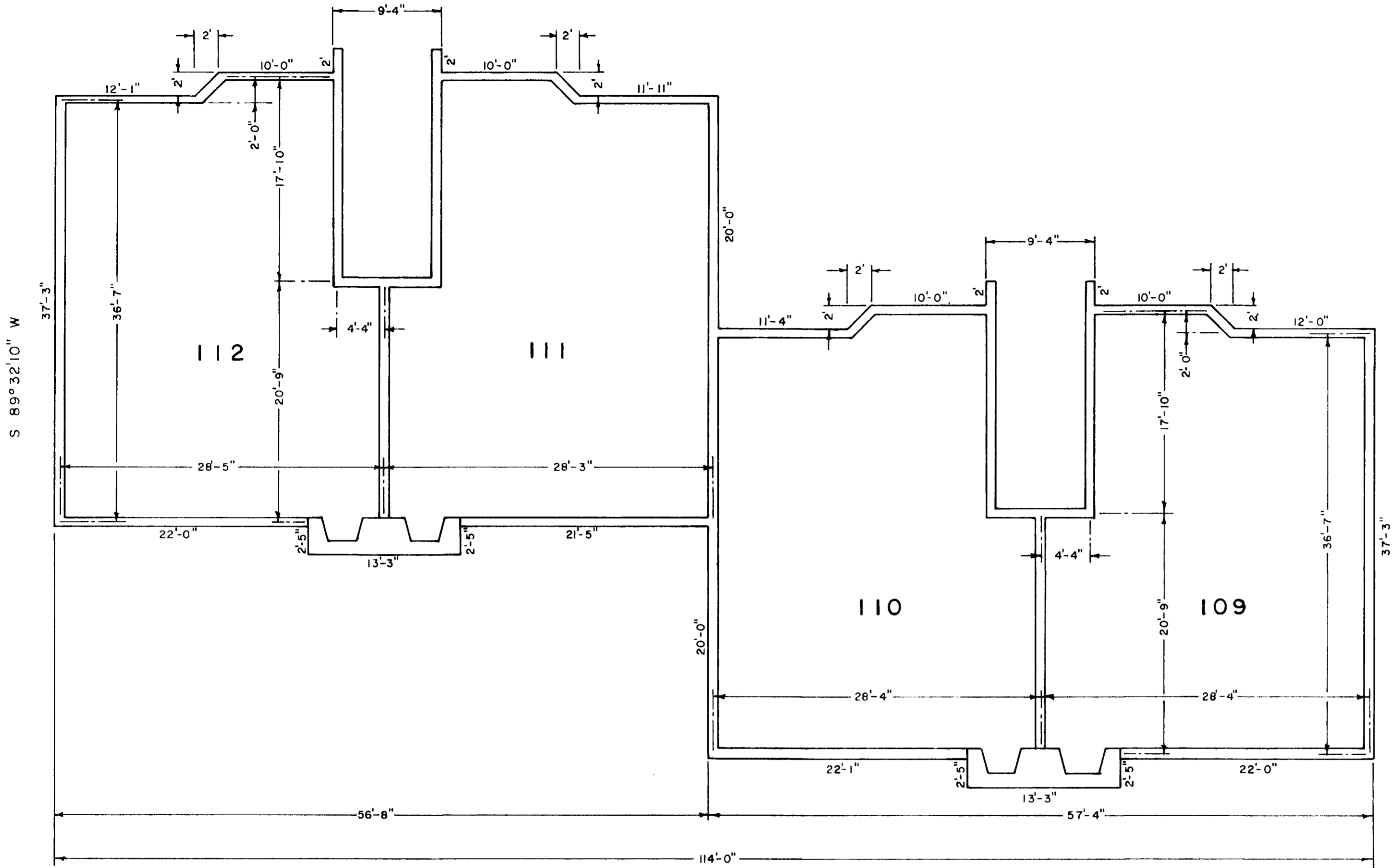

S 89° 32' 10" W

N 00° 27' 50" W

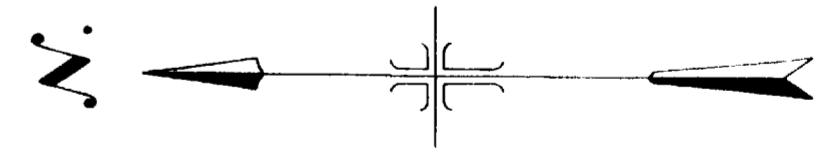

SCALE: 1/8" = 1'-0"

<b>BUILDING PLAN</b>		
961 LAKESIDE DRIVE		
<b>CHRISTIANNA BUILDING</b>		
IN		
<b>LAKESIDE SUBDIVISION</b>		
SURVEYED	D.B.	CHECKED C.J.B.
DRAWN R.W.Q.		
WESTERN ENGINEERS, INC. - GRAND JUNCTION, COLO. DWG 1016-429-34 E		

ELEV. 4675.37

**LOWER FLOOR**

01175703.tif

**AMENDED SITE AND PLOT PLAN**  
**CHRISTIANNA BUILDINGS-CHRISTIANN CONDOMINIUM**  
 961 LAKESIDE DRIVE  
 LAKESIDE SUBDIVISION

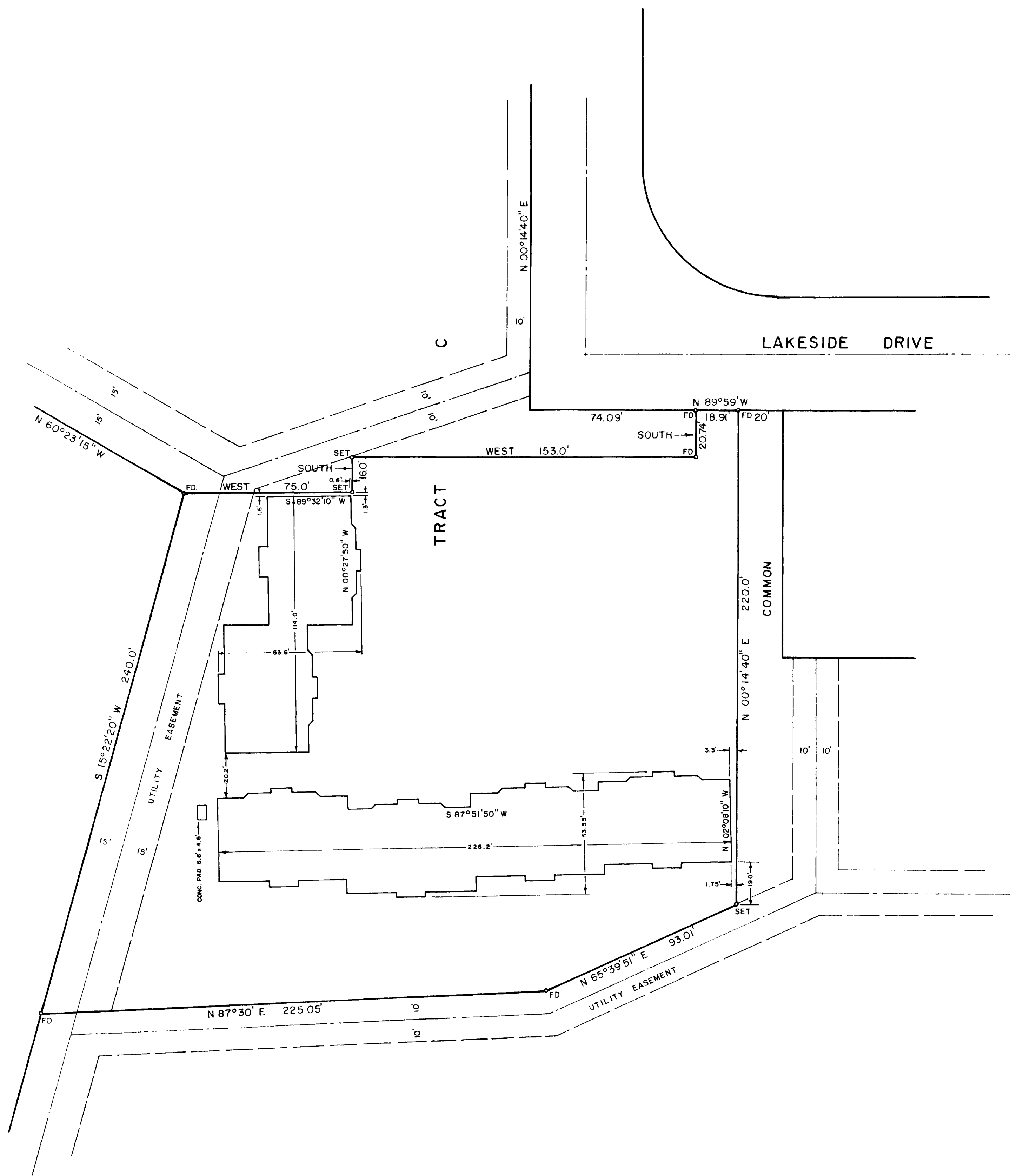

OWNER'S CERTIFICATE

T. L. Benson, Inc. A Colorado Corporation, owner of the herein described real property, does hereby certify that this map of Christianna Buildings of the Christianna Condominium has been prepared pursuant to the declarations of Lakeside Planned Unit Development as recorded with the Clerk and Recorder of Mesa County, Colorado.

T. L. BENSON, INC., A Colorado Corp.

By: *T. L. Benson*  
 T. L. Benson, President

Attested: *Marion J. Benson*  
 Marion J. Benson, Secretary

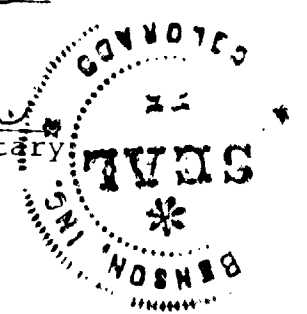

STATE OF COLORADO } ss  
 COUNTY OF MESA }

The foregoing instrument was acknowledged before me this 10<sup>th</sup> day of August, A.D. 1978 by T. L. Benson, President of T. L. Benson, Inc., A Colorado Corporation.

My Commission Expires Sept 11, 1981

Witness my Hand and official Seal

*Steve R. Carpenter*  
 Notary Public

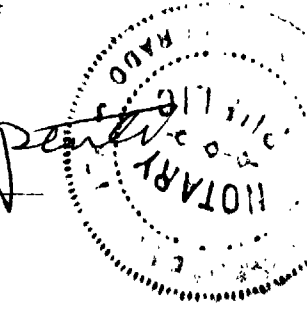

SURVEYOR'S CERTIFICATE

I, J. Boyd Peterson, do hereby certify that this plat was made from notes of a field survey made under my direct responsibility, supervision and checking. Said plat represents the location of the Christianna Buildings of the Christianna Condominium, a part of Tract C of Lakeside Subdivision, City of Grand Junction, County of Mesa, State of Colorado.

*J. Boyd Peterson*  
 J. Boyd Peterson, L.S. 5837

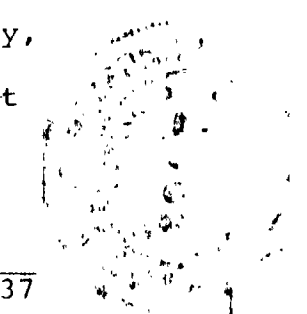

This Amended Site and Plot Plan is being filed to correct that certain Site and Plot Plan as filed in the Office of the Clerk and Recorder of Mesa County at Reception No. 1120805.

1168223

STATE OF COLORADO } ss  
 County of MESA }  
 I hereby certify that this instrument was  
 Filed for record

AUG 11 1978  
 at 10:40 o'clock A.M. and recorded  
 in Book \_\_\_\_\_ Page \_\_\_\_\_  
 By EARL SAWYER, County Clerk & Recorder

0-65 FILED

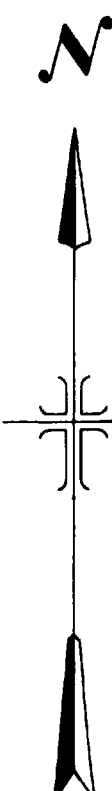

SCALE: 1" = 30'

**AMENDED**  
**SITE & PLOT PLAN**  
 961 LAKESIDE DRIVE  
 CHRISTIANNA BUILDINGS  
 CHRISTIANNA CONDOMINIUM  
 IN  
 LAKESIDE SUBDIVISION  
 CITY OF GRAND JUNCTION  
 MESA COUNTY, COLORADO

REVISED 8/10/78

SURVEYED D.B. DRAWN R.W.Q. CHECKED C.J.B.  
 WESTERN ENGINEERS, INC. - GRAND JUNCTION, COLO. DWG. 1018-425-34A

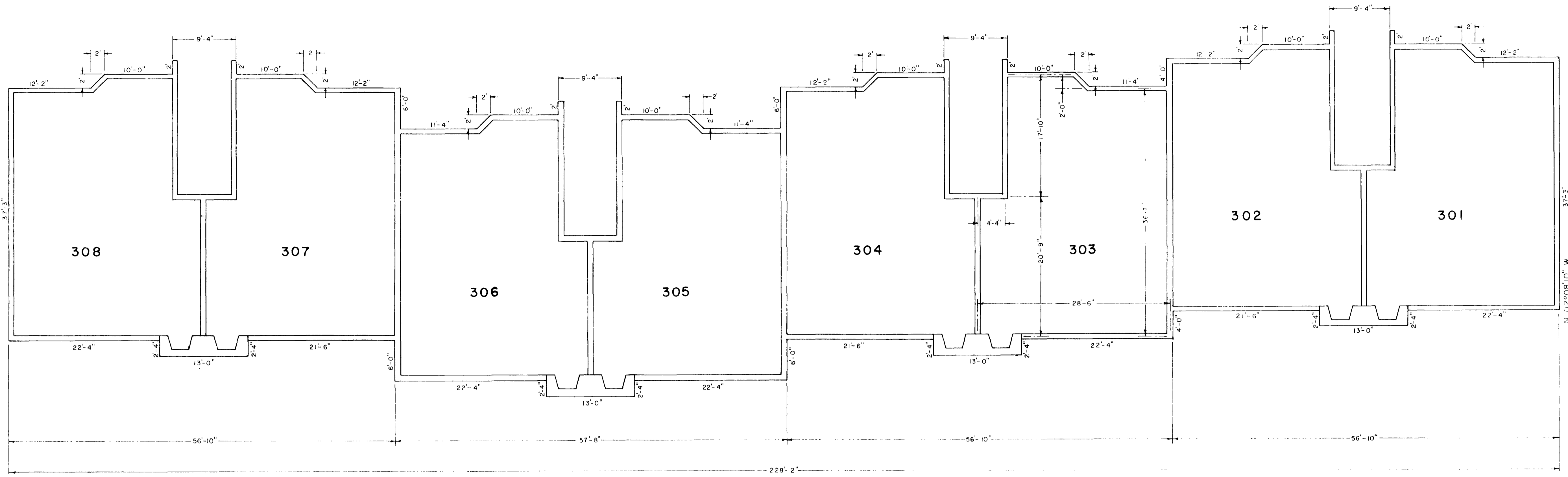

S 87°51'50" W

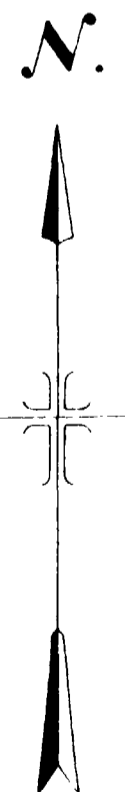

SCALE: 1/8" = 1'-0"

**BUILDING PLAN**  
 961 LAKESIDE DRIVE  
**CHRISTIANNA BUILDING**  
 IN  
 LAKESIDE SUBDIVISION

ELEV. 4693.69

**UPPER FLOOR**

SURVEYED D.B. DRAWN R.W.Q. CHECKED C.J.B.  
 WESTERN ENGINEERS, INC. - GRAND JUNCTION, COLO. DWG. 1016-429-34 D.

01175705.tif

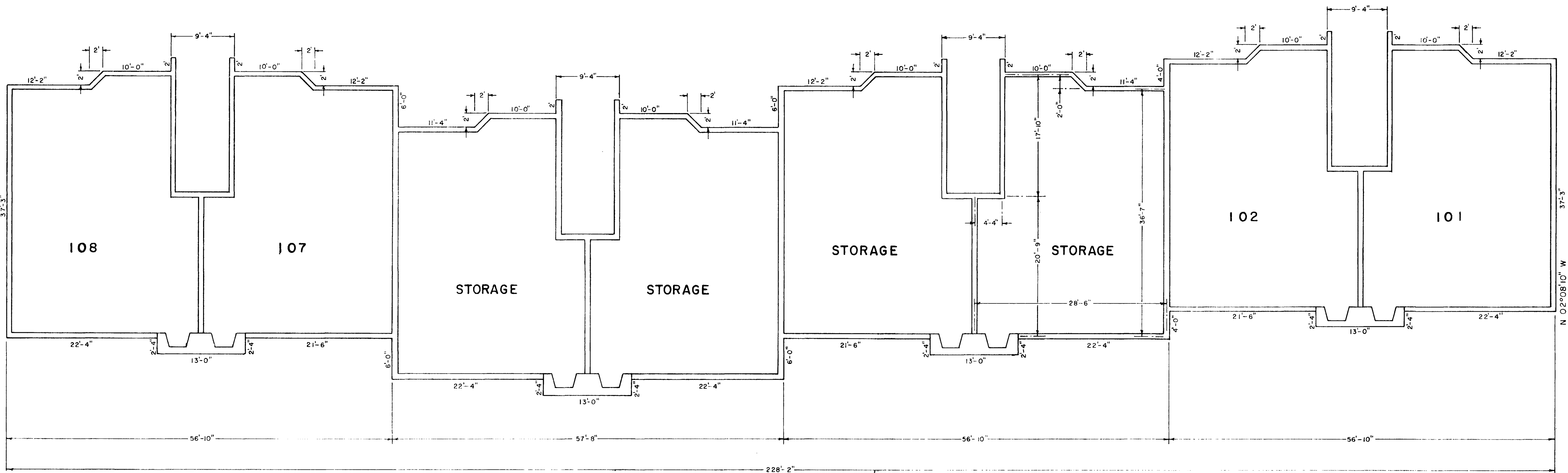

S 87°51'50" W

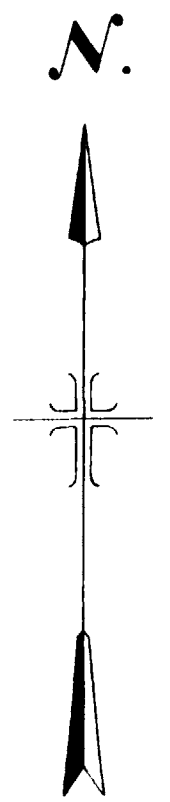

SCALE: 1/8" = 1'-0"

<b>BUILDING PLAN</b>			
961 LAKESIDE DRIVE			
<b>CHRISTIANNA BUILDING</b>			
IN			
LAKESIDE SUBDIVISION			
SURVEYED	D.B.	DRAWN	R.W.Q.
		CHECKED	C.J.B.
WESTERN ENGINEERS, INC. - GRAND JUNCTION, COLO. DWG. 1016-429-34 B			

ELEV. 4675.78

LOWER FLOOR

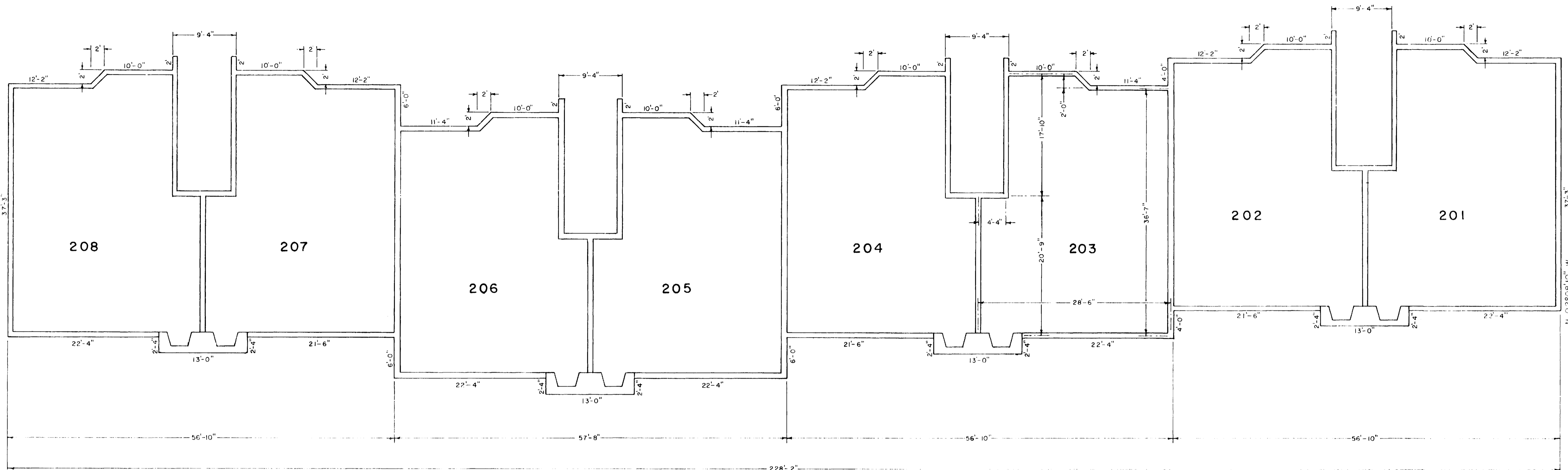

S 87°51'50" W

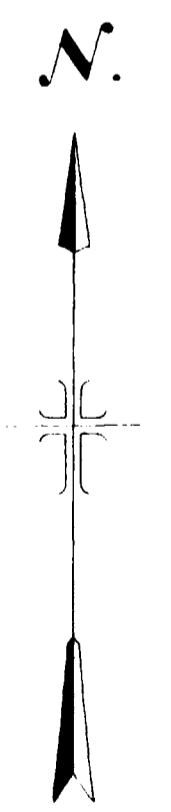

SCALE: 1/8" = 1'-0"

**BUILDING PLAN**  
 961 LAKESIDE DRIVE  
**CHRISTIANNA BUILDING**  
 IN  
 LAKESIDE SUBDIVISION

ELEV. 4684.69

**MIDDLE FLOOR**

SURVEYED... D.B. DRAWN... R.W.O. CHECKED... C.J.B.  
 WESTERN ENGINEERS, INC. - GRAND JUNCTION, COLO. DWG. 1016-429-34-C

01175707.tif