

CONDOMINIUM MAP OF WESTWOOD ESTATES

BUILDING 800
CITY OF GRAND JUNCTION
MESA COUNTY, COLORADO

OWNERS CERTIFICATE

T. L. Benson, Inc., a Colorado Corporation, by T. L. Benson, President, and Marion J. Benson, Secretary, as owners of the herein described real property, does hereby certify that this map of WESTWOOD ESTATES Condominium, Building 800, has been prepared pursuant to the declarations of WESTWOOD ESTATES Condominium recorded August 11, 1980, Book No. 1269, Page 697, in the records of Mesa County, Colorado.

Corporate Seal

Attest:

T. L. BENSON, INC.

Marion J. Benson
Marion J. Benson, Secretary

T. L. Benson
T. L. Benson, President

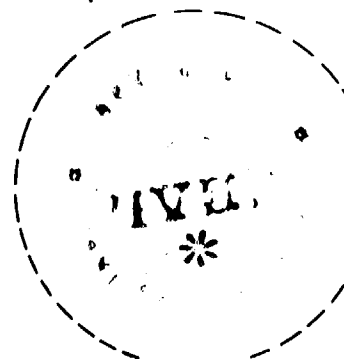

STATE OF COLORADO)
COUNTY OF MESA)

The foregoing instrument was acknowledged before me this 10th day of July, A.D., 1981, by T. L. Benson, President, and Marion J. Benson, Secretary, as officers of T. L. Benson, Inc., owner of WESTWOOD ESTATES.

Witness my hand and official seal.

My commission expires Jan 6, 1985.

William M. Gentry
Notary Public

CLERK AND RECORDERS CERTIFICATE

STATE OF COLORADO)
COUNTY OF MESA)

RECEPTION No. 1262613

I hereby certify that this instrument was filed in my office at 10 o'clock P.M., this 10 day of JULY, A.D., 1981, and is duly recorded in DRAWER S-52.

Earl Sawyer
Clerk and Recorder

Mary Baker Deputy
Fees \$ 10.00

SURVEYOR'S CERTIFICATE

I, J. Boyd Peterson, do hereby certify that this plat was made from notes of a field survey made under my direct responsibility, supervision, and checking. Said plat represents the location of the WESTWOOD ESTATES Condominium, Building 800, in WESTWOOD, a part of the City of Grand Junction, County of Mesa, as filed in the Office of the Clerk and Recorder of Mesa County, in Plat Book No. 12, Page 209. And I further certify that the Condominium map substantially depicts the location of the building, the units, the unit designation, the dimensions of the units and the building number. Such condominium map was prepared subsequent to substantial completion of the improvements.

J. Boyd Peterson
J. Boyd Peterson,
Colo. Reg. No. 5837

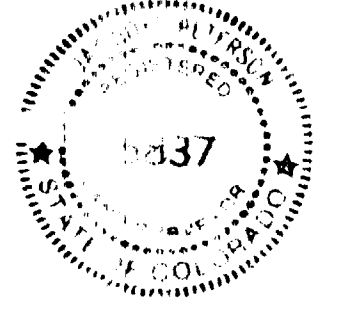

NOTES:

- (1) GCE Indicates General Common Elements.
LCE Indicates Limited Common Elements.
- (2) The interior portions of the Fireplace and the Chimney Flue are contained in the Air Space Unit. The bricks of the chimney on the outside wall and above the roof are GCE.
- (3) All Unit dimensions and elevations are to unfinished walls, floors, and ceilings.
- (4) For general layout of project and reference to other Buildings see Condominium Map of WESTWOOD ESTATES, General Layout, as filed in 9-13, in the records of Mesa County, Colorado.

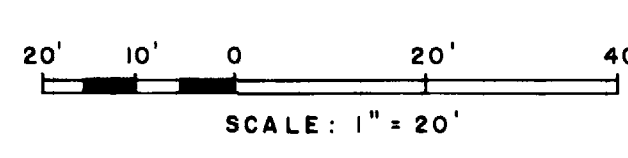
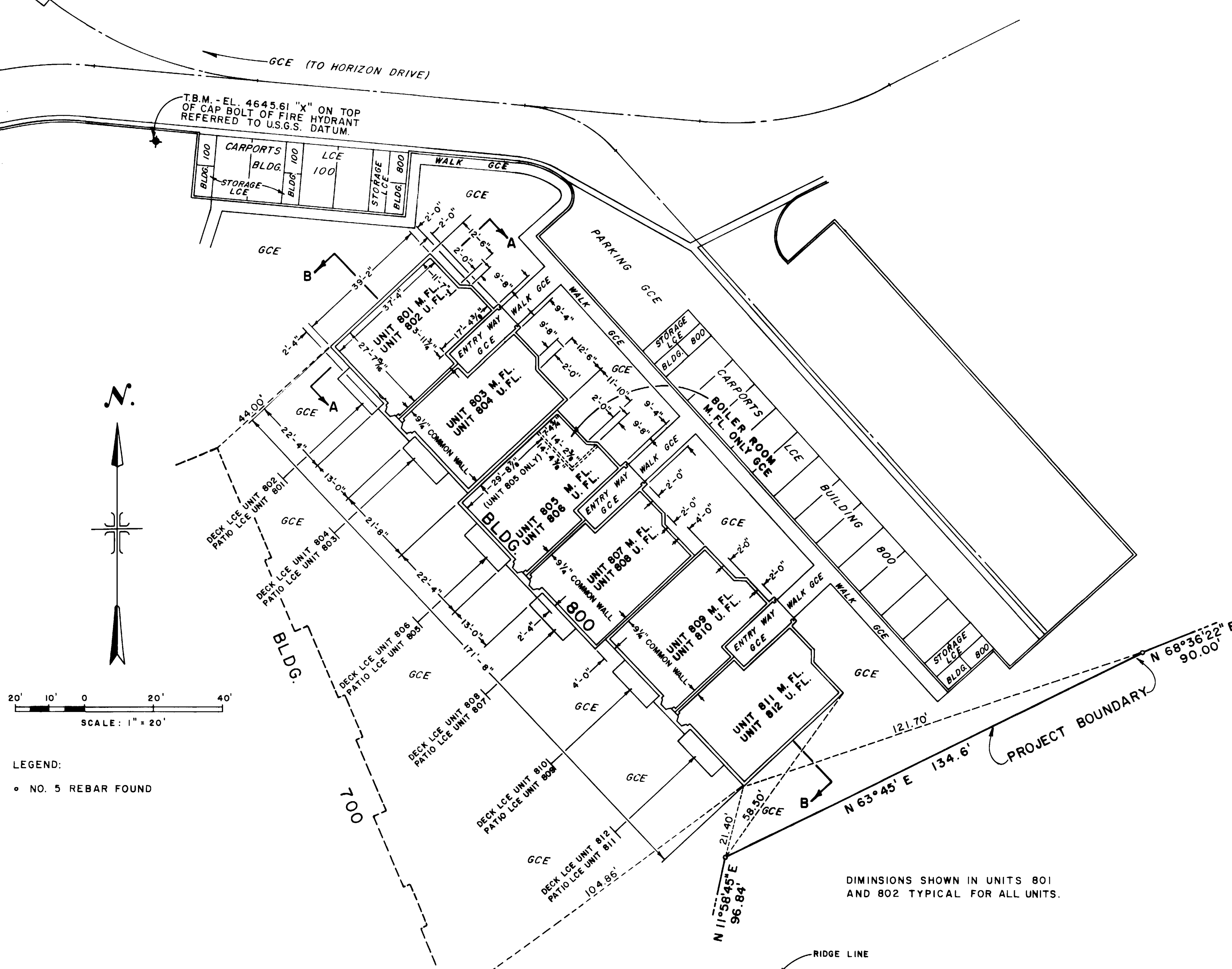

LEGEND:
• NO. 5 REBAR FOUND

DIMENSIONS SHOWN IN UNITS 801 AND 802 TYPICAL FOR ALL UNITS.

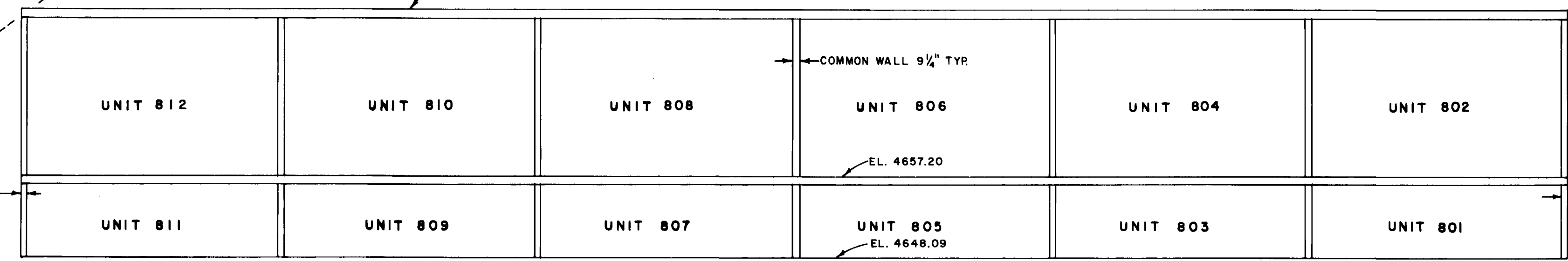
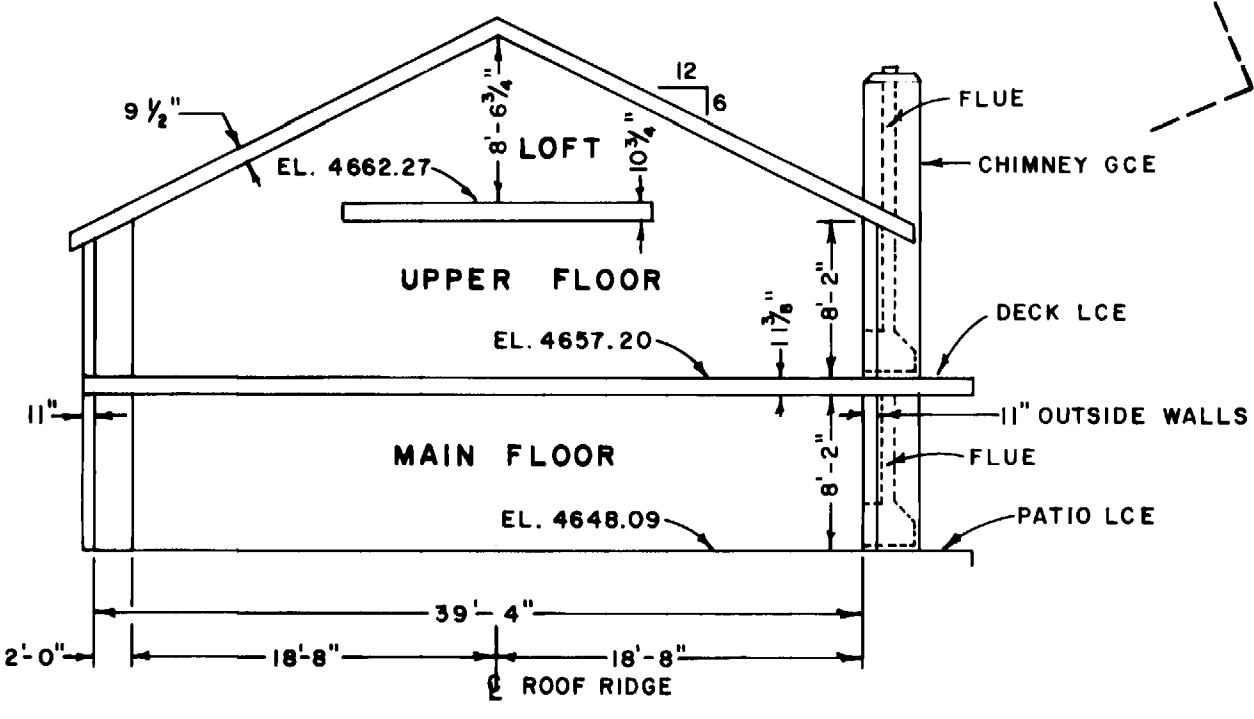

(VIEWED FROM ENTRY WAY)

NOTICE: According to Colorado law you must commence any legal action based upon any defect in this survey within six years after you first discover such defect. In no event, may any action based upon any defect in this survey be commenced more than ten years from the date of the certification shown hereon.

WESTERN ENGINEERS, INC.
CONDOMINIUM MAP OF
WESTWOOD ESTATES
BUILDING 800
CITY OF GRAND JUNCTION
MESA COUNTY, COLORADO

SURVEYED 1-9 DRAWN R.H.Q. CHECKED J.B.P.
GRAND JUNCTION, COLO. DWG. 750-429-58 7/7/81