

MAP OF LAKE VIEW PLACE

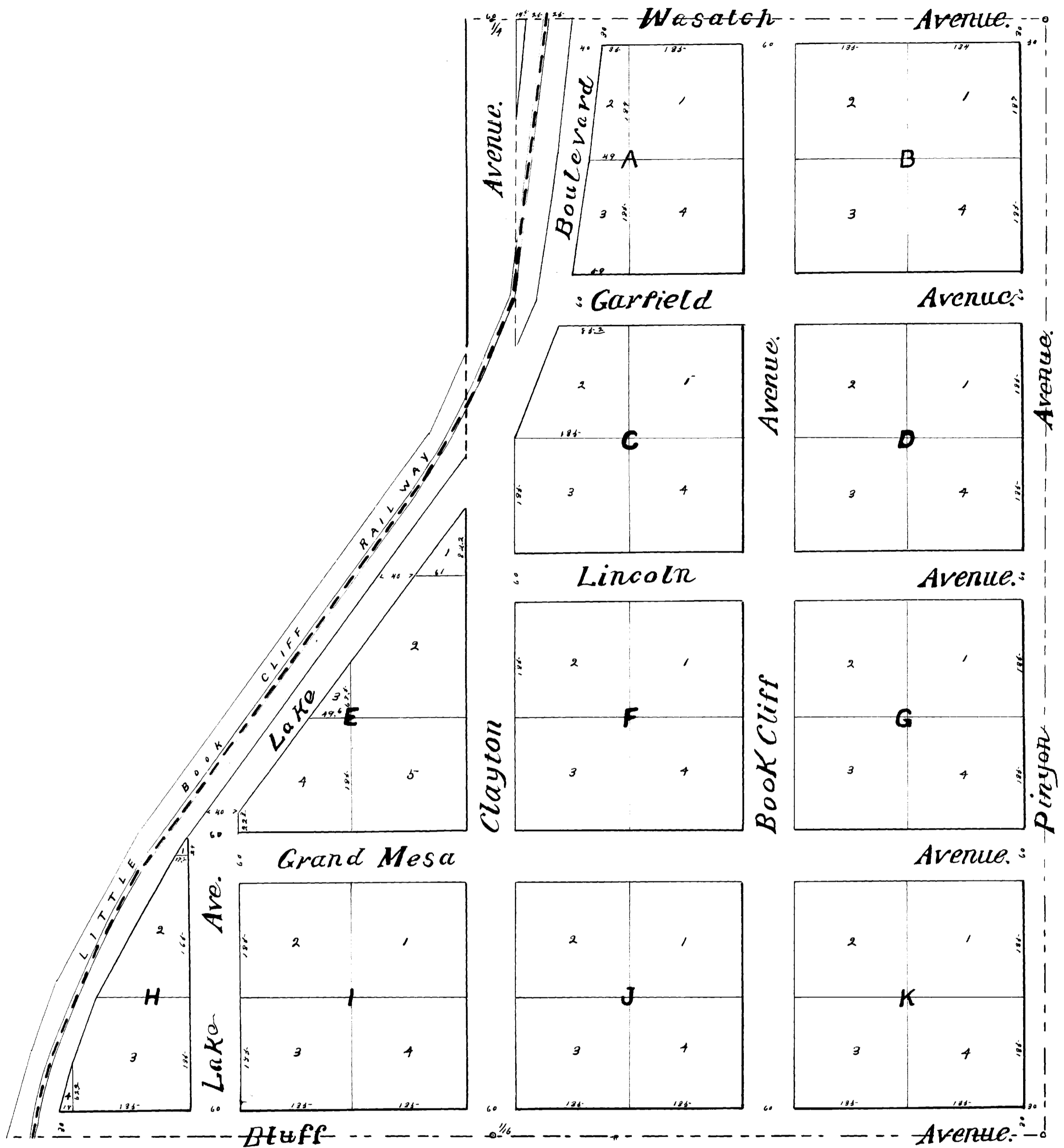

Dedication.

Know All Men by These Presents, that I have laid out and platted, under the name of Lake View Place, the following described tract of land, to-wit: The West One Half of the Northwest Quarter (1/4) of the Southwest Quarter (1/4) of Section One (1) in Twp. One (1) South, of Range One (1) West, Ute P.M., and all that portion of the Northeast Quarter (1/4) to the Southeast Quarter (1/4) of Section Two (2) in Twp. One (1) South, of Range One (1) West, Ute P.M. which lies east of the Right of Way of the Little Book Cliff Railway.

And I hereby dedicate to the use of the public, forever, all streets, roadways, and avenues indicated on the accompanying plat.

Thomas C. Clayton

State of Colorado,
County of Mesa

I, J. H. Ramey, a Notary Public in and for said County, in the State aforesaid, do hereby certify that Thomas C. Clayton, personally known to me to be the person whose name is subscribed to the foregoing dedication, appeared before me this day in person, and acknowledged that he signed, stated, and delivered the said instrument as his free and voluntary act, for the uses and purposes therein set forth.

Given under my hand and Notarial seal on this 12th day of May, A.D. 1894.

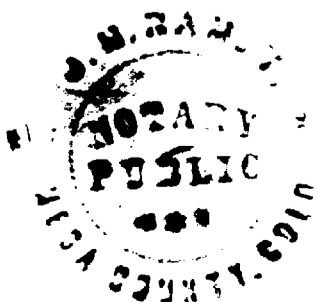

J. H. Ramey
Notary Public

My Commission Expires July 16, 1895.