

# CONDOMINIUM MAP OF MONUMENT PARK CONDOMINIUM

### CERTIFICATION

MONUMENT VIEW LLC a Nevada limited liability company, dba MONUMENT PARK LLC in Colorado, is the owner of a tract of land situated in the NE 1/4 of Section 36, Township 1 North, Range 2 West of the Ute Meridian, City of Grand Junction, Mesa County, Colorado, being more particularly described as follows:

Lot 12 - B of Replat of Lot 12 of VALLEY WEST SUBDIVISION, Filing No. Three, in the City of Grand Junction, County of Mesa, Colorado, as recorded in Plat Book 13, at page 266, Reception No. 1368711 of the Mesa County records.  
Said parcel contains 2.01 acres more or less.

The owner certifies that this Condominium Map of Monument Park Condominium, has been prepared pursuant to the purposes stated in the Declaration for Monument Park Condominium as recorded in Book 4079 Pages 412-432 in the Clerk and Recorder's Office of Mesa County, Colorado.

By: Arthur Pastel  
Manager

### TITLE CERTIFICATION

State of Colorado  
County of Mesa

We, Meridian Land Title LLC a title insurance company, as duly licensed in the State of Colorado, hereby certify that we have examined the title to the hereon described property, that we find the title to the property is vested to Monument View, LLC, a Nevada Limited Liability Company dba Monument Park LLC in Colorado; that the current taxes have been paid; that all mortgages not satisfied or released of record or otherwise terminated by law are shown hereon and that there are no other encumbrances of record; that all easements, reservations and right-of-ways of record are shown hereon.

Date: JANUARY 9, 2006

By: Lawrence J. Vent  
LAWRENCE J. VENT/MERIDIAN LAND TITLE, LLC

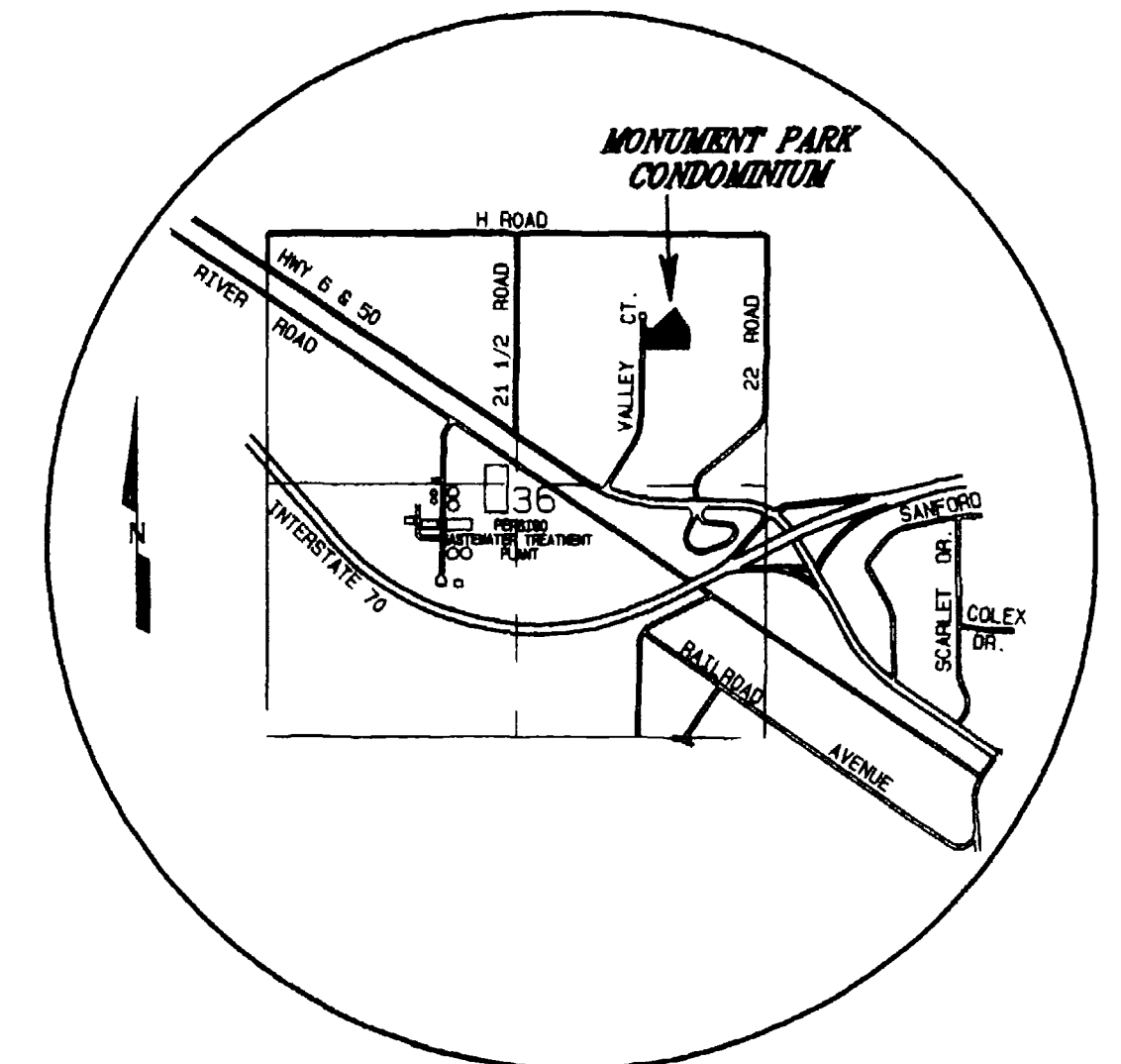

VICINITY MAP  
NOT TO SCALE

### CITY APPROVAL

This condominium map of MONUMENT PARK CONDOMINIUM a condominium in the City of Grand Junction, County of Mesa, State of Colorado,

is approved and accepted on the 21<sup>st</sup> day of January, 2006.

[Signature]  
City Manager

[Signature]  
City Mayor

### CLERK AND RECORDER'S CERTIFICATE

I hereby certify that this instrument was filed for recording in my office at 4:00 o'clock P.M., this 20<sup>th</sup> day of January, A.D. 2006, and is duly recorded in Book No. 4079 at pages 409-411 Reception No. 2297497. Fee \$ 30.00 + 1.00 Drawer No. KK-98

Deputy

Clerk and Recorder

### LIENHOLDERS RATIFICATION OF PLAT

The undersigned, hereby certifies that it is a holder of a security interest upon the property hereon described and does hereby join in and consent to the dedication of the land described in said dedication by the owners thereof and agrees that its security interest which is recorded in Book 3869 at Page 463 of the public records of Mesa County, Colorado, shall be subordinated to the dedications shown hereon.

By: Nancy Woods FOR: WOODS 1992 TRUST

STATE OF COLORADO )  
COUNTY OF MESA ) ss

The foregoing Lienholders Ratification was acknowledged before me this 9<sup>th</sup> day of January, A.D., 2006 by Nancy Woods

Witness my hand and official seal [Signature]  
Notary Public

Address 786 Valley Ct GJ CO 81505  
My commission expires 4.21.2009

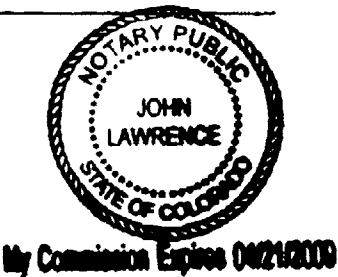

My Commission Expires 04/21/2009

### CONDOMINIUM NOTES

Except for the Units, the entire condominium boundary will be classified as General Common Element.

NOTICE: According to Colorado law you must commence any legal action based upon any defect in the survey within three years after you first discover such defect. In no event may any action based upon any defect in this survey be commenced more than ten years from the date of the certification / statement shown hereon.

~~\_\_\_\_\_~~  
~~\_\_\_\_\_~~  
Mesa County, Colorado. S.S.V.

### SURVEYOR'S STATEMENT

I, Steven L. Hagedorn, a Professional Land Surveyor licensed in the State of Colorado, do hereby state that this map was prepared under my direct supervision, that it depicts the vertical and horizontal locations of each unit shown hereon, and that it was made from measurements upon and within the existing structures. This map contains all the information required by C.R.S. 38-33.3-209. The improvements and units shown hereon are substantially complete.

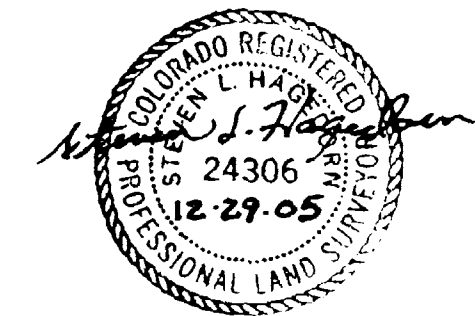

**MONUMENT PARK  
CONDOMINIUM**  
NE1/4, SEC. 36, T.1N., R.2W., Ute Meridian  
**D H SURVEYS INC.**  
118 OURAY AVE. - GRAND JUNCTION, CO.  
(970) 245-8749

Designed By S.L.H.	Checked By M.W.D.	Job No. 708-03-03
Drawn By TMODEL	Date DECEMBER, 2005	Sheet 1 OF 3

# CONDOMINIUM MAP OF MONUMENT PARK CONDOMINIUM

VALLEY COURT

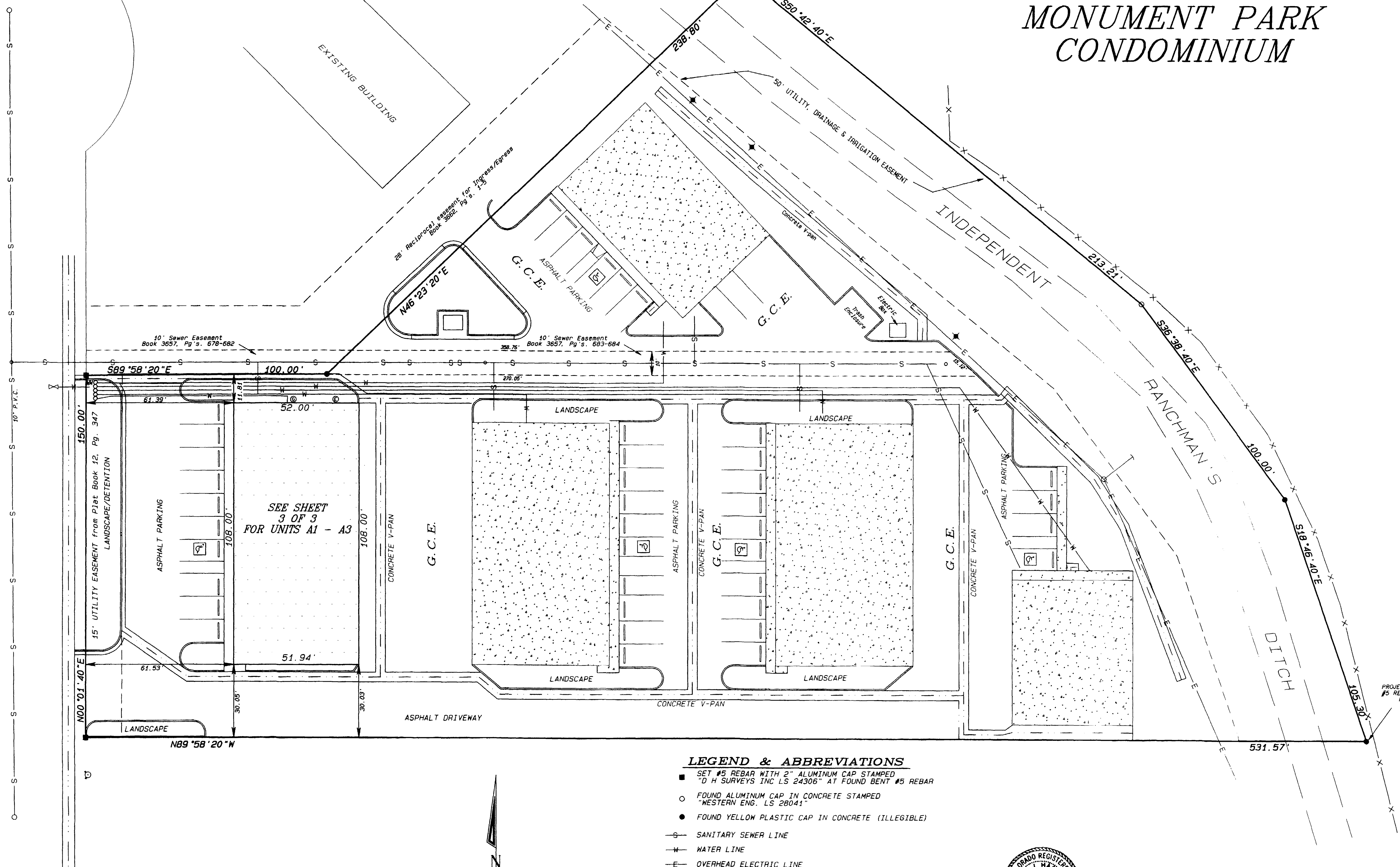

**SURVEYOR'S NOTE**

Except for the Units, the entire condominium boundary will be classified General Common Element.

Offset dimensions shown are from property lines to outside face of foundation wall.

NOTICE: According to Colorado law you must commence any legal action based upon any defect in the survey within three years after you first discover such defect. In no event may any action based upon any defect in this survey be commenced more than ten years from the date of the certification / statement shown hereon.

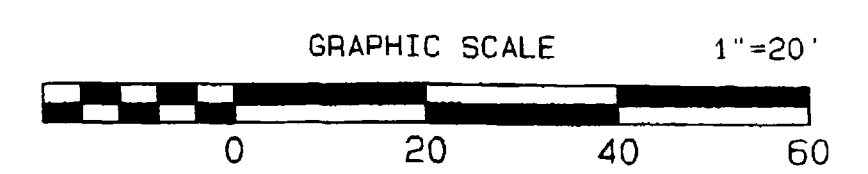

**LEGEND & ABBREVIATIONS**

- SET #5 REBAR WITH 2" ALUMINUM CAP STAMPED "D H SURVEYS INC LS 24306" AT FOUND BENT #5 REBAR
- FOUND ALUMINUM CAP IN CONCRETE STAMPED "WESTERN ENG. LS 28041"
- FOUND YELLOW PLASTIC CAP IN CONCRETE (ILLEGIBLE)
- S— SANITARY SEWER LINE
- W— WATER LINE
- E— OVERHEAD ELECTRIC LINE
- ...— FLOW LINE
- ⊕ FIRE HYDRANT
- I WATER VALVE
- ⊕ POWER POLE
- ⊕ TELEPHONE PEDESTAL
- ⊕ GAS METERS
- ⊕ ELECTRIC METERS
- ⊕ WM WATER METER
- G.C.E. = General Common Element
- CONCRETE

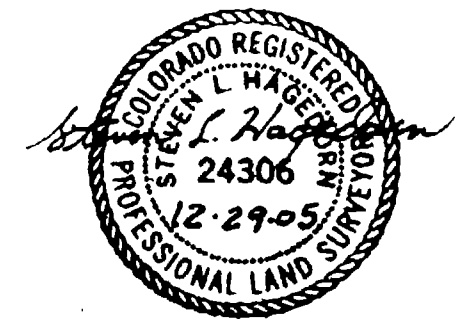

**MONUMENT PARK  
CONDOMINIUM**  
NE 1/4 SE 1/4, SEC. 36, T.1N, R.2W, U.M.  
**D H SURVEYS INC.**  
118 OURAY AVE. - GRAND JUNCTION, CO.  
(970) 245-8749

Designed By S.L.H.	Checked By M.W.D.	Job No. 708-03-03
Drawn By TMODEL	Date DECEMBER, 2005	Sheet 2 OF 3

# CONDOMINIUM MAP OF MONUMENT PARK CONDOMINIUM

SECTION A - A'

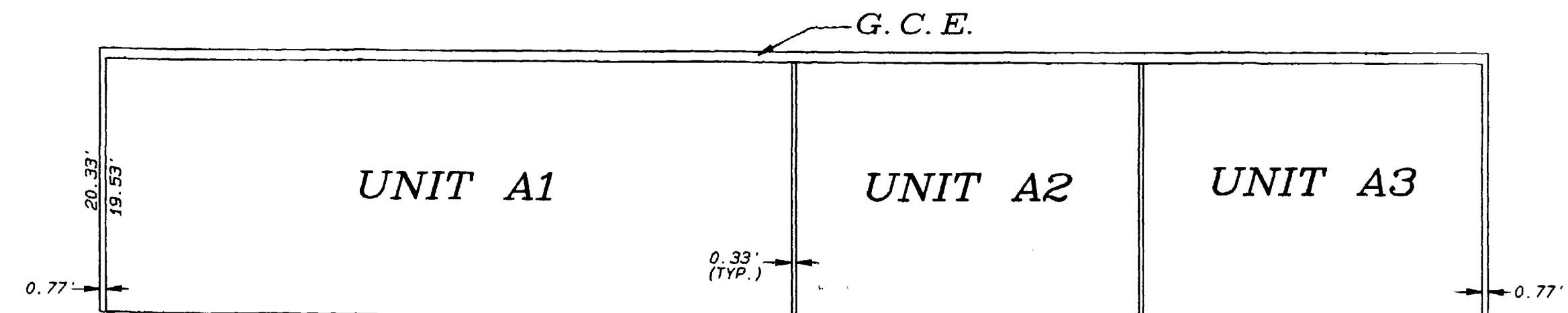

SECTION B - B'

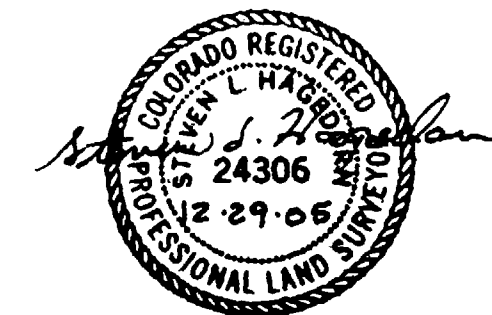
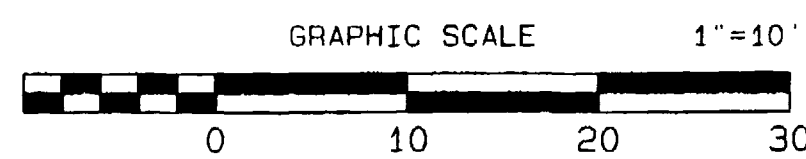
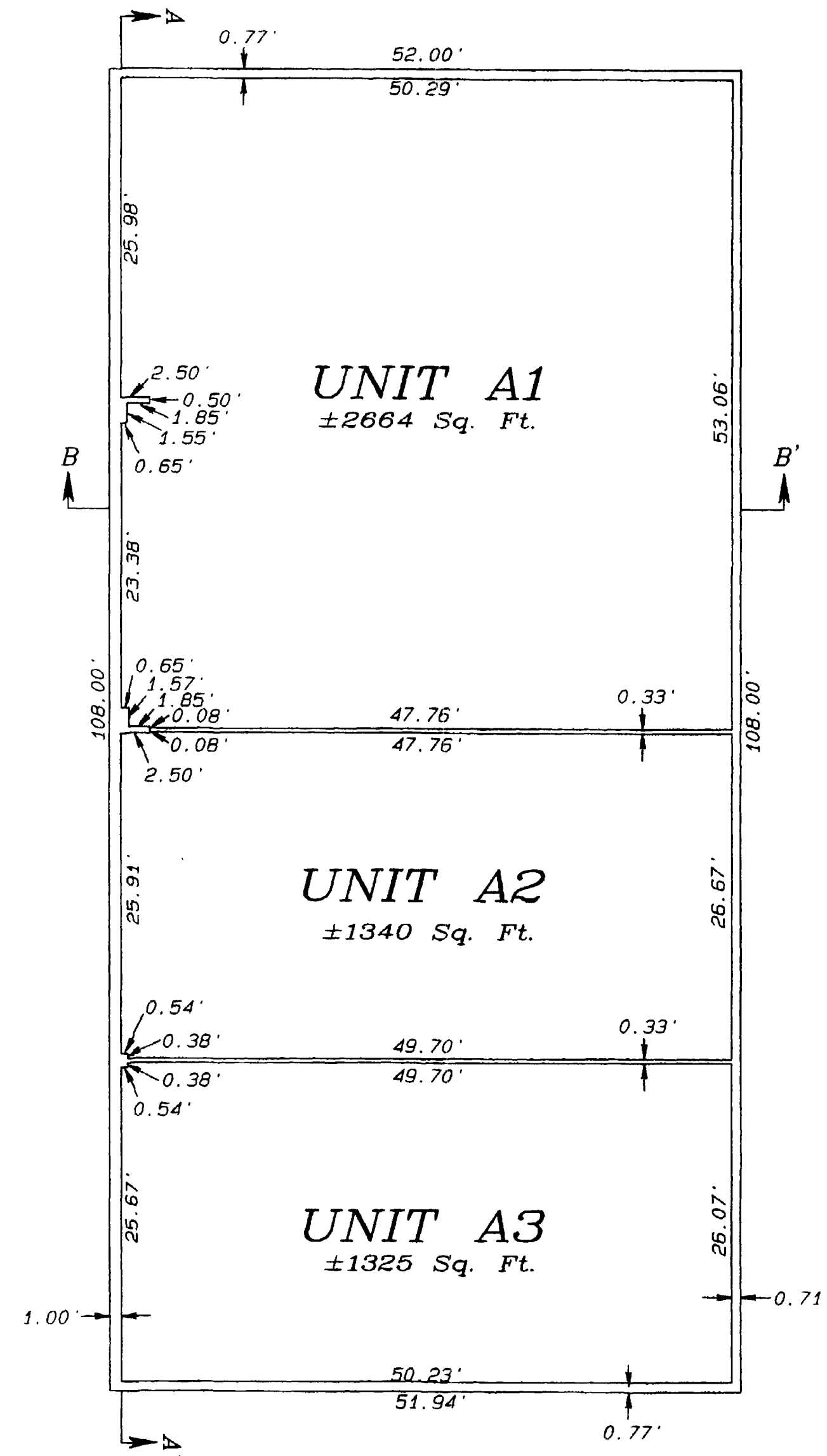
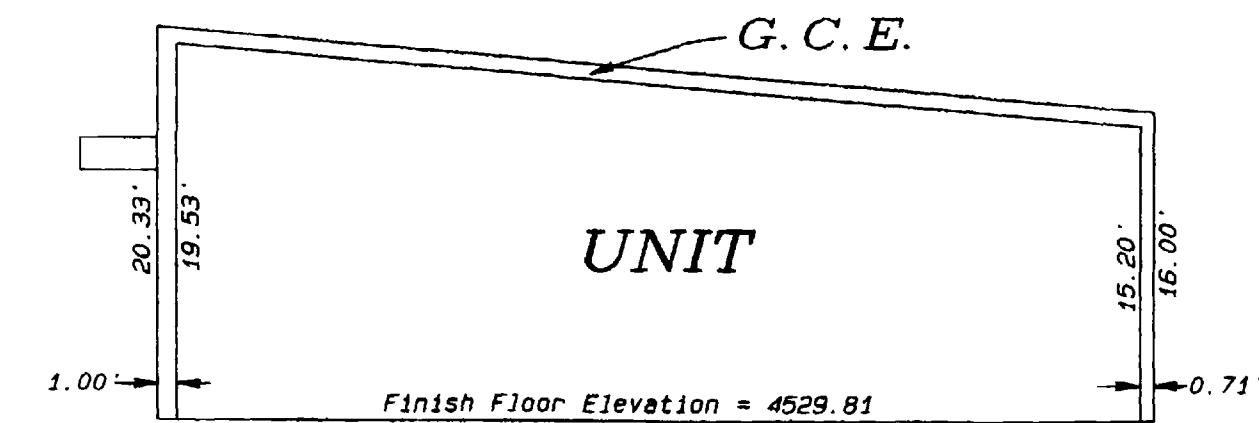

**MONUMENT PARK  
CONDOMINIUM**  
NE 1/4 SE 1/4, SEC. 36, T.1N, R.2W., U.M.  
**D H SURVEYS INC.**  
118 OURAY AVE. - GRAND JUNCTION, CO.  
(970) 245-8749

Designed By S.L.H.	Checked By M.W.D.	Job No. 708-03-03
Drawn By TMODEL	Date DECEMBER, 2005	Sheet 3 OF 3

Except for the Units, the entire condominium boundary will be Classified General Common Element.

NOTICE: According to Colorado law you must commence any legal action based upon any defect in the survey within three years after you first discover such defect. In no event may any action based upon any defect in this survey be commenced more than ten years from the date of this certification/statement shown hereon.