

Dev. in N.O.

Subdivision _____

Date _____

Item # _____

Petitioner _____

Preliminary
Review Agencies Comments

Final
Review Agencies Comments

*Cancelled
by
Petitioners*



Action Taken

Action Taken

P.C. _____

P.C. _____

C.C. _____

C.C. _____

Comments

Comments



ITEMS REQUIRED FROM DEVELOPER

- Check Utility Agreement Title Investigation
- Drainage Landscaping Covenants
- Improvements Guarantee Annexation Other (Specify)

Location - 12th & UTE Ave.

Present building to be used for
Muffler Shop.

30 x 30 Addition to be used
for cycle shop & show room
for motorcycles.

WORK
PHONE
POST OFFICE → Jim 222-6776
245-3445 Home
Ray Patton
Lee Lee
Post Office
243-4201
#265

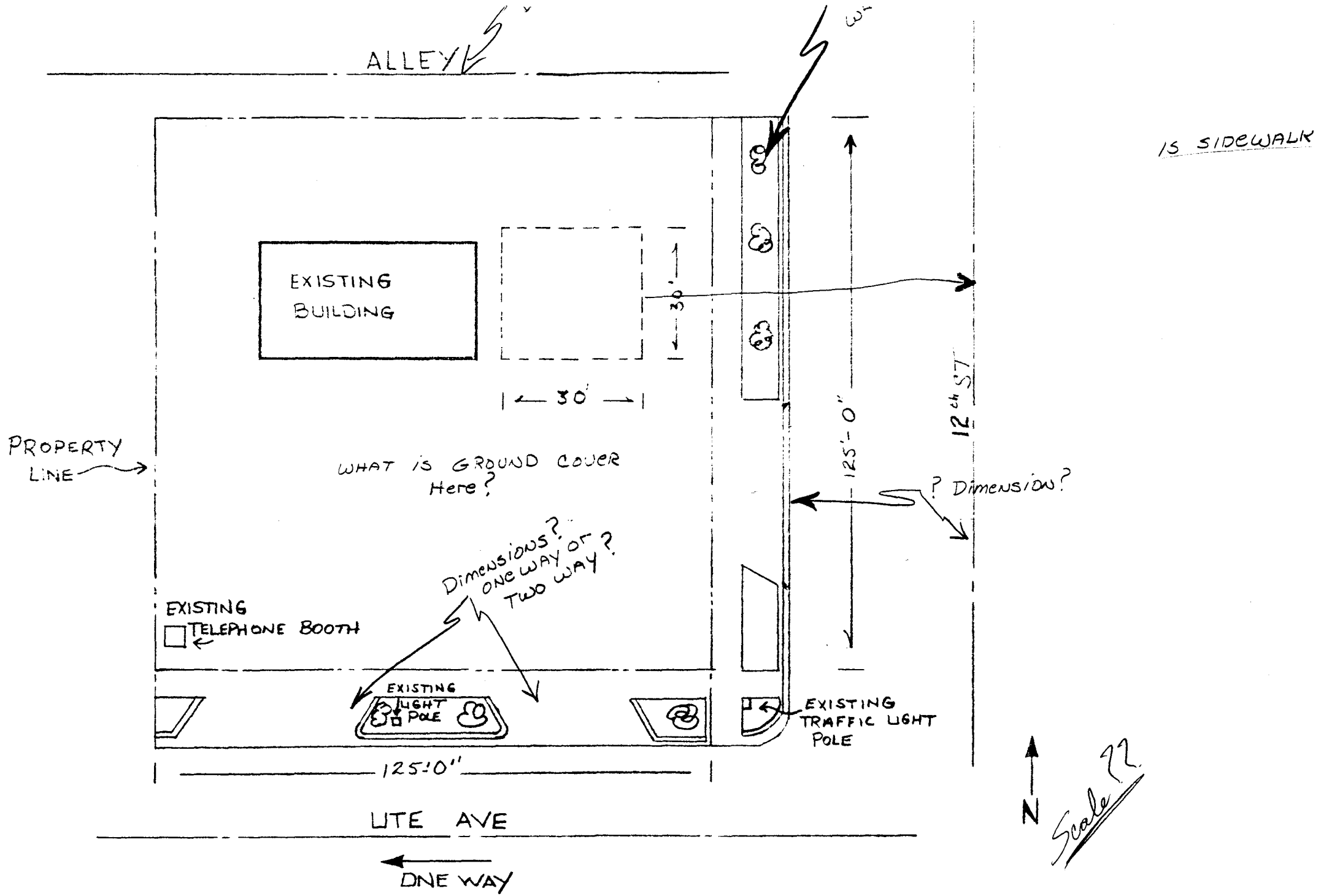

LOTS 18, 19, 20, 21 & 22 BLOCK 132
 CITY OF GRAND JUNCTION, COLO.