

Ye old Saloon

CONDITIONAL Use

Tabled 25 May 97 for review of
parking.

no record of it being brought up again

THE NORTH SIDE OF EXISTING BUILDING AS WELL AS THE FRONT OF BUILDING W/S WILL BE COVERED WITH 1" X 10" ROUGH BOARDS. CONCRETE WILL BE USED TO LEVEL AN AREA

12' X 15' TO THE NORTH OF EXISTING ENTRANCE AND A AREA OF 12' X 27' TO THE SOUTH OF EXISTING ENTRANCE WAY. 1" X 10" BOARDS COVERING CEMENT FOR A BOARD WALK EFFECT WHICH TABLES 3' X 4' AND BENCHES 12" X 4' WILL BE SAT UPON WITH A 12' X 52' SHINGLED ROOF BUILT ACCORDING TO CITY BUILDING PERMIT & FIRE CODE SPECIFICATIONS, WILL COVER & SHADE. AN APPROX. 12' X 52' FENCED, WITH A 3' WALKWAY, DECORATIVE FRONTING WILL BE MADE FOR BEAUTIFICATION PURPOSES.

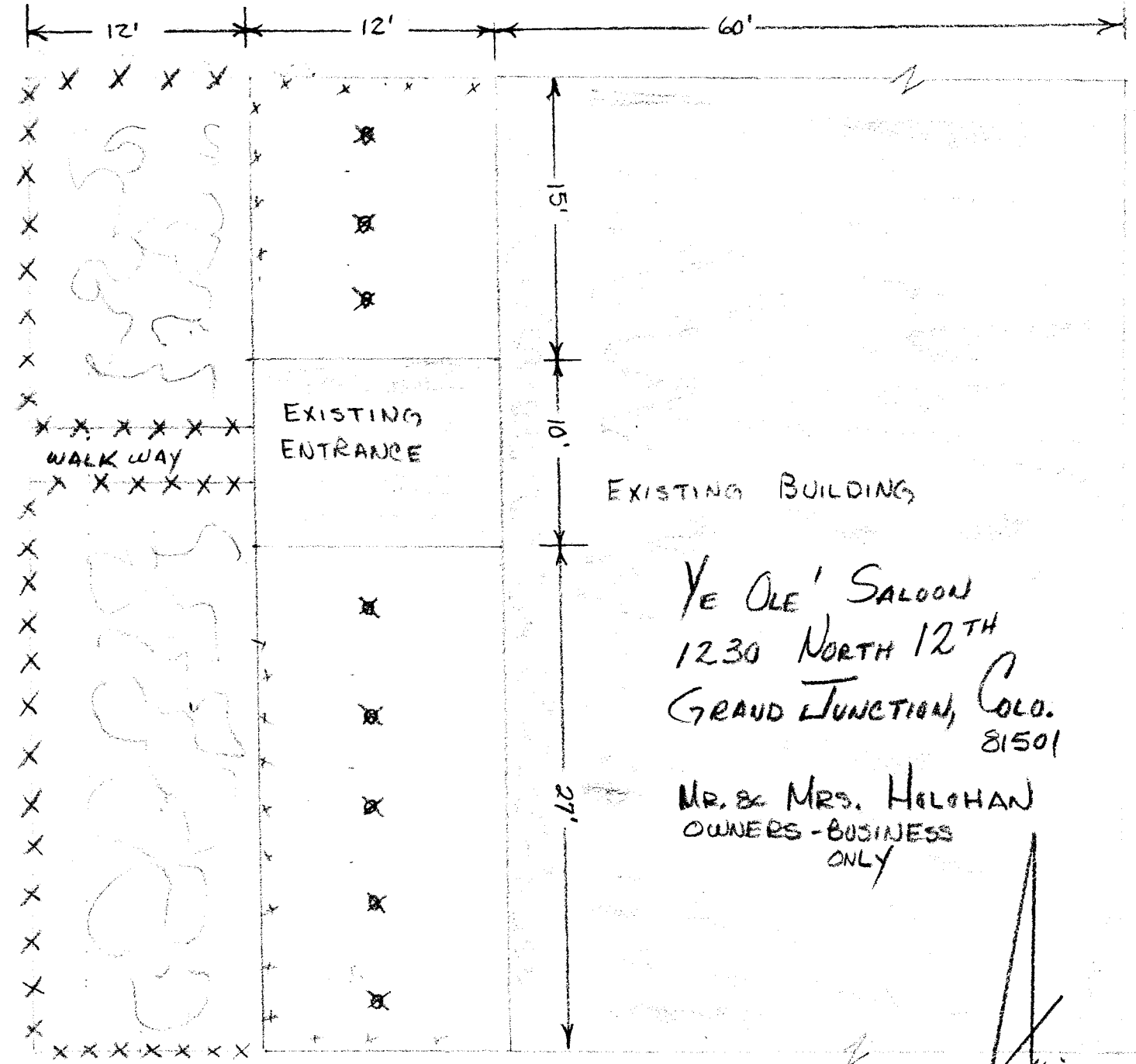

YE OLE' SALOON
 1230 NORTH 12TH
 GRAND JUNCTION, COLO.
 81501

MR. & MRS. HELGHAN
 OWNERS - BUSINESS ONLY

- ⊗ = TABLES
- X = FENCING
- S = DECORATION ROCK

THIS AREA WILL SERVE AS A PLACE FOR EATING & REFRESHMENTS INCL. BEER FROM 12 PM TO 6 P.M.

