

IMPACT STATEMENT/PROJECT NARRATIVE

This is a proposal to build a 70 foot self supporting radio tower next to the Mantey Heights water tank inside of fence, Property #2943-072-00-944, to be built by February 28, 1988. There is already a two million gallon water tank on this city owned property. This will be for radio antennas for the Grand Junction Fire Department, as well as all Rural and Volunteer Fire Department in the County as they all share a few common radio frequencies. There will be at least two antennas on this tower.

I believe the zoning already allows this type of structure.

Mike Kelley, F.F./Paramedic

MK/hc

#37 87

Original
Do NOT Remove
from Office

GEM Builders Inc.
P.O. Box 2185
Grand Jct., CO 81502
2943-072-00-037

Valley Federal Savings & Loan
P.O. Box 400
Grand Jct., CO 81502
2943-072-17-022/035/036/037

Donna Sites
C/O Donna Autrey
7660 Auburn Blvd. #E
Citrus Heights, CA 95610
2943-072-17-029

Kenneth Matchett
2844 F Rd.
Grand Jct., CO 81506
2943-064-00-043
2943-063-00-037/041

Lawrence Dowd
2660 Paradise Way
Grand Jct., CO 81506
2943-072-00-035

Richard Carter
6761 Presidio
Huntington Beach, CA 92648
2943-072-17-031

Marvin Tillman
3864 G Rd.
Palisade, CO 81526
2943-072-00-027

~~City of Grand Junction, Admin.
250 North 5th St.
Grand Junction, CO 81501~~

Chief Richard R. Greene
330 South 6th St.
Grand Junction, CO 81501

Greg Trainor, Utility Manager
Public Works Dept.
250 North 5th St.
Grand Junction, CO 81501

Arthur Greenhill
2835 Grand Falls Cr #9
Grand Jct., CO 81501
2943-072-17-032

Marlene Peltier
2835 Grand Falls Dr. #7
Grand Jct., CO 81501
2943-072-17-030

Bethesda Foundation
2825 Patterson Rd.
Grand Jct., CO 81501
2943-072-01-021
2943-072-12-006/974

#37 87

Original
Do NOT Remove
From Office

PATTERSON RD.

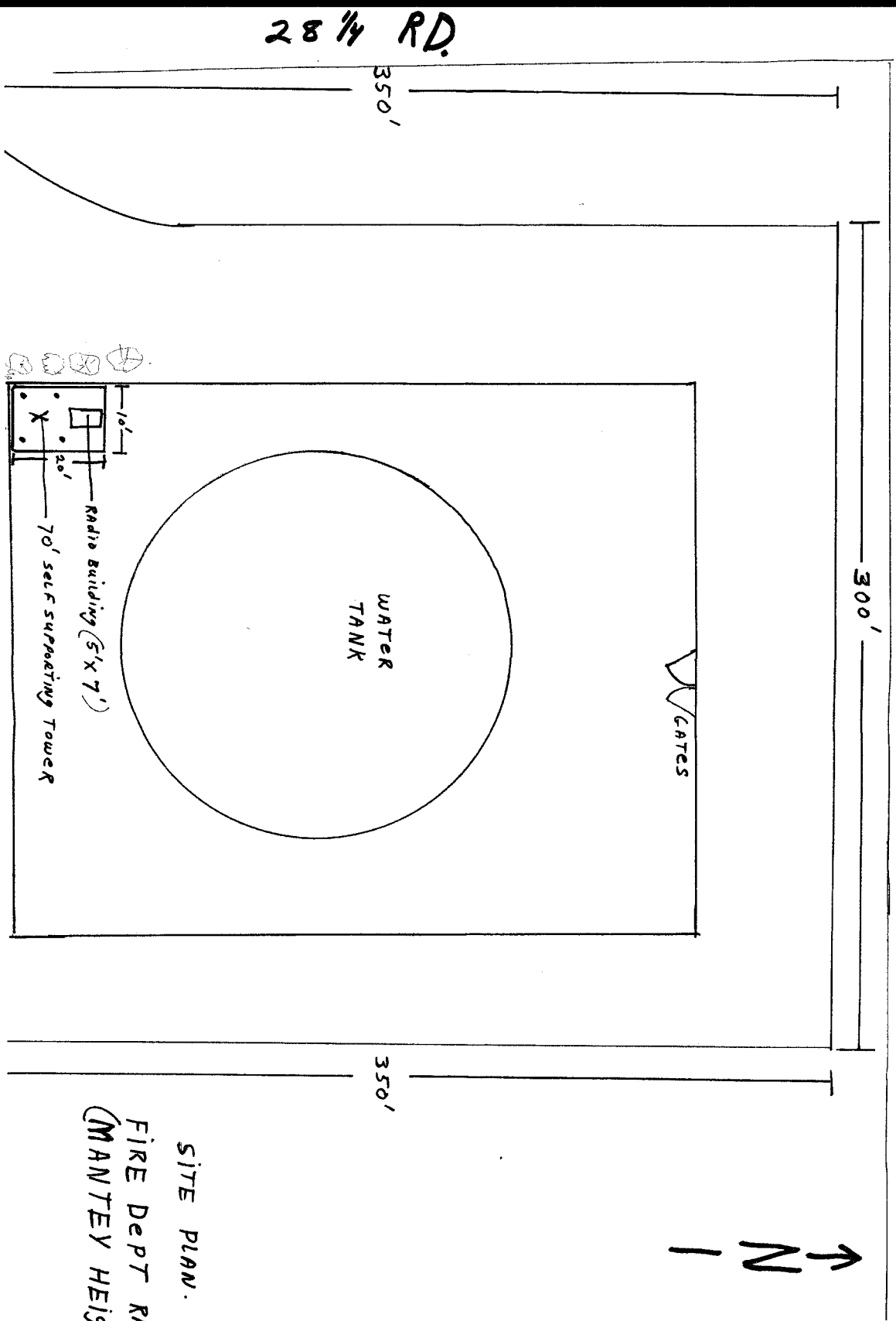

SITE PLAN.
FIRE DEPT Radio Tower
(MANTLEY HEIGHTS.)

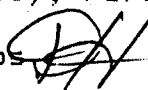
TO: Mike Kelly, Fire Department
FROM: Don Hobbs 
DATE: March 22, 1988

RE: Landscaping Mantey Heights Tank Area

Regarding your inquiry about landscape materials that might be used at the base of your new radio tower at the Mantey Heights water tank; in light of the fact that no water is available at the site, and none is planned in the foreseeable future, I can see no possible way that any plant material could be expected to grow, even in the best of soils; let alone in the shale associated with that particular site.

I have spoken to Mike Sutherland in planning, and he agrees that to require something be planted when there is virtually no chance of survival, is not fulfilling the intent of the landscape requirements, nor is it a wise use of budgeted funds.

Based upon my recommendation, Mike feels that the landscape requirement could be waived in this particular instance. He and I both feel however, that if water does become available at some point in the future, you should complete the landscaping as required.

Should you have questions concerning this recommendation, please contact either myself or Mike.

cc: Mike Sutherland
Ted L Novack

file:fireland

REVIEW SHEET SUMMARY

FILE NO. 37-87 TITLE HEADING Radio Tower Special Use DUE DATE 1-11-88

ACTIVITY - PETITIONER - LOCATION - PHASE - ACRES Special Use Permit for Radio Tower
located at 2827 Patterson Road, near the water tank. City Fire Department

PETITIONER ADDRESS 330 South 6th St

ENGINEER Representative - Mike Kelley

<u>DATE REC.</u>	<u>AGENCY</u>	<u>COMMENTS</u>
12-28-87	Building Dept.	Permits and fees required for installation of any building of electrical, plumbing, mechanical in conjunction with tower placement.
12-30-87	City Engineer	No objection. Note: The water tank may be raised in height in the future. The tower should be designed with this in mind so there would be no conflicts.
1-04-88	Public Works	No objections.
1-14-88	Planning Dept.	There appears to be no technical problems with this proposal however construction of the tower must consider the lighting/obstruction marking which will be required by the Federal Aviation Administration. Landscaping/screening should be installed to buffer the visual effects or the residential zoning to the south and the street to the west. Contact the Parks Department for recommendations on the most appropriate vegetation and method of irrigation. Any additional (flood) lighting should be directional in nature.

