

LANDSCAPE PLAN

Due to the need for paved taxiways and a debris free area because of the total safety element that is involved-landscaping will be a consideration with the Airport Authority.

REPORT CHECKLIST AND OUTLINE

GENERAL PROJECT REPORT

CHECKLIST

OK NA

Typed text

Size: 8½ x 11" format

Bound: If more than 1 page, use a staple.

Name of report on a title page or on the first page of text

OUTLINE

A. Project Description

- ① Location 2848 Heritage Way-Walker Field
- ② Acreage
- ③ Proposed use A basic building with 9 T shaped modules for A/C storage

B. Public Benefit

C. Project Compliance, Compatibility, and Impact

- 1. Adopted plans and/or policies (for rezones, variances, conditional and special use, revocable permits, and vacations, discuss the circumstances that justify the request, as required by the Zoning and Development Code)
- 2. Land use in the surrounding area
- 3. Site access and traffic patterns
- 4. Availability of utilities, including proximity of fire hydrants
- 5. Special or unusual demands on utilities (high water or sewage quantities, grease, or sediment contribution, pre-treatment needs, etc.)
- 6. Effects on public facilities (fire, police, sanitation, roads, parks, schools, irrigation, etc.)
- 7. Site soils and geology (such as per SCS soils mapping)
- 8. Impact of project on site geology and geological hazards, if any
- 9. Hours of operation
- 10. Signage plans

D. Development Schedule and Phasing

COMMENTS

- 1. This report should only provide general information, and should not be more than 2 pages long.



*"We've got the world
at our wingtips"*

WALKER FIELD Airport Authority

2828 Walker Field Drive, Suite 211
Grand Junction, Colorado 81506
(970) 244-9100
FAX (970) 241-9103

February 12, 1996

Ms. Kristen Ashbeck
Grand Junction City Development
City Hall
250 North 5th St.
Grand Junction, CO 81501

Dear Ms. Ashbeck:

In regards to the permitting process by Mr. James E. Fuoco for construction of an addition to his present hangar, the lease agreement between Walker Field Airport Authority and Mr. Fuoco is in the process of preparation.

The Airport Authority will be finalizing the lease agreement at its scheduled board meeting February 20, 1996. As soon as all parties have signed the lease agreement, copies will be provided for your records and all agencies.

Very Truly Yours,

Marcel J. Theberge, A.A.E.
Airport Director

BOARD OF COMMISSIONERS
John R. Crouch, Acting Chairman
C. Joseph Croker
Judith Humphries
Lawrence J. Jokerst
Gary R. Morris
Martin L. O'Boyle
Reford C. Theobold

AIRPORT DIRECTOR
Marcel J. Theberge, A.A.E.

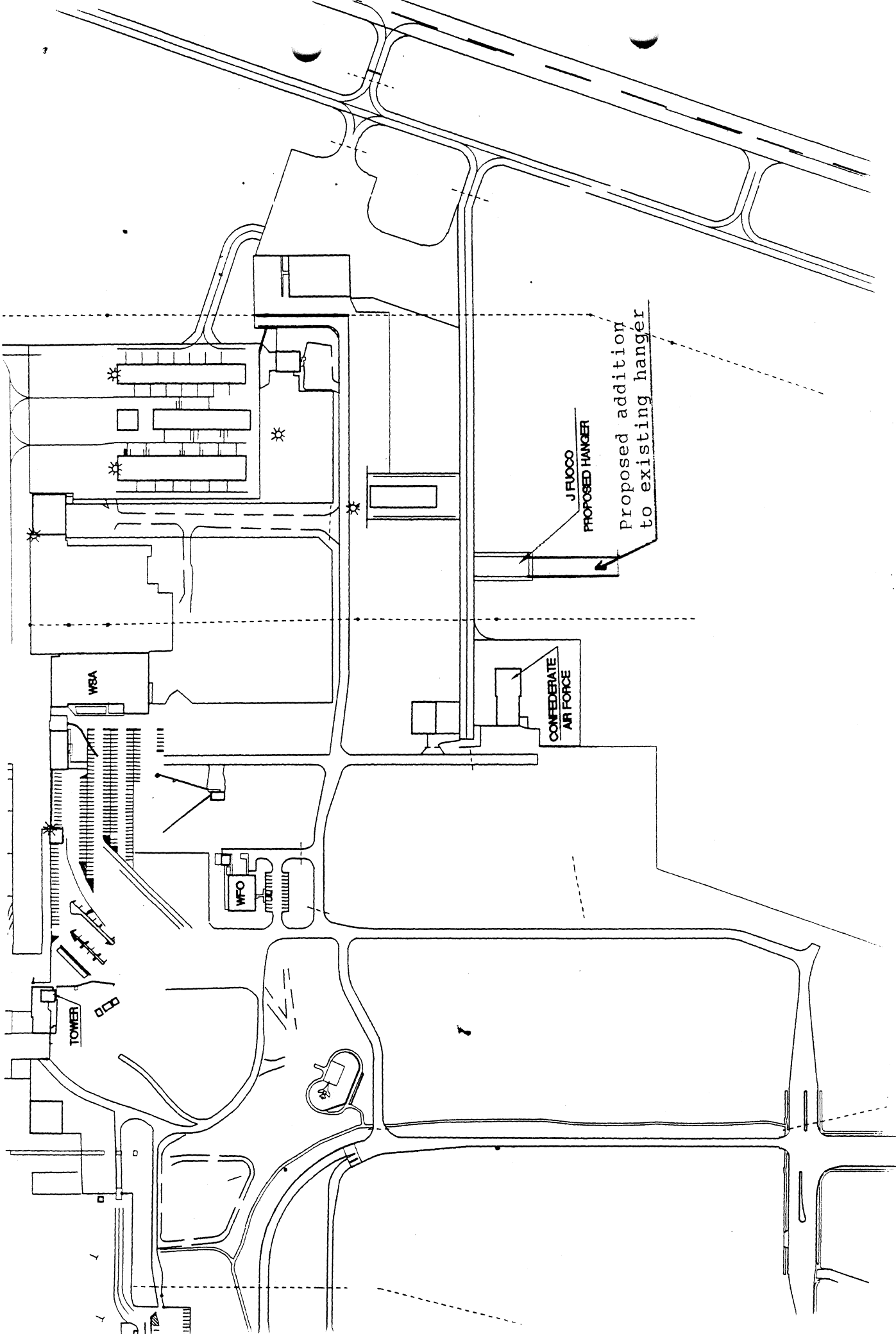

CONFEDERATE
AIR FORCE

J FLOCO
PROPOSED HANGER

Proposed addition
to existing hanger

WBA

WFO

TOWER

LEGEND

- EXISTING SPOT ELEVATION
- PROPOSED SPOT ELEVATION
- EXISTING PAVEMENT
- EXISTING CONTOUR
- PROPOSED CONTOUR
- EXISTING STORM SEWER
- PROPOSED APRON/HANGAR
- FLOW LINE
- EXISTING C.A.F. LEASE LINE



BENCHMARK
 CONCRETE @ S.E. CORNER OF
 EXISTING INLET.
 ELEV. = 4814.54

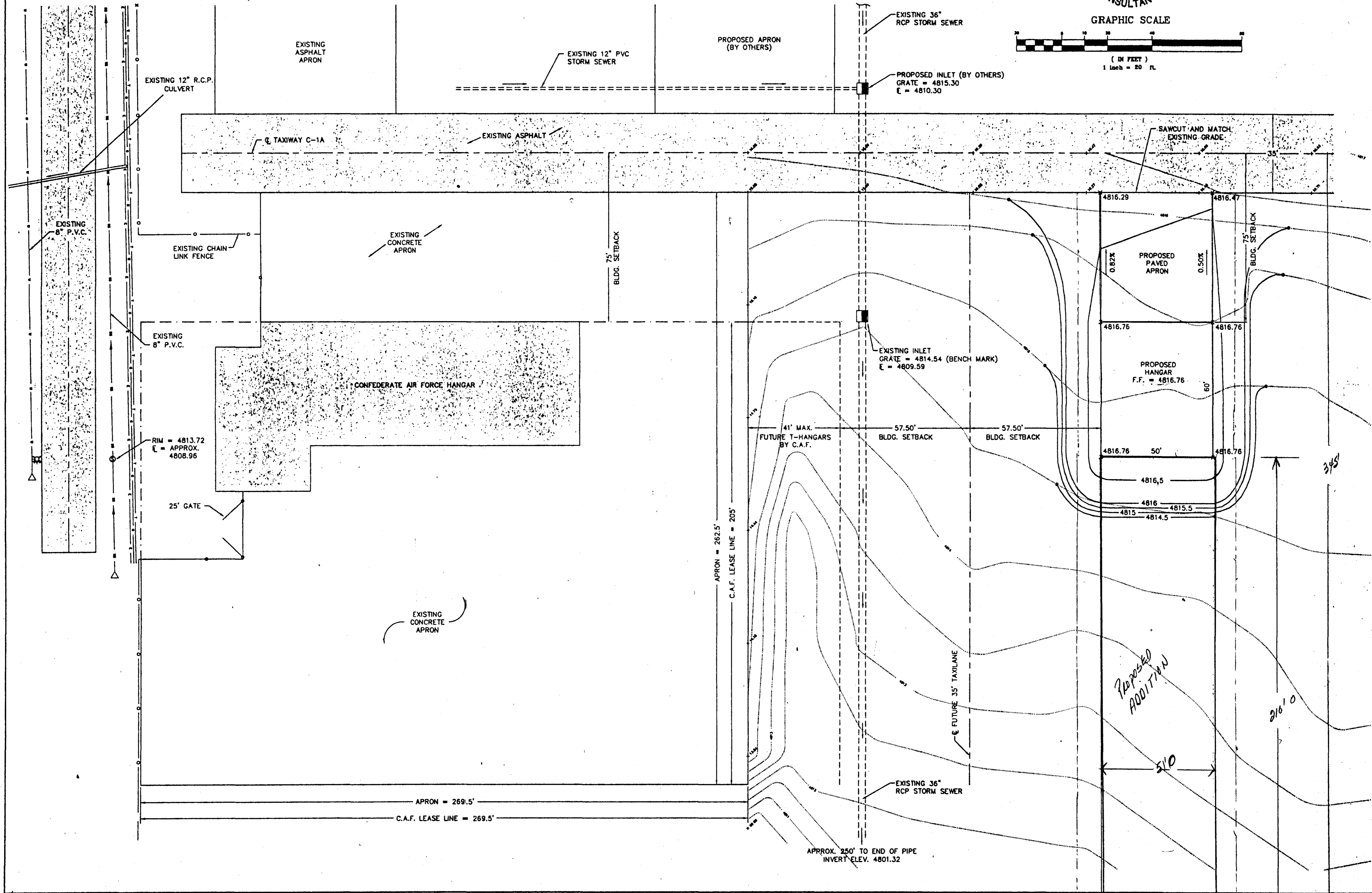
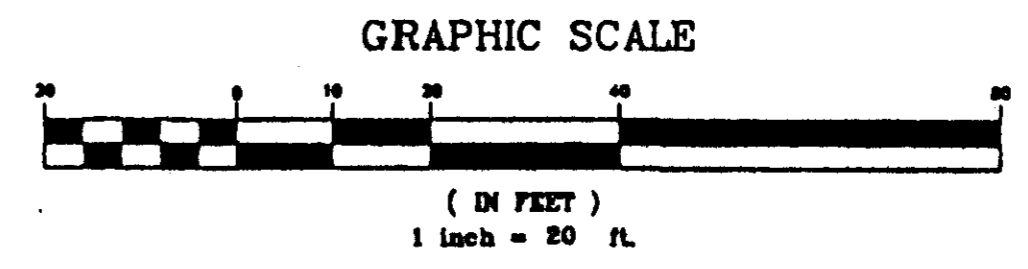

ARMSTRONG CONSULTANTS, INC.
 861 ROOD AVENUE
 GRAND JUNCTION, COLORADO 81501
 (303) 242-0101

ENGINEERS
 PLANNERS
 SURVEYORS
 MATERIAL TESTING
 SOIL TESTING
 GEOTECHNICAL ENGINEERS

WALKER FIELD AIRPORT
JAFCO LLC APRON

Revisions:

Project No: 905478
 Date: 7-28-95
 File Name: SITE

Drawn: J.L.W.
 Checked: R.P.R.
 Approved: K.E.K.

SITE PLAN
JUL 31 1995

Sheet: 1 of 1