

SCALE  
 Horiz. = 1" = 20'-0"  
 Vert. = 1" = 5'-0"

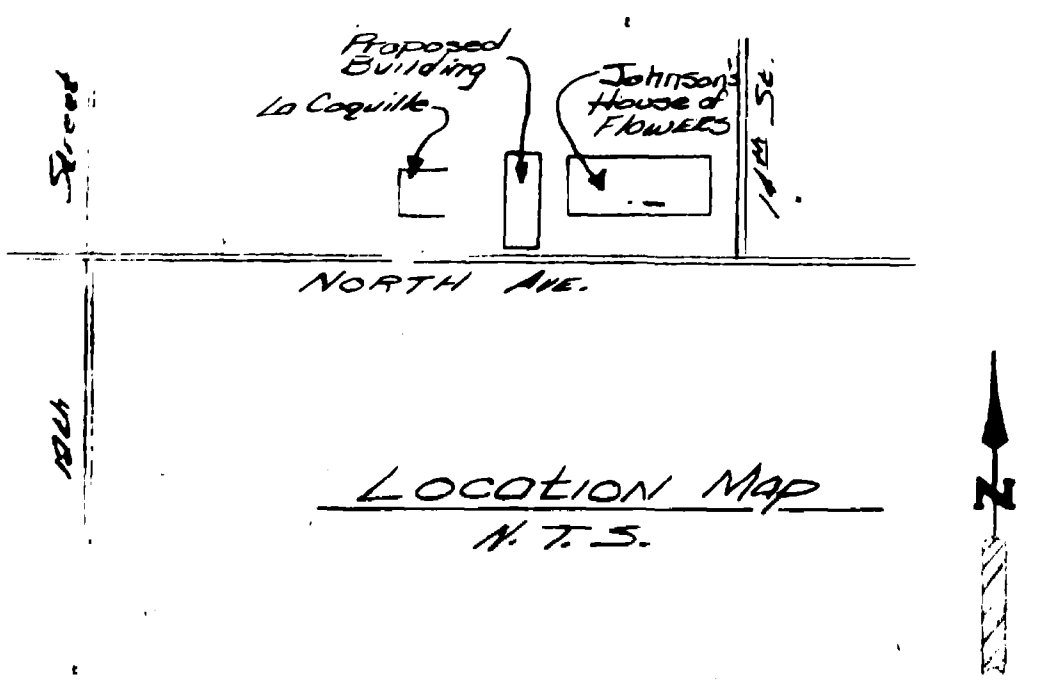

Approved City Engineer \_\_\_\_\_ Date \_\_\_\_\_

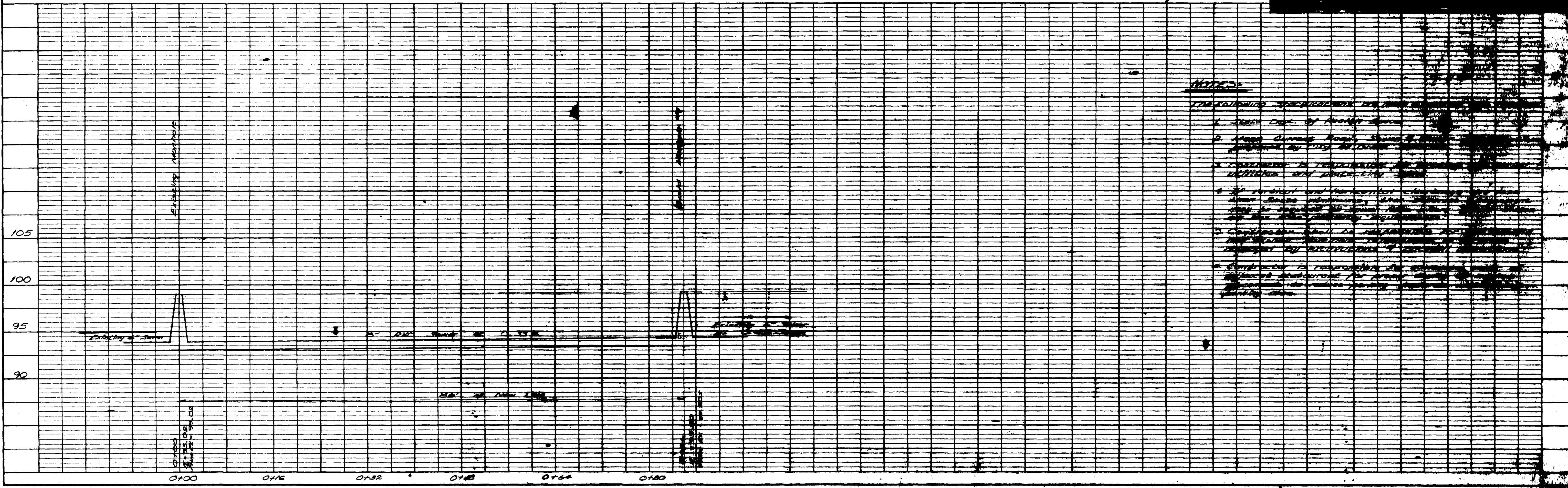

**NOTES**

THE FOLLOWING SPECIFICATIONS ARE TO BE USED IN CONNECTION WITH THE SEWER LINE:

1. SEWER PIPE SHALL BE 9" DIA. OF APPROX. GRADE.
2. ALL OPEN DRAINAGE SHALL BE 18" DIA. OF APPROX. GRADE.
3. ALL MANHOLES SHALL BE 18" DIA. OF APPROX. GRADE.
4. ALL MANHOLES SHALL BE CONCRETE AND SHALL BE SET AT LEAST 18" BELOW FINISHED GRADE.
5. ALL MANHOLES SHALL BE SET AT LEAST 18" BELOW FINISHED GRADE.
6. ALL MANHOLES SHALL BE SET AT LEAST 18" BELOW FINISHED GRADE.