

AS BUILT
Phase I 13-76

FOR MORE INFO ON
TAPS- CONTACT NORM JONES
IN HEATHERIDGE SUB.



Approved: Richard L. Atkinson
City Engineer

DATE	March 1975
SCALE	1" = 100'
BY	
DATE	
APPROVED	
REVISIONS	

DRAFTSMAN	J66	DEPT. HEAD	
PROJECT ENGR	RAL	CONST. REP.	MHPQ
PROJECT MGR	JTP		



NELSON - HALEY - PATTERSON AND QUIRK
ENGINEERING CONSULTANTS

HEATHERIDGE ESTATES
MESA COUNTY, COLORADO

SANITARY SEWER IMPROVEMENTS

SHEET	5
SHEETS	2

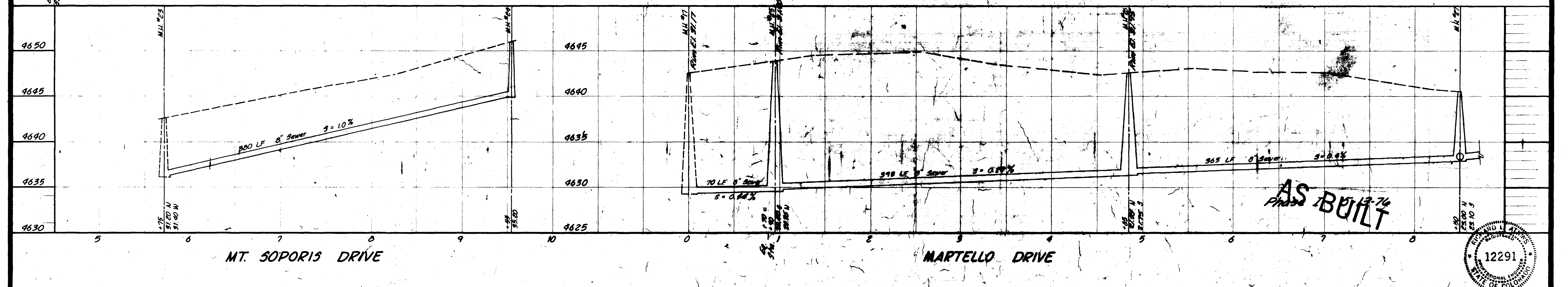
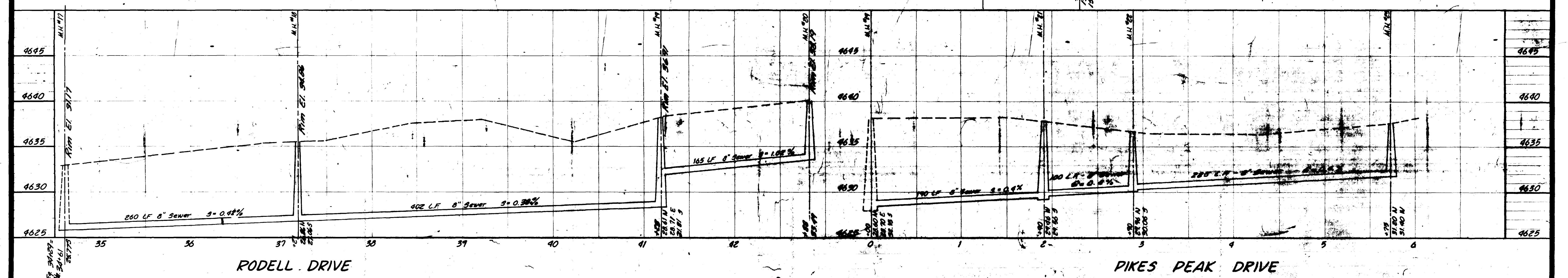
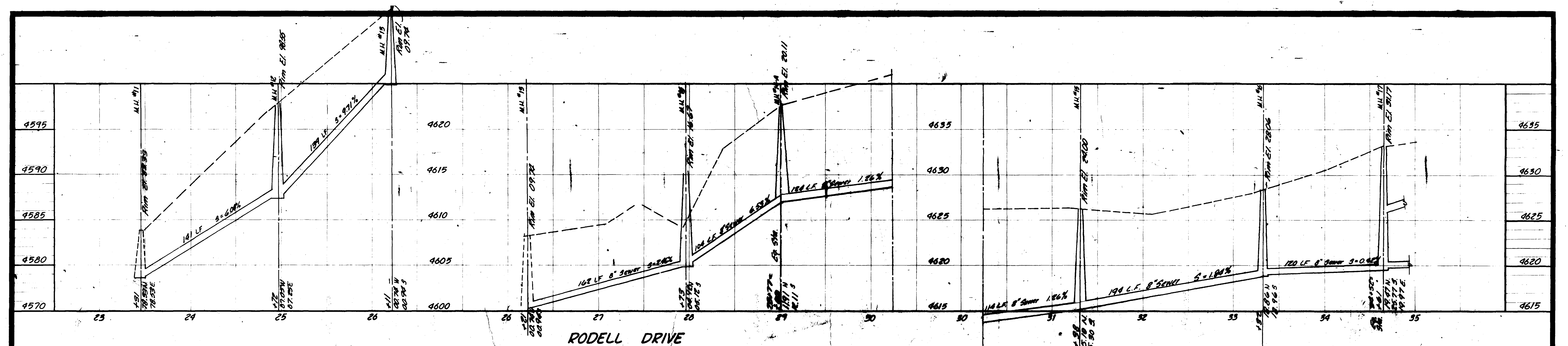

AS BUILT
Phase 2

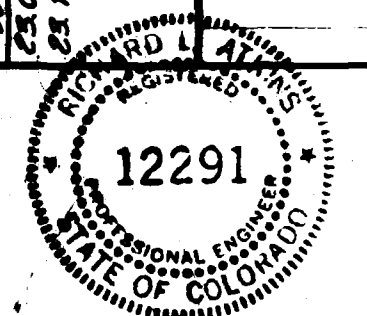

NO.	BY	DATE	APPROVED	REVISIONS	DATE	DRAFTSMAN	DEPT. HEAD	PROJECT ENGR.	CONST. INCH.	PROJECT MGR.	NELSON - HALLEY - PATTERSON AND QUIRK ENGINEERING CONSULTANTS	HEATHERIDGE ESTATES MESA COUNTY, COLORADO	SANITARY SEWER IMPROVEMENTS	SHEET 5
					March 1975	JGC		RLA	NHPQ	JTP				3