

OUTFALL LINE PER SANITARY SEWER PLAN FOR SUNRIDGE SUBDIVISION BY PARAGON ENG.

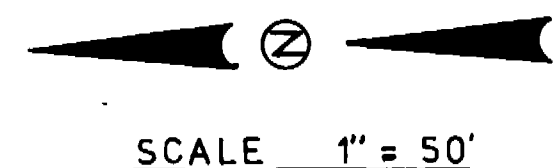

REV. 1 8-22-79 REVISED PER COMMENTS OF C.E.V.S. DIST. 8-10-79

SANITARY SEWER SYSTEM
SUNRIDGE 1st ADDITION

FOR WARREN HOMES
 GRAND JUNCTION, COLO.

SCALE
 HORIZONTAL 1" = 50'
 VERTICAL 1" = 5'

DATE 7-29-79

FILE NO. 79-05-09

APPROVED BY: [Signature]
 SURVEYORS & ENGINEERS

DRAWN BY: [Signature]
 SURVEYORS & ENGINEERS



7-29-80 RSC

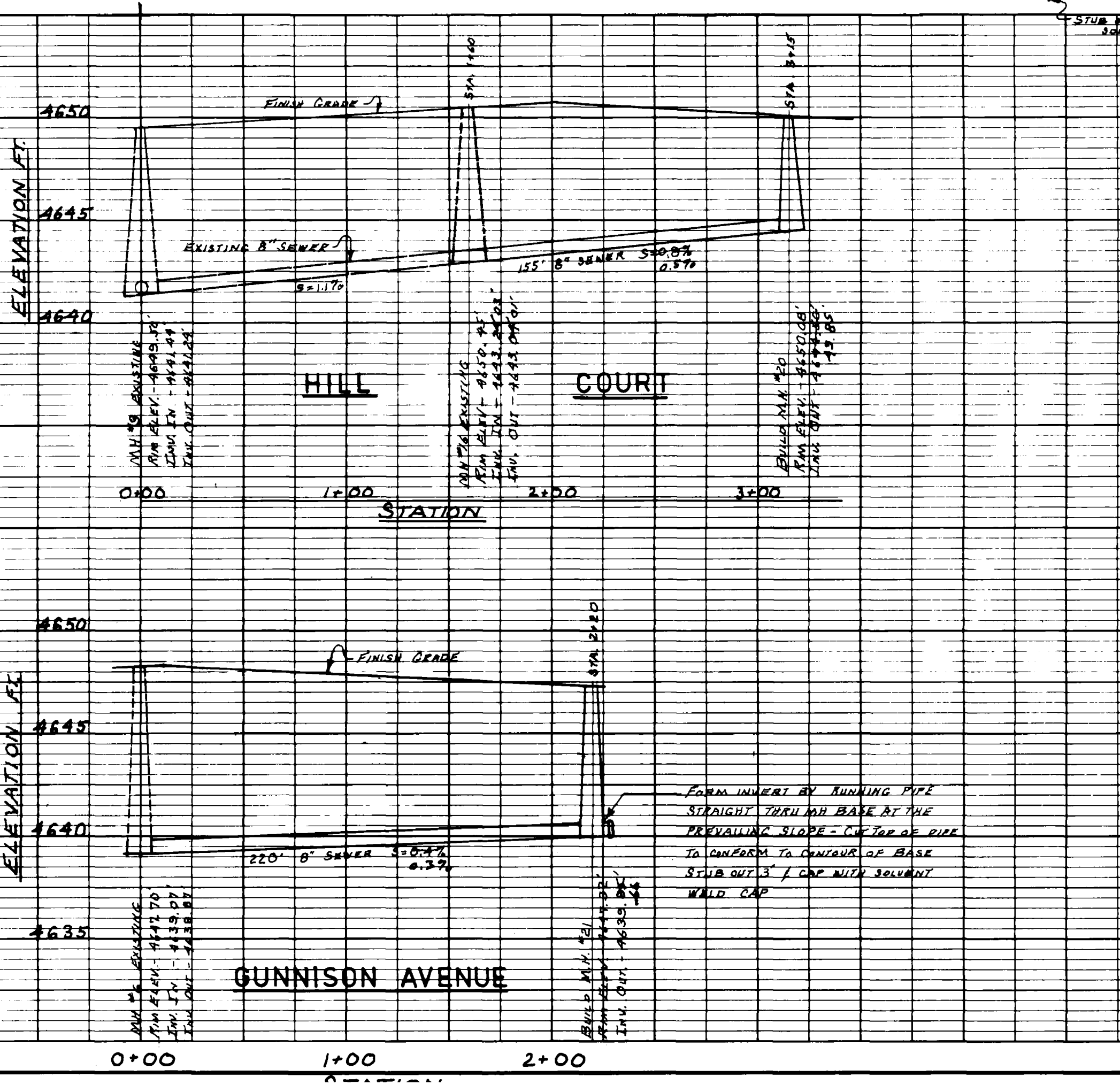
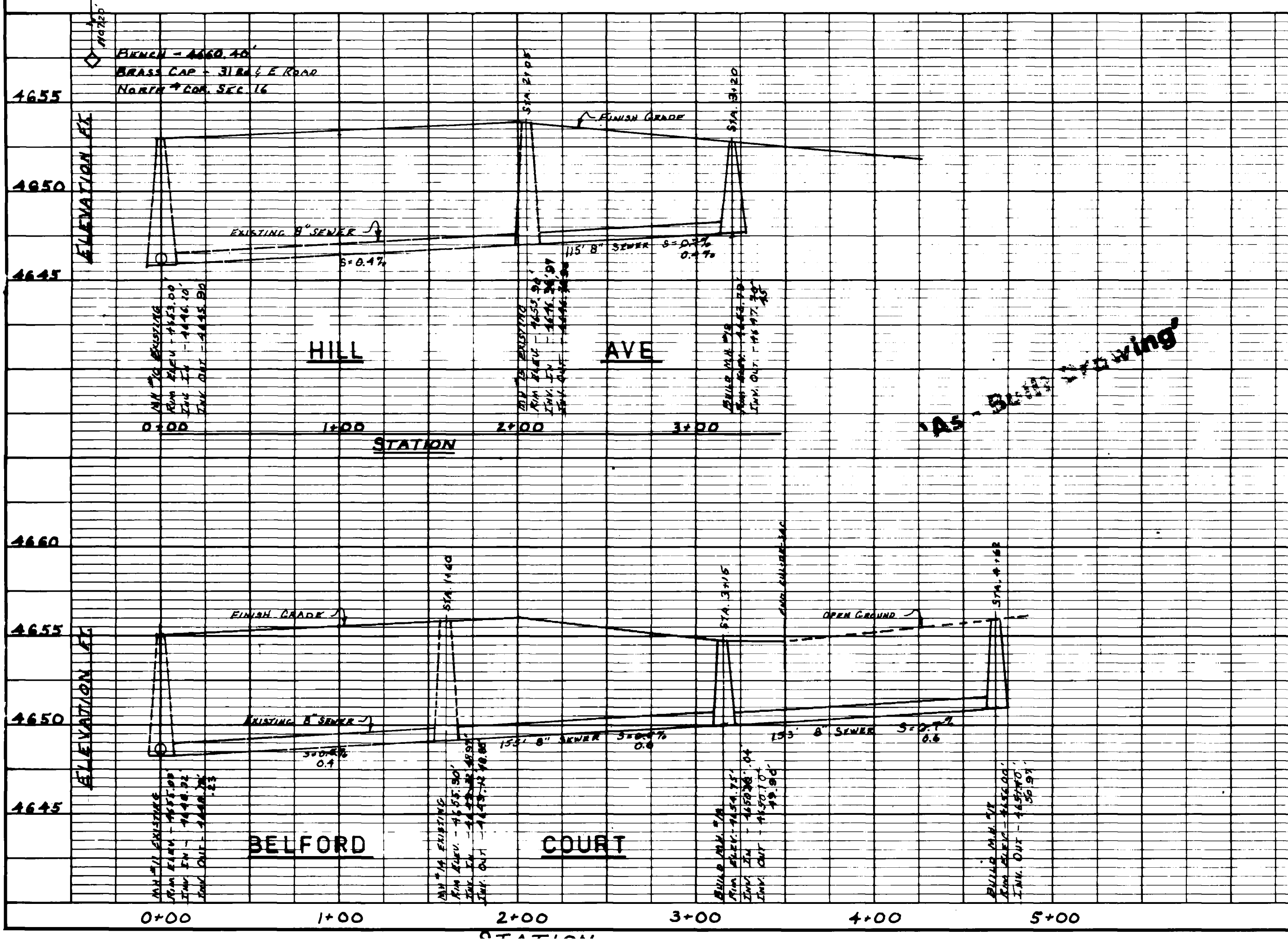

I CERTIFY THAT INSTALLATION (ELEVATION) DOES NOT EXCEED LOG GRADE R.S.P. Plan

NOTES:

- THIS PLAN SUPPLEMENTS & AMENDS THE SANITARY SEWER FOR SUNRIDGE SUBDIVISION
- ALL CONSTRUCTION AND INSTALLATION SHALL BE ACCOMPLISHED IN ACCORDANCE WITH THE FOLLOWING:
 - COLORADO DEPT. OF HEALTH SPECIFICATIONS
 - CENTRAL GRAND VALLEY SANITATION DISTRICT SPECIFICATIONS
- ALL SEWER SERVICES ARE TO EXTEND 10' BEYOND PROPERTY LINE
- TOP OF ECCENTRIC CONE FOR MANHOLES 18" BY 18" SET AT TOP OF SUBGRADE (STREET CONSTRUCTION WILL SET RIMS TO FINISH GRADE)
- SEWER LINES SHALL BE LOCATED A MINIMUM OF 10' HORIZONTALLY & 18" VERTICALLY FROM ALL WATER LINES. AT CROSSINGS WITH LESS THAN 18" VERTICAL SPACING A SINGLE LENGTH OF PIPE SHALL BE CENTERED AT THE CROSSING. THE CROSSING SHALL BE ENCASED IN A CONC. COLLAR 6" THICK AND EXTENDING 12" BEYOND THE DIAMETER OF THE WATER PIPE ON BOTH SIDES.
- MATERIALS
 - 786' 8" SEWER PIPE
 - 382' 4" LATERAL SEWER PIPE
 - 18' SERVICE CONNECTIONS
 - 5' MANHOLES 18" DIA

JAMES E. PATTERSON
 CITY OF GRAND JUNCTION - TREATMENT

CENTRAL GRAND VALLEY SANITATION DIST. COLLECTION

WARREN HOMES CO. - OWNER

DATE 7-31-79

DATE 7-30-79