

General Notes  
 1. This Subdivision Is Served By Central Grand Valley Sanitation District  
 2. This Is To Certify That The System Infiltration Does Not Exceed 200 Gallons Per Inch Diameter Per Mile Of Length Per Day. Field Verified 7/21/82

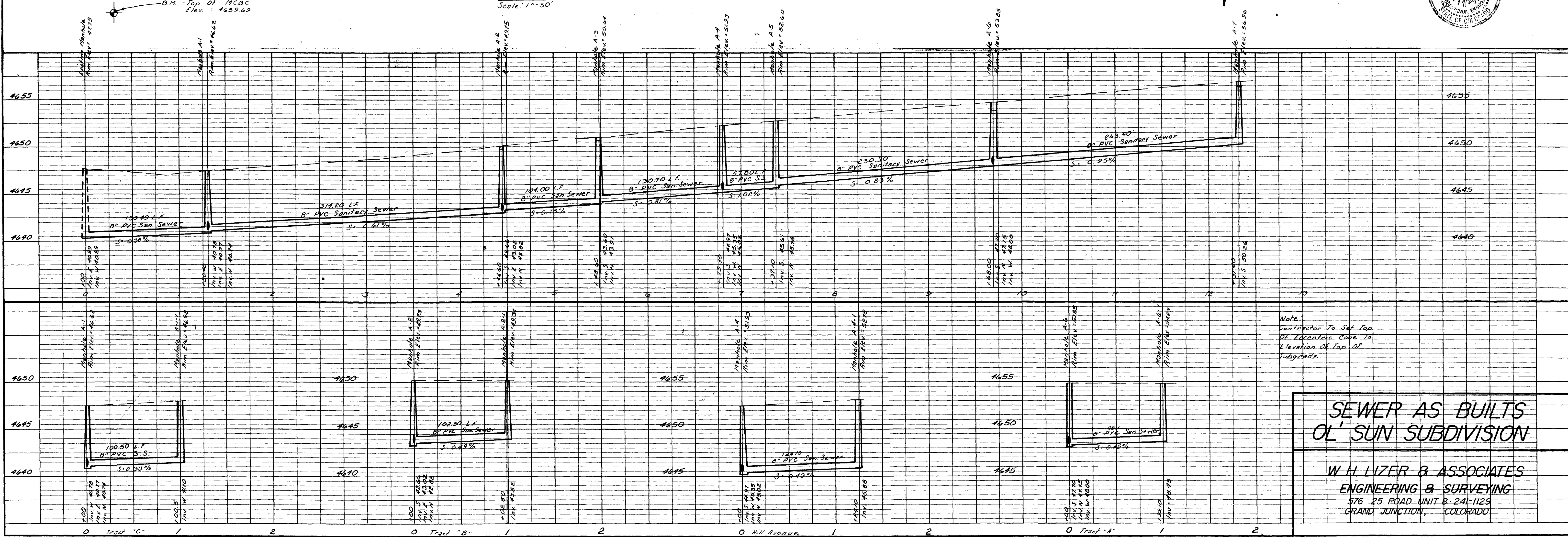
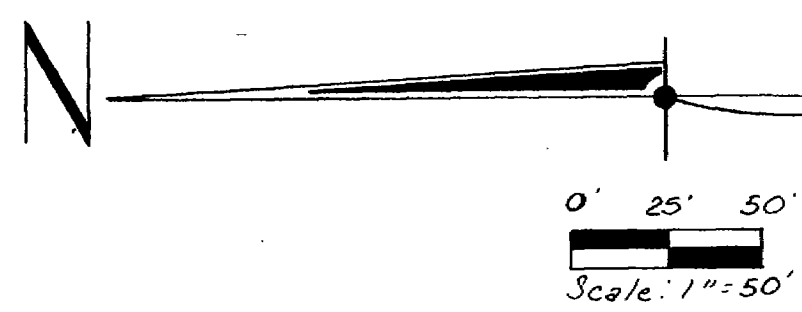

**SEWER AS BUILTS  
 OF SUN SUBDIVISION**  
 W. H. LIZER & ASSOCIATES  
 ENGINEERING & SURVEYING  
 576 25 ROAD UNIT 8-241-1129  
 GRAND JUNCTION, COLORADO