

COMBINED SEWER DISTRICT No. 1.

SHOWING

Area Improved, Boundary of District and Property Assessed
and total Assessment on each lot or tract in the District
GRAND JUNCTION COLO.

Rate Per Sq. foot .0038¢

Dec. 1923

Scale: 1 inch = 100 feet

S. E. Thompson
City Engineer.



Bids Received on Combined Sewer District No. 1. Grand Junction Colorado. July 5th 1923.

Contractor. Contractor. Contractor. Contractor.

	Item	Orman Construction Company.		Winterburn and Lumsden.		Strang-Masquire.		
		Unit.	Total.	Unit.	Total.	Unit.	Total.	
Vitrified Clay Pipe.	1	1850 lin. ft. - 15" Diam. Pipe.	1.70	3094.00	1.73	3148.60	1.72	3130.40
	2	480 lin. ft. - 12" Diam. Pipe.	1.35	648.00	1.53	734.40	1.38	662.40
	3	600 lin. ft. - 8" Diam. Pipe.	0.90	540.00	1.25	750.00	0.91	546.00
	4	6 Concrete Manholes.	70.00	420.00	90.00	540.00	72.00	432.00
	5	18 Catch Basins.	60.00	1080.00	55.00	990.00	60.00	1080.00
	6	20 - 15" x 6" Y ² .	6.50	130.00	5.92	118.40	6.75	135.00
	7	6 - 12" x 6" Y ² .	5.00	30.00	4.10	24.60	5.95	35.70
	Total.		\$5942.00		\$6306.00		\$6021.50	
Concrete Pipe.	1	1850 lin. ft. - 15" Diam. Pipe.			1.74	3166.80	1.72	3130.40
	2	480 lin. ft. - 12" Diam. Pipe.			1.54	739.20	1.38	662.40
	3	600 lin. ft. - 8" Diam. Pipe.			1.26	756.00	0.91	546.00
	4	6 Concrete Manholes.			90.00	540.00	72.00	432.00
	5	18 Catch Basins.			55.00	990.00	60.00	1080.00
	6	20 - 15" x 6" Y ² .			5.92	118.40	6.75	135.00
	7	6 - 12" x 6" Y ² .			4.10	24.60	7.20	43.20
	Total.				\$6335.00		\$6069.00	
	Date of Completion.		10 th August.		10 th August.		10 th August.	

COMBINED STORM & SANITARY SEWER DISTRICT No. 1. GRAND JUNCTION COLO. MAY 16th 1923. SHOWING PROPERTY TO BE ASSESSED.

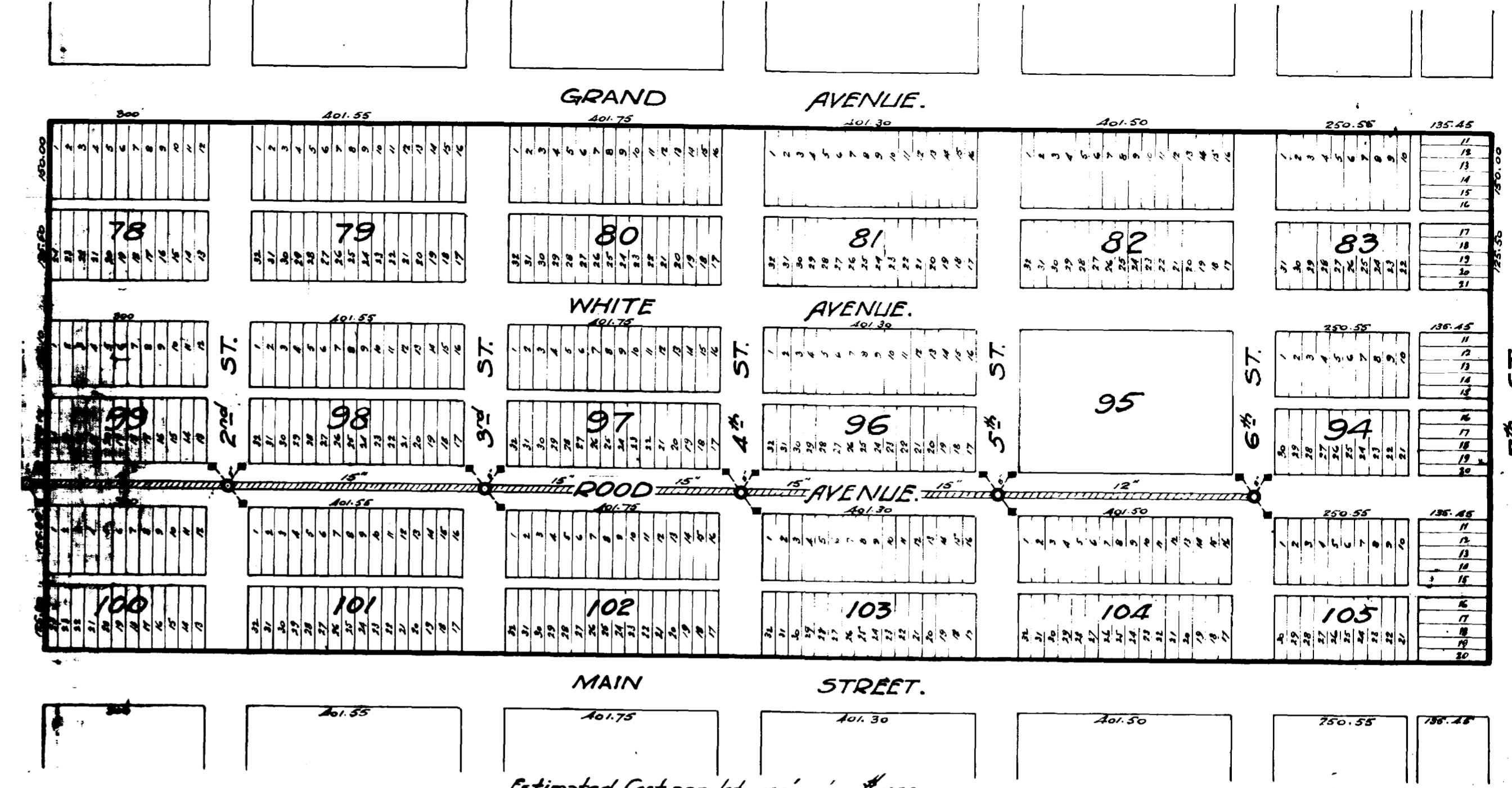

Estimated Cost per lot 125' x 25' = \$1166
 Rate per sq. ft. = .0037
 Estimated Cost = \$6416.47

J. E. Thornborn
 City Engineer

COMBINED STORM & SANITARY SEWER DISTRICT No. 1. GRAND JUNCTION COLO. MAY 16th 1923. SHOWING PROPERTY TO BE ASSESSED.

Designation and Apartmentment
 Rate Per Square Foot

Block	Lot	Area	Rate	Total
Block 1	1	125' x 25'	.0037	466.25
Block 1	2	125' x 25'	.0037	466.25
Block 1	3	125' x 25'	.0037	466.25
Block 1	4	125' x 25'	.0037	466.25
Block 1	5	125' x 25'	.0037	466.25
Block 1	6	125' x 25'	.0037	466.25
Block 1	7	125' x 25'	.0037	466.25
Block 1	8	125' x 25'	.0037	466.25
Block 1	9	125' x 25'	.0037	466.25
Block 1	10	125' x 25'	.0037	466.25
Block 1	11	125' x 25'	.0037	466.25
Block 1	12	125' x 25'	.0037	466.25
Block 1	13	125' x 25'	.0037	466.25
Block 1	14	125' x 25'	.0037	466.25
Block 1	15	125' x 25'	.0037	466.25
Block 1	16	125' x 25'	.0037	466.25
Block 1	17	125' x 25'	.0037	466.25
Block 1	18	125' x 25'	.0037	466.25
Block 1	19	125' x 25'	.0037	466.25
Block 1	20	125' x 25'	.0037	466.25
Block 1	21	125' x 25'	.0037	466.25
Block 1	22	125' x 25'	.0037	466.25
Block 1	23	125' x 25'	.0037	466.25
Block 1	24	125' x 25'	.0037	466.25
Block 1	25	125' x 25'	.0037	466.25
Block 1	26	125' x 25'	.0037	466.25
Block 1	27	125' x 25'	.0037	466.25
Block 1	28	125' x 25'	.0037	466.25
Block 1	29	125' x 25'	.0037	466.25
Block 1	30	125' x 25'	.0037	466.25
Block 1	31	125' x 25'	.0037	466.25
Block 1	32	125' x 25'	.0037	466.25
Block 1	33	125' x 25'	.0037	466.25
Block 1	34	125' x 25'	.0037	466.25
Block 1	35	125' x 25'	.0037	466.25
Block 1	36	125' x 25'	.0037	466.25
Block 1	37	125' x 25'	.0037	466.25
Block 1	38	125' x 25'	.0037	466.25
Block 1	39	125' x 25'	.0037	466.25
Block 1	40	125' x 25'	.0037	466.25
Block 1	41	125' x 25'	.0037	466.25
Block 1	42	125' x 25'	.0037	466.25
Block 1	43	125' x 25'	.0037	466.25
Block 1	44	125' x 25'	.0037	466.25
Block 1	45	125' x 25'	.0037	466.25
Block 1	46	125' x 25'	.0037	466.25
Block 1	47	125' x 25'	.0037	466.25
Block 1	48	125' x 25'	.0037	466.25
Block 1	49	125' x 25'	.0037	466.25
Block 1	50	125' x 25'	.0037	466.25
Block 1	51	125' x 25'	.0037	466.25
Block 1	52	125' x 25'	.0037	466.25
Block 1	53	125' x 25'	.0037	466.25
Block 1	54	125' x 25'	.0037	466.25
Block 1	55	125' x 25'	.0037	466.25
Block 1	56	125' x 25'	.0037	466.25
Block 1	57	125' x 25'	.0037	466.25
Block 1	58	125' x 25'	.0037	466.25
Block 1	59	125' x 25'	.0037	466.25
Block 1	60	125' x 25'	.0037	466.25
Block 1	61	125' x 25'	.0037	466.25
Block 1	62	125' x 25'	.0037	466.25
Block 1	63	125' x 25'	.0037	466.25
Block 1	64	125' x 25'	.0037	466.25
Block 1	65	125' x 25'	.0037	466.25
Block 1	66	125' x 25'	.0037	466.25
Block 1	67	125' x 25'	.0037	466.25
Block 1	68	125' x 25'	.0037	466.25
Block 1	69	125' x 25'	.0037	466.25
Block 1	70	125' x 25'	.0037	466.25
Block 1	71	125' x 25'	.0037	466.25
Block 1	72	125' x 25'	.0037	466.25
Block 1	73	125' x 25'	.0037	466.25
Block 1	74	125' x 25'	.0037	466.25
Block 1	75	125' x 25'	.0037	466.25
Block 1	76	125' x 25'	.0037	466.25
Block 1	77	125' x 25'	.0037	466.25
Block 1	78	125' x 25'	.0037	466.25
Block 1	79	125' x 25'	.0037	466.25
Block 1	80	125' x 25'	.0037	466.25
Block 1	81	125' x 25'	.0037	466.25
Block 1	82	125' x 25'	.0037	466.25
Block 1	83	125' x 25'	.0037	466.25
Block 1	84	125' x 25'	.0037	466.25
Block 1	85	125' x 25'	.0037	466.25
Block 1	86	125' x 25'	.0037	466.25
Block 1	87	125' x 25'	.0037	466.25
Block 1	88	125' x 25'	.0037	466.25
Block 1	89	125' x 25'	.0037	466.25
Block 1	90	125' x 25'	.0037	466.25
Block 1	91	125' x 25'	.0037	466.25
Block 1	92	125' x 25'	.0037	466.25
Block 1	93	125' x 25'	.0037	466.25
Block 1	94	125' x 25'	.0037	466.25
Block 1	95	125' x 25'	.0037	466.25
Block 1	96	125' x 25'	.0037	466.25
Block 1	97	125' x 25'	.0037	466.25
Block 1	98	125' x 25'	.0037	466.25
Block 1	99	125' x 25'	.0037	466.25
Block 1	100	125' x 25'	.0037	466.25
Block 1	101	125' x 25'	.0037	466.25
Block 1	102	125' x 25'	.0037	466.25
Block 1	103	125' x 25'	.0037	466.25
Block 1	104	125' x 25'	.0037	466.25
Block 1	105	125' x 25'	.0037	466.25

Elev 4590

Elev 4580

1st Street

2nd Street

3rd Street

4th Street

5th Street

6th Street

ROAD

AVENUE.

Elev 4600

Elev 4590

0' 4578.6
0'

15" Pipe .66%

15" Pipe .66%

4584.4

15" Pipe .47%

15" Pipe .47%

4589.0

12" Pipe

.81%

4593.0

8K 76 pg. 43

Combined Storm & Sanitary Sewer District No. 1.

Scale: Vertical 1" = 4'
Horizontal 1" = 100'