

SANITARY SEWER

"G" ROAD & 12TH STREET TO HORIZON DR.

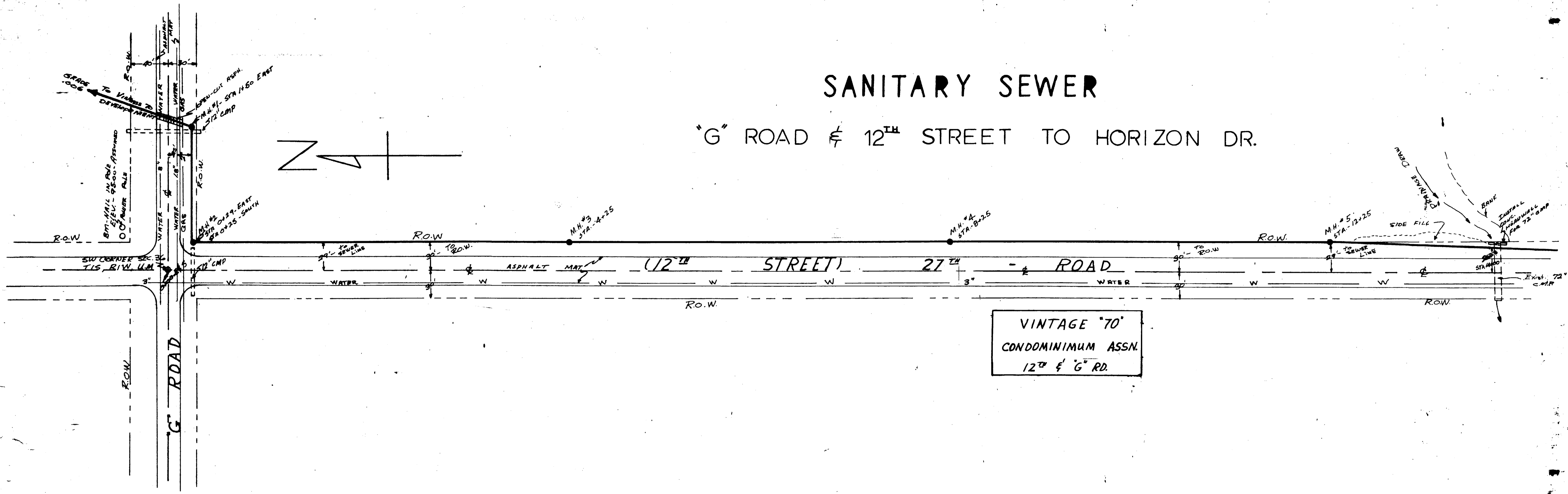
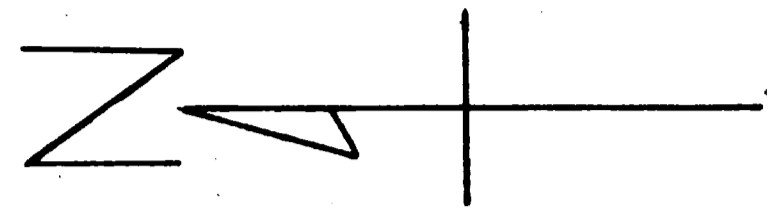

NOTE-- ALL MATERIALS & CONSTRUCTION METHODS TO CONFORM TO THE CITY OF GRAND JUNCTION STANDARD SPECIFICATIONS FOR SANITARY SEWERS AND COUNTY OF MESA'S REGULATIONS

SCALE 1" = 50' HORIZ. - 1" = 5' VERT. SEWER PLAN & PROFILE

SANITARY SEWER

12TH STREET - WEST ON HORIZON¹ DR.

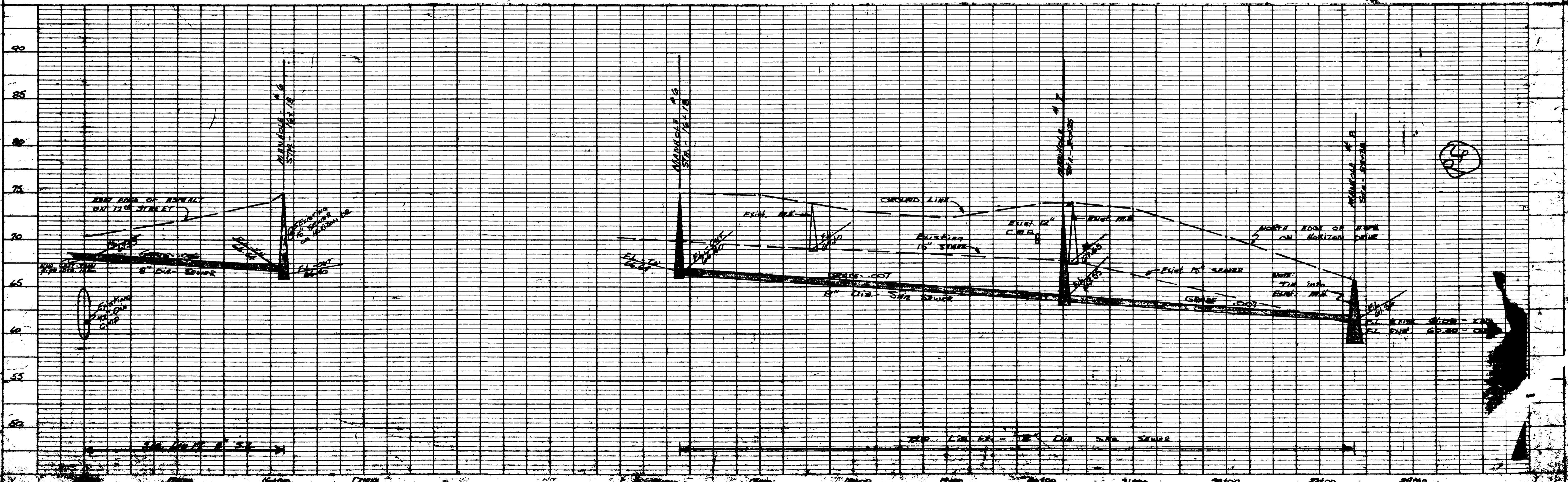
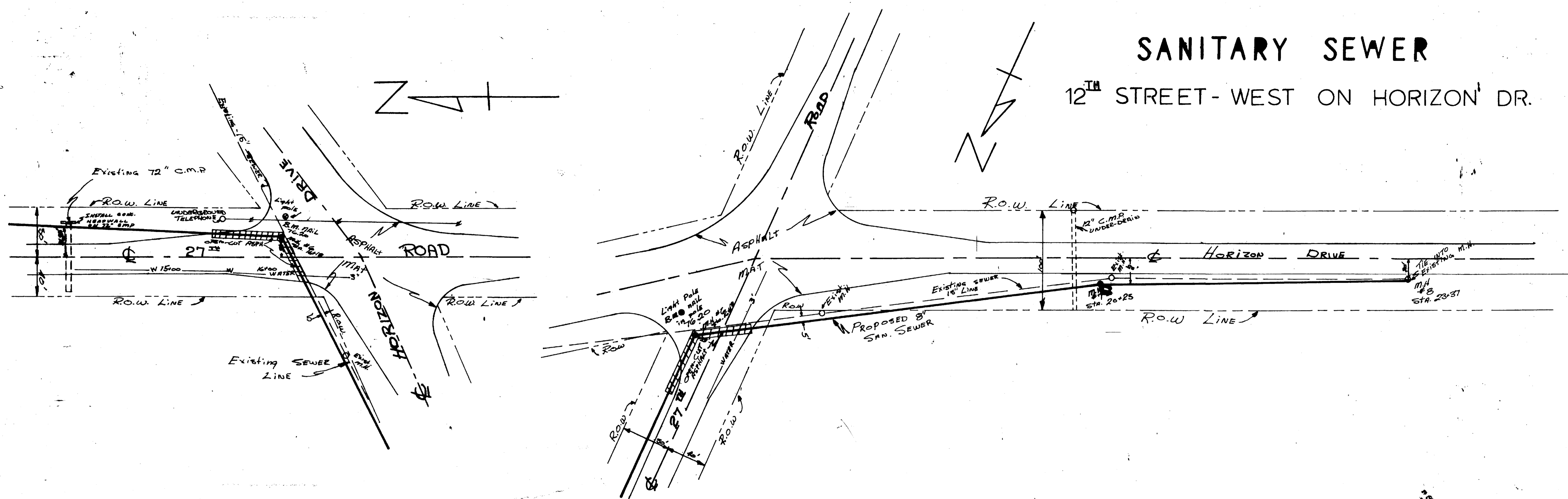

PLANS TO BE PRINTED ON 24" X 36" STANDARD SIZE PAPER

1" = 50' HORIZ - 1" = 5' VERT.

SEWER PLAN & PROFILE - 12TH ST & HORIZON DR.