

B.M. - Exist
Manhole Rim
Elev - 4532.64

Sta 0+00, Exist
Manhole
E = 45.59
Rim = 52.64 (T.B.M.)

Sta 0+32.2, Manhole
E = 45.71
Rim = 52.32

Approximate Summary of Quantities

Item No.	Description	Unit	Quant
1.	8" PVC Sanitary Sewer Line	L.F.	498.5
2.	Standard Manhole (5' to 10')	Ea	1
3.	Standard Shallow Manhole (0' to 5')	Ea	2
4.	Remove & Replace V-Pan	L.F.	5
5.	Remove & Replace 1.5' Curb	L.F.	5
6.	Remove & Replace Pmnt section Match Existing	Sq. Yd.	123.57
7.	Relocate Water Meter (Inspected By Like Water)	Ea.	1
8.	Relocate Wood Post & Sign	Ea.	1
9.	Tapping Existing manhole	Ea.	1

In accordance with Colorado State Senate Bill 172, paragraph 9-1.5.101, the contractor shall provide notification to all utility companies two (2) business days prior to start of excavation for location & coordination of underground utilities. Underground Utilities Location Telephone Number is 245-2555.

- NOTES:
- All construction shall be in accordance with City of Grand Junction Sanitary Sewer details - Drawings SS-1 and shall conform to City of Grand Junction "Standard Specifications for Construction of Water Lines, Sanitary Sewers, Storm Drainage and Irrigation Systems", 1981, and City of Grand Junction, General Contract Conditions for Public Works and Utilities Construction GC-37, GC-50 and GC-65.
 - All road repair shall be in accordance with Mesa County Plans & Specifications for Road & Bridge Design & Construction.

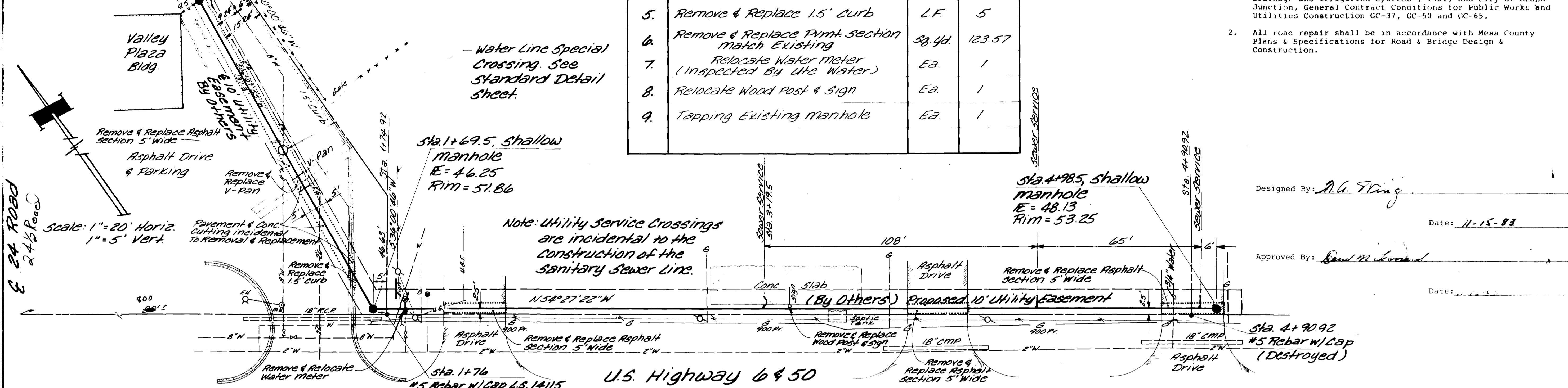

Designed By: A.G. Flang
Date: 11-15-83

Approved By: David M. Leonard
Date: _____

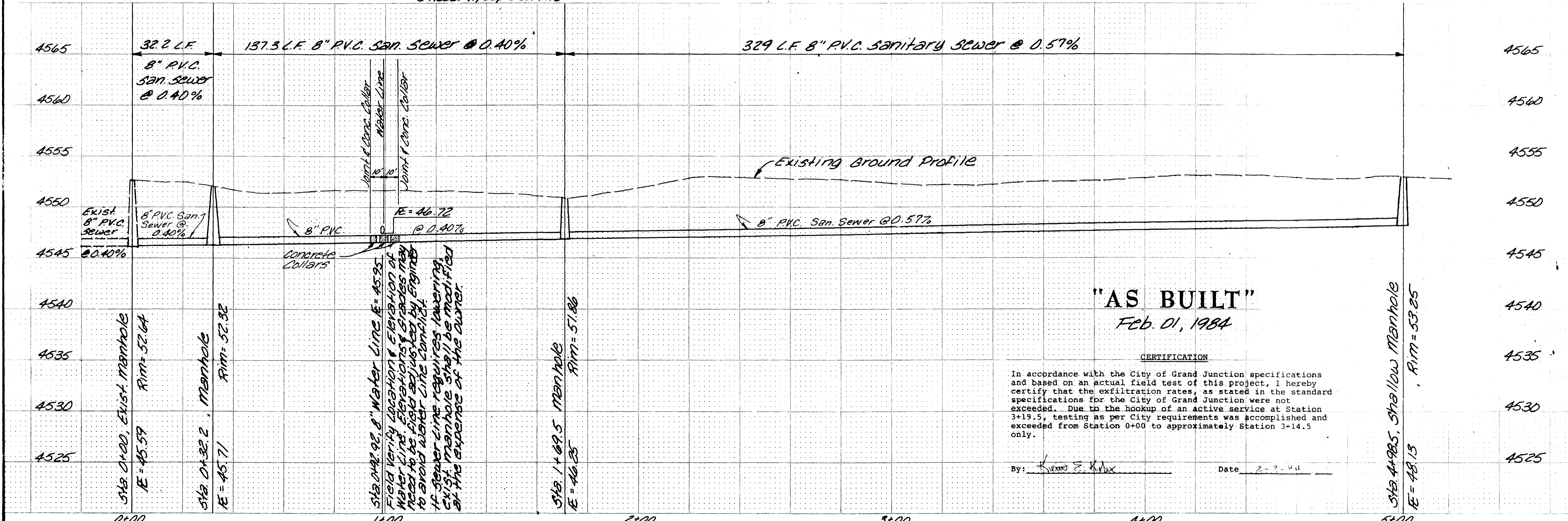

ARMSTRONG & ASSOCIATES, INC.
725 Broadway, Suite 16
Denver, Colorado 80209
(303) 733-4801

861 Road Avenue
Grand Junction Colorado 81501
(303) 245-3861

Architects
Engineers
Planners
Surveyors
Soil Testing
Material Testing
U.S. Mineral Surveyors
Geotechnical Engineers

Big O Tire
Sanitary Sewer Extension
Mesa County, Colorado

Project No: 834263
Date: 11-11-83
Revisions: AS-BUILT
02-01-84

Drawn: ADC
Checked:
Approved:

Sanitary Sewer Plan & Profile

Sheet 1 of 1