

8+55.5, 415' Lt.
 Connect to existing M.H.
 Inv. of 12" = 4676.00
 Inv. in. from east = 4675.5

9+75, 11' Lt.
 6" 3rd. M.H.
 Inv. out = 4675.96 - 5'
 5' Inv. in = 4679.16 - 5'
 E-Inv. in = 4679.16 - 5'

12+75, 11' Lt.
 6" 3rd. M.H.
 Inv. @ center of manhole = 4680.00
 Inv. in = 4685.10 - 5'
 Inv. in = 4680.00 - 5'

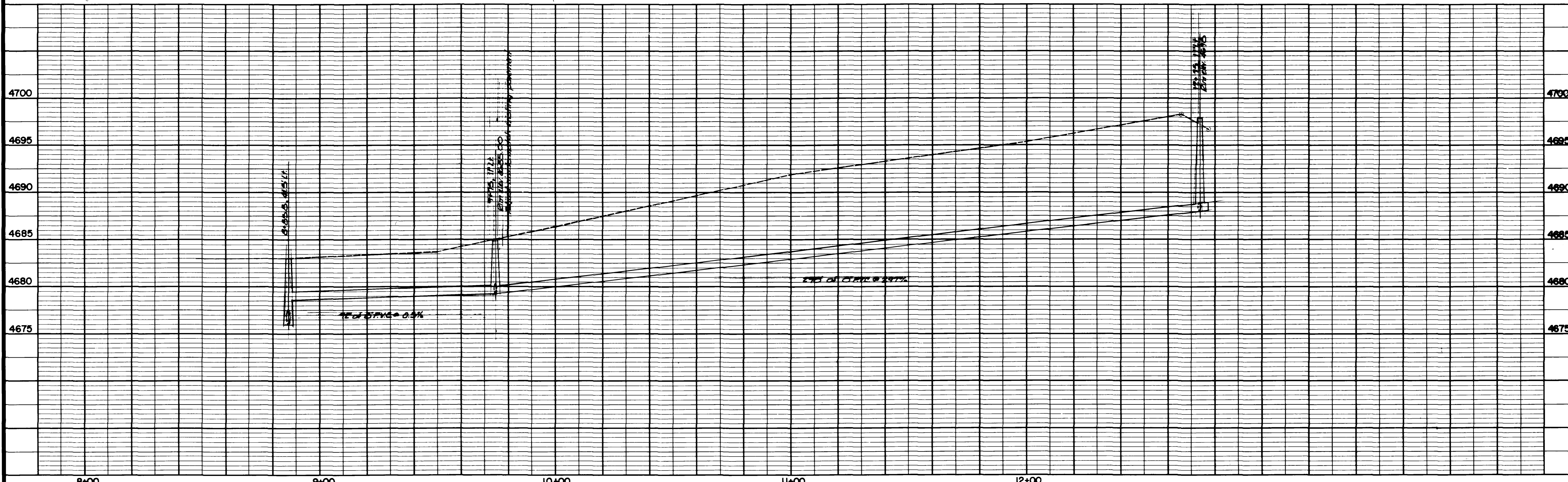
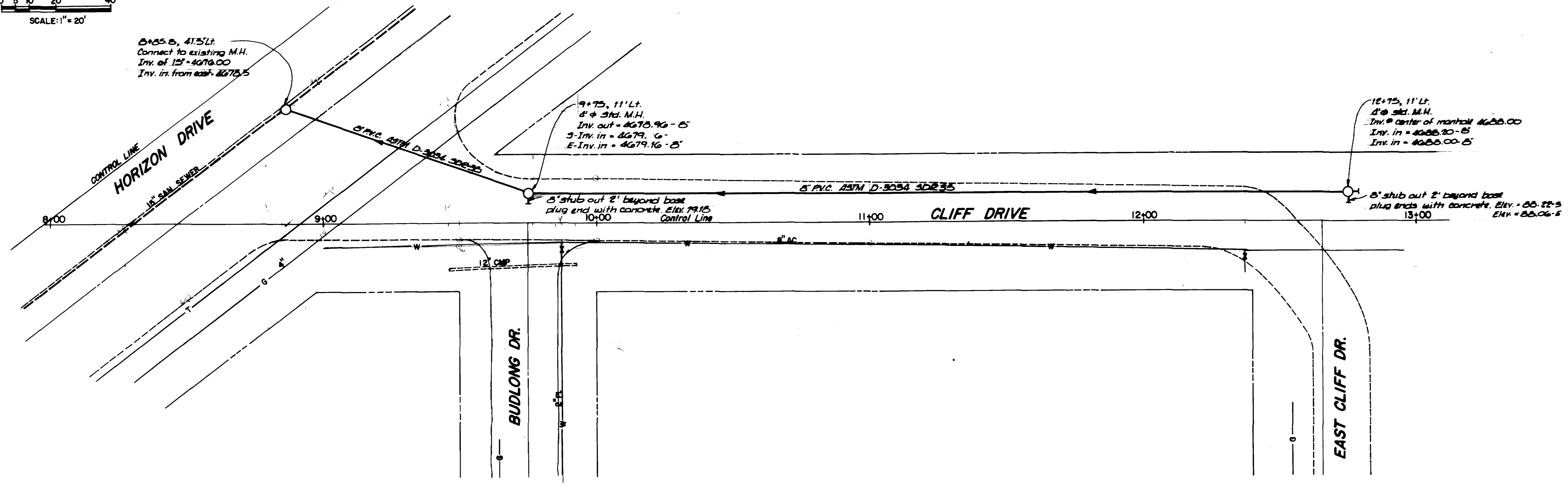

REVISION Δ	DESCRIPTION	DATE	DRAWN BY <u>Lesly</u>	DATE <u>10-86</u>	SCALE
REVISION Δ			CHECKED BY <u>JLB</u>	DATE <u>10-86</u>	PLAN
REVISION Δ			APPROVED BY <u>JLB</u>	DATE <u>10-86</u>	PROFILE
REVISION Δ			FIELD BOOK NO.	PAGE	HORIZ. 1" = 20'
					VERT. 1" = 5'

DEPARTMENT OF PUBLIC WORKS AND UTILITIES
ENGINEERING DIVISION
CITY OF GRAND JUNCTION, COLORADO

ONAN SEWER EXTENSION
PLAN & PROFILE

SHEET NO. 1
 OF 1
 FILE NO.