

- NOTES:**
- All construction shall be in accordance with City of Grand Junction Sanitary Sewer details - Drawings SS-1 and shall conform to City of Grand Junction "Standard Specifications for Construction of Water Lines, Sanitary Sewers, Storm Drainage and Irrigation Systems", 1981, and City of Grand Junction, General Contract Conditions for Public Works and Utilities Construction GC-37, GC-50 and GC-65.
 - All road repair shall be in accordance with Mesa County Plans & Specifications for Road & Bridge Design & Construction.

Exist. Manhole #20
Inv. Elev. = 154.66

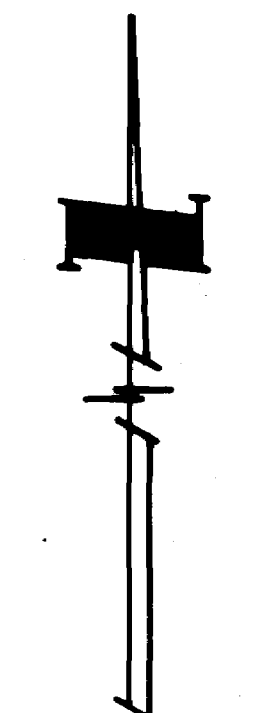

Scale: 1" = 20'

- Legend**
- Proposed San. Sewer w/MH
 - Existing San. Sewer w/MH
 - Water Meter
 - Telephone Pedestal
 - Gas Line
 - Water Line

CERTIFICATION
In accordance with the City of Grand Junction specifications and based on an actual field test of this project, I hereby certify that the infiltration rates, as stated in the standard specifications for the City of Grand Junction were not exceeded.
By: P.G. King Date: 11-15-83

Designed By: [Signature]
Date: 11-15-83

Approved By: [Signature]
Date: 11-15-83

Exist. Manhole #21
Inv. Elev. In = 148.53
Inv. Elev. Out = 144.95

In accordance with Colorado State Senate Bill 172, paragraph 9-1.5-103, the contractor shall provide notification to all utility companies two (2) business days prior to start of excavation for location & coordination of underground utilities. Underground Utilities Location Telephone Number is 245-2555

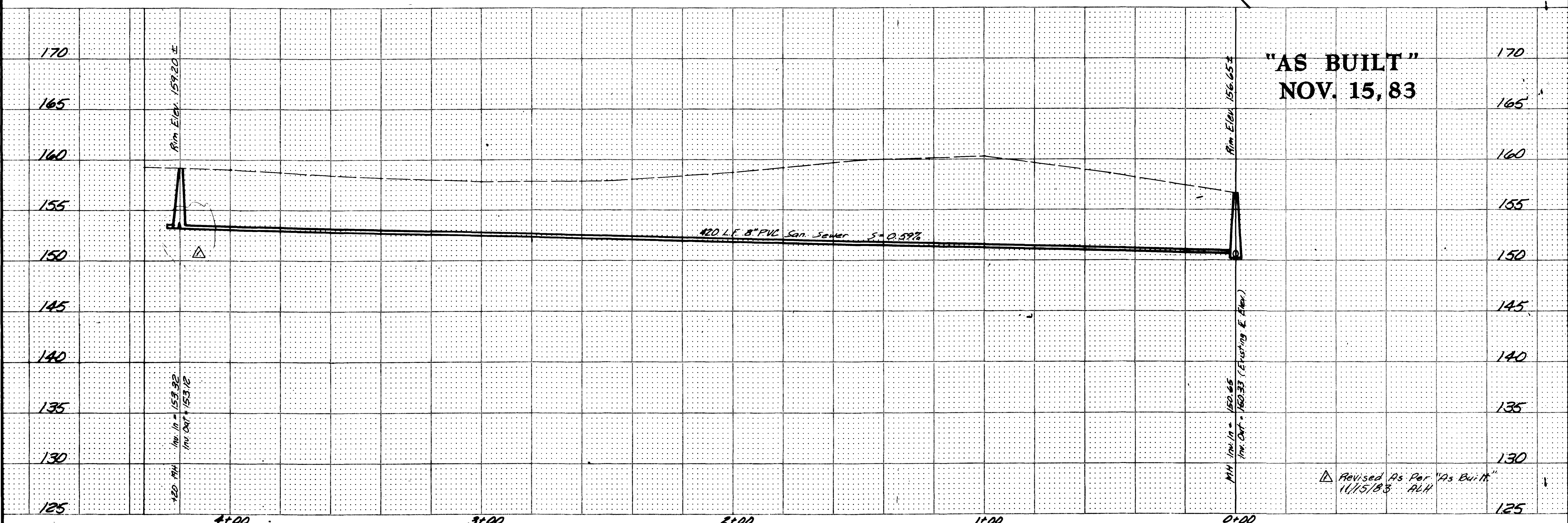

"AS BUILT"
NOV. 15, 83

Profile scale: 1" = 20' Horiz., 1" = 5' Vert.

ARMSTRONG & ASSOCIATES, INC.
725 S. Broadway, Suite 10
Grand Junction, Colorado 81505
(303) 778-0100

Architects
Engineers
Planners
Surveyors
Self Testing
Material Testing
U.S. Licensed Surveyors
Professional Engineers

Steve Smith
Sanitary Sewer

Project No: 634200
Date: Oct. 1983
Revisions:

Drawn: RLC
Checked: TAW
Approved:

Sheet: 1 of 1