

SEWER DISTRICTS Nos. 5 & 6  
 PLAT SHOWING LOCATION OF "Y's" ETC.  
 Station Number of Y as Shown Gives  
 Distance From Man Hole to "Y"  
 Scale: 1" = 200' Nov. - 1920  
 J. E. Thompson  
 City Engineer.

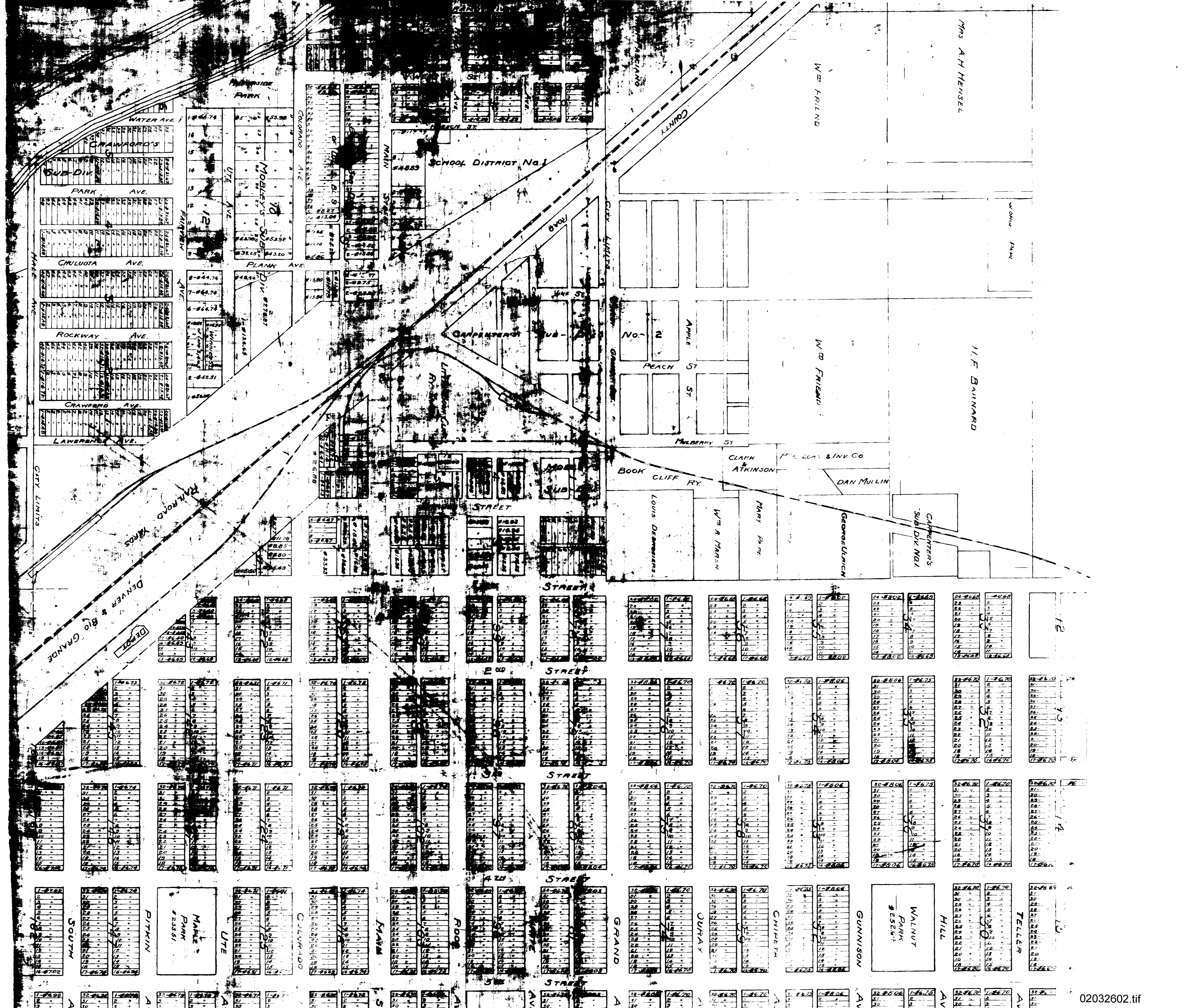

Mrs A.H. HENSEL

H.E. BARNARD

W.B. FRIEND

W.B. FRIEND

CLARK & ATKINSON

THE LAM & INV. CO.

DAN MULLIN

CARPENTERS  
Subd Div No. 1

George Ulrich

MARY PAPE

Wm A. MARSH

Louis Deming

BOOK CLIFF RY.

CLARK & ATKINSON

THE LAM & INV. CO.

DAN MULLIN

CARPENTERS  
Subd Div No. 1

George Ulrich

MARY PAPE

Wm A. MARSH

Louis Deming

BOOK CLIFF RY.

12

13

14

15

16

TELLER

HILL

WALNUT  
PARK  
#25264

GUNNISON

CHIEF

DURAY

GRAND

ROCK

MAIN

COLORADO

UTE

PITKIN

SOUTH

LIMITS		NORTH AVENUE							
1-3	1-4	1-5	1-6	1-7	1-8	1-9	1-10	1-11	1-12
BELFORD AVENUE									
13	14	15	16	17	18	19	20	21	22
TELLER AVENUE									
23	24	25	26	27	28	29	30	31	32
HILL AVENUE									
WALNUT PARK #252.64		33	34	35	36	37	38	39	40
GUNNISON AVENUE									
41	42	43	44	45	46	47	48	49	50
CHIPETA AVENUE									
51	52	53	54	55	56	57	58	59	60
CURRY AVENUE									
61	62	63	64	65	66	67	68	69	70
GRAND AVENUE									
71	72	73	74	75	76	77	78	79	80
WALL SITE		COURT HOUSE SITE							
81	82	83	84	85	86	87	88	89	90
SCHOOL									
91	92	93	94	95	96	97	98	99	100
FLAYN STREET									
101	102	103	104	105	106	107	108	109	110
COLORADO AVENUE									
111	112	113	114	115	116	117	118	119	120
121	122	123	124	125	126	127	128	129	130
UTE AVENUE									
MARLE PARK #233.51		131	132	133	134	135	136	137	138
PITKIN AVENUE									
139	140	141	142	143	144	145	146	147	148
SOUTH AVENUE									
149	150	151	152	153	154	155	156	157	158

LINCOLN PARK

EPISCOPAL CHURCH GROUNDS

DUNDIE PLACE

KEITH

ADDITIONAL

FINAL LOT ASSESSMENTS  
SEWER DISTRICTS Nos 5 & 6  
GRAND JUNCTION, COLO SEP. 1920  
BOUNDARY DISTRICT No 5  
BOUNDARY DISTRICT No 6  
SCALE: 1" = 200'  
ASSESSABLE AREA DISTRICT No 5 = 1,508,238 Sq. Ft.  
TOTAL COST = \$2,250,000.00  
ASSESSABLE AREA DISTRICT No 6 = 1,125,218 Sq. Ft.  
TOTAL COST = \$2,000,000.00