

Scale
Plan: 1" = 20'
Profile: Vert. 1" = 5'
Horiz. 1" = 20'

Benchmark:
All elevations derived from an assumed elev. of 100.00' at Rim of existing Manhole

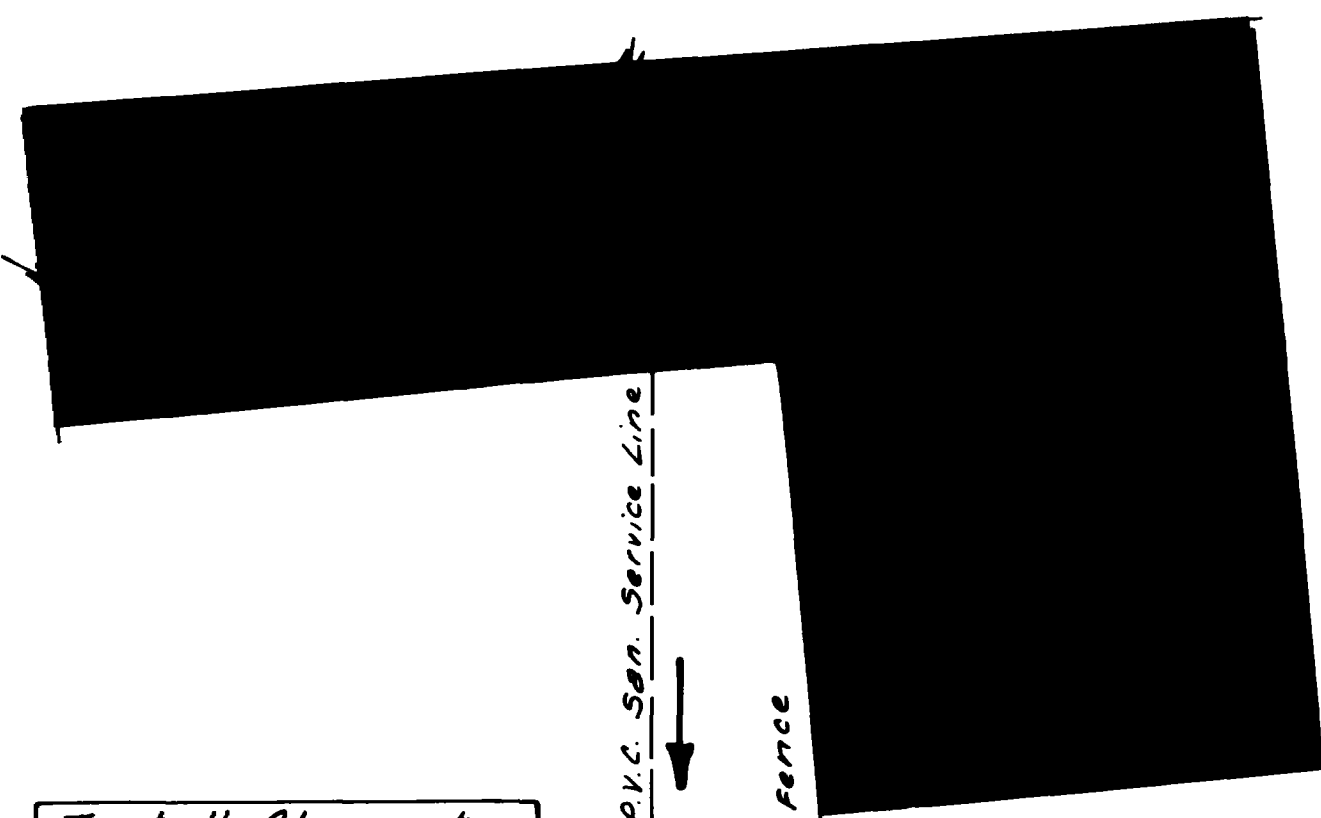

Install Cleanout on Existing 4" P.V.C.
Sta. 0+00 Locate Existing Service & Tie Into Proposed Service Line

Sawcut, Remove & Replace 3'x19' Section of Asphaltic Pavement

Sta. 3+62 Modify Existing Manhole Base

Encase sewer w/18 L.F. 8" D.I.P., Concrete collar @ each end

Construct 118 L.F. 8" P.V.C. @ 0.40%

Construct 244 L.F. 4" P.V.C. @ 1.00%

Sta. 2+44, Construct 48" Manhole w/3' Stubout of 8" P.V.C. Sewer Pipe Parallel to frontage Road

CONSTRUCTION NOTES:

- All construction shall be in accordance with the City of Grand Junction Standard Sanitary Sewer Details Drawings SS-1 & shall conform to the City of Grand Junction "Standard Specifications for Construction of Waterlines, Sanitary Sewers, Storm Drainage and Irrigation System," 1981, and City of Grand Junction General Contract Conditions for Public Works and Utilities Construction GC-37, GC-50, and GC-65.
- The contractor shall contact the City Utilities Superintendent (244-1568) prior to any disturbance of the existing sewer in Manhole #2. Existing flows in the sewer must be maintained at all times.

Contract Item #	Contract Item	Unit	Quantity
202	Sawing B.P.	L.F.	38
403	Hot Bituminous Pavement	Ton	0.6
604	Manhole (5 ft.)	Ea.	1
604	Manhole Ring & Cover	Ea.	1
604	8" P.V.C. Sewer Pipe	L.F.	121
604	4" P.V.C. Sewer Pipe	L.F.	244
604	4" Sweep 90° Bend (Long)	Ea.	1
604	Modify Existing Manhole base	Ea.	1
604	Cleanout (4")	Ea.	1

LEGEND

- Proposed Manhole
- ⊙-----Existing Manhole
- Proposed Sewer Line
- Existing Sewer Line w/ flow direct
- G- Existing 1 1/4" Gas Line (Approx 30" Deep)
- T- Existing Buried Telephone cable
- Proposed Cleanout

AS CONSTRUCTED

Reviewed: Donald C. Pettigrew 5/30/02
Approved: J.A. Armstrong



CERTIFICATION

In accordance with the City of Grand Junction specifications and based on an actual field test of this project, I hereby certify that the infiltration rates as stated in the standard specifications for the City of Grand Junction was not exceeded.

Date: 5/15/02 Dr. Donald C. Pettigrew



NO.	REVISION	DESCRIPTION	DATE
1	As-Built		5-6-02

ARMSTRONG & ASSOCIATES, INC.
Architects, Engineers, Planners, Surveyors, Soil Testing, Material Testing
1100 S. Broadway, Suite 200, Grand Junction, Colorado 81505
Phone: 261-3401 Fax: 261-4801

HANSON EQUIPMENT COMPANY
Sewer Line
Scale: Noted Date: 5-29-02
Drawn: E.A.J. Survey Date: 5-29-02
Checked: P.P. Job No: 022008