

# WEST GRAND SEWER REPAIR

## 1990

1. Cover Sheet
2. Drafting Standards & Abbreviations
3. Summary of Approximate Quantities
4. Plan & Profile
5. Standard Sanitary Sewer Details (SS-1)

VICINITY MAP

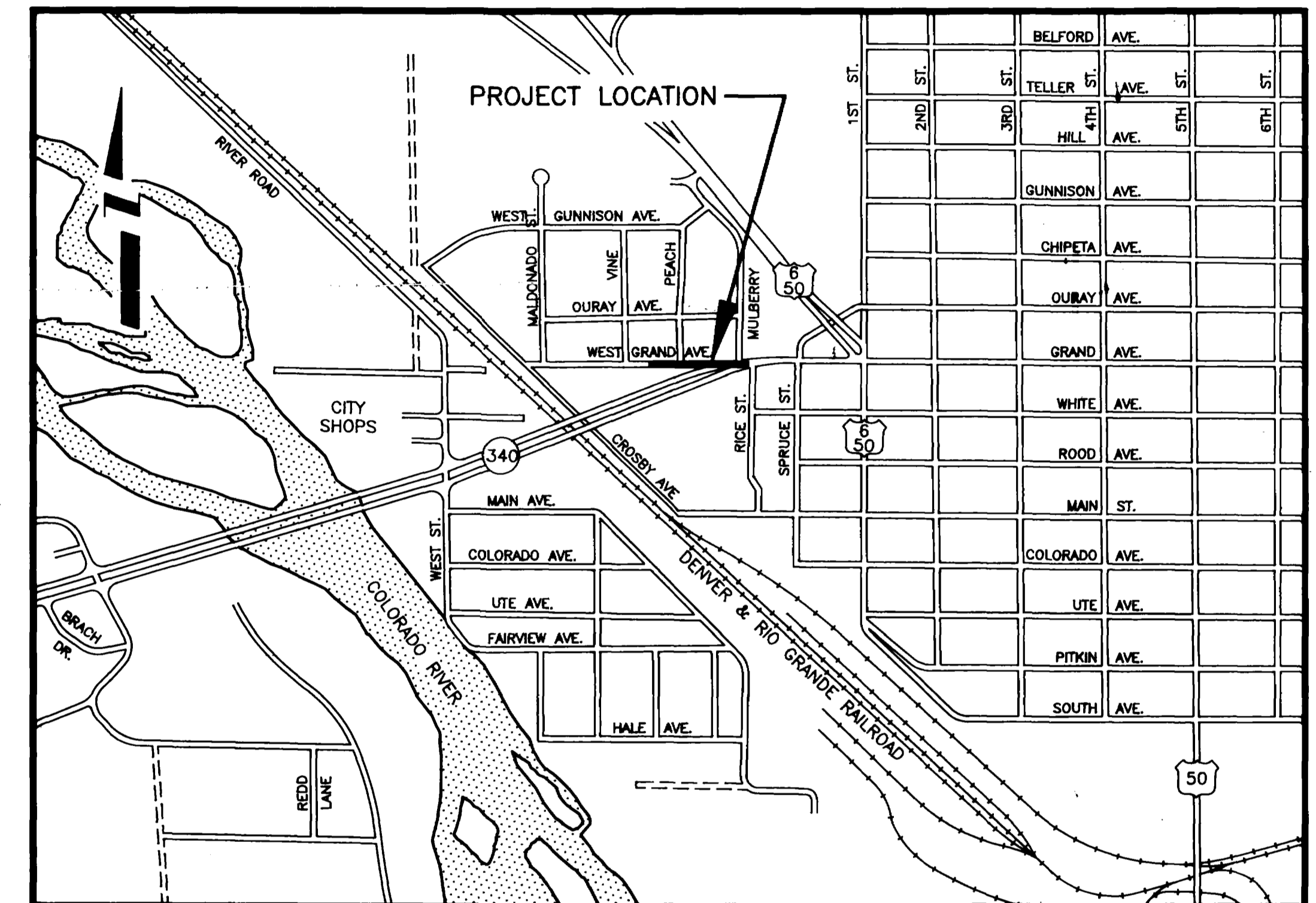

AS-BUILT, C.A.K. 9-14-92

*City of Grand Junction, Colorado*  
*Department of Public Works & Utilities*      *Engineering Division*

# SUMMARY OF APPROXIMATE QUANTITIES

Item No.	Ref. No.	Contract Item	Unit	Quantity	Item No.	Ref. No.	Contract Item	Unit	Quantity
		<u>WEST GRAND SEWER REPAIR</u>							
1.		Furnish and Install 24" Dia. P.V.C. Sewer Pipe ASTM D-3034 SDR 35 (Including Excavation and Backfill) Sta. 0+00 to 2+69	L.F.	269					
2.		Furnish and Install 24" Dia. P.V.C. Sewer Pipe ASTM D-3034 SDR 35 (Including Excavation and Backfill) Sta. 2+69 to 4+74	L.F.	205					
3.		Furnish and Install 48" Dia. Manhole	Each	2					
4.		Aggregate Base Course Class 6-6" Thick (Haul Water & Compact)	S.Y.	100					
5.		Aggregate Base Course Class 6 - 12" Thick (Haul, Water & Compact)	Tons	300					
6.		Granular Stabilization Material (Where Authorized)	Tons	60					
7.		Hot Bituminous Pavement Grading E 5" Thick (2 Lifts)	S.Y.	300					
8.		Hot Bituminous Pavement Grading E 3" Thick (1 Lift)	S.Y.	80					
9.		Fill Existing Manhole West of Manhole #2 With Flowable Fill (Approx. 7 C.Y.)	Lump Sum	Lump Sum					
10.		Install Concrete Plug in Existing 24" Concrete Line out of Manhole #2	Lump Sum	Lump Sum					
11.		Connection to Existing Pipe @ Sta. 0+00	Lump Sum	Lump Sum					
12.		Replace Iron Posts at Top of Bike Path	Each	3					
13.		Replace 18" Dia. C.M.P. at Sta. 2+35	L.F.	26					
14.		Furnish and Install 18" Dia. C.M.P.	L.F.	16					
15.		Replace Asphalt Ditch - 6" Thick	L.F.	20					
16.		24" X 24" X 18" Tee w/18" Water Tight Cap	Each	1					
17.		18" Dia. CMP 11 1/4 Degree Bend	Each	1					
18.		Traffic Control	L.S.	1					
19.		Project Signs	Each	2					
		<small>AS-BUILT, C.A.K. 9-14-92</small>							

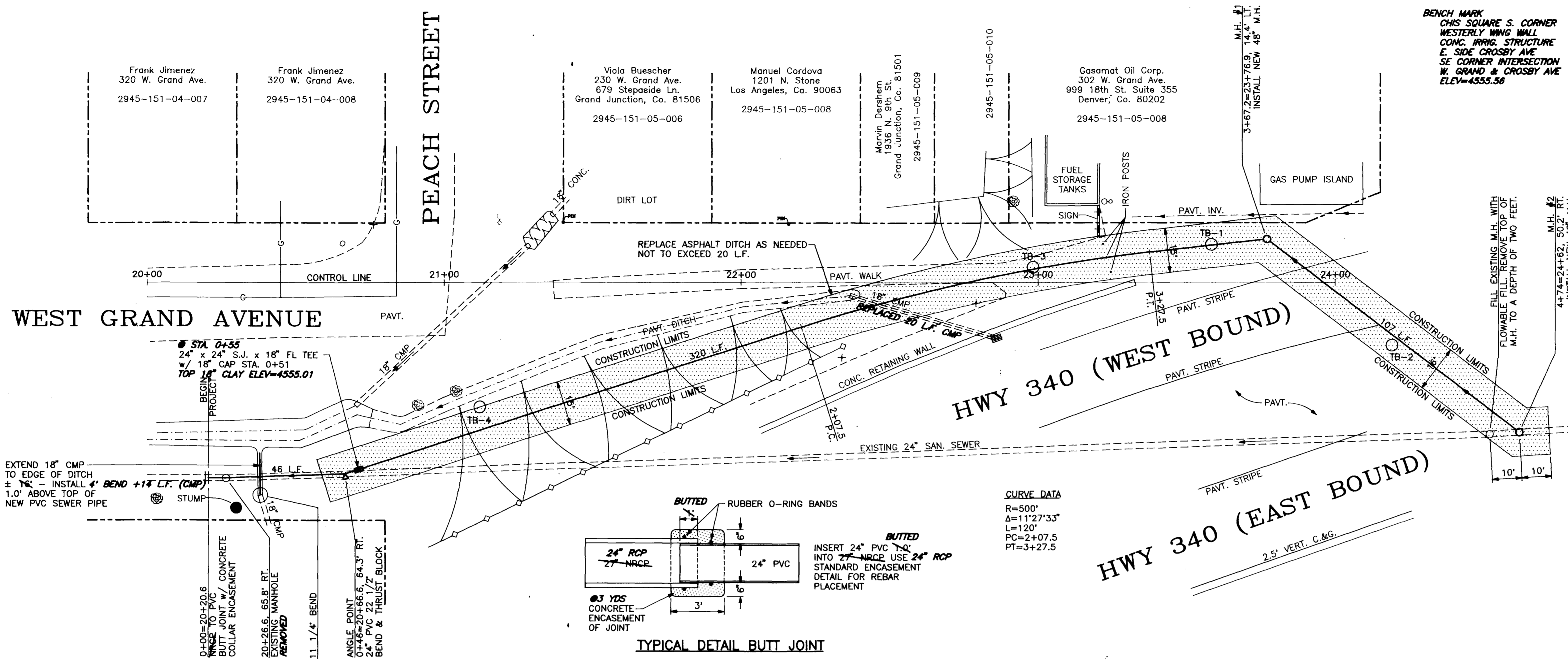

- GENERAL NOTES:**
- BACKFILL IN TRENCH BETWEEN STATIONS 2+69 AND 4+74 TO BE PIT RUN. NATIVE MATERIAL MAY BE USED BETWEEN STATIONS 0+00 AND 2+69 IF APPROVED BY CITY ENGINEER.
  - ASPHALT IN ROADWAY TO BE REPLACED A MINIMUM OF 4" ON BOTH SIDES OF UTILITY TRENCH, NOT TO EXCEED "CONSTRUCTION LIMITS".
  - ROADWAY SECTION 3+13 TO 4+74  
5" HBP-GRADE E  
12" AGGREGATE BASE COURSE-CLASS 6
  - BIKE PATH SECTION WEST OF IRON POSTS:  
3" HBP-GRADE E  
6" AGGREGATE BASE COURSE-CLASS 6

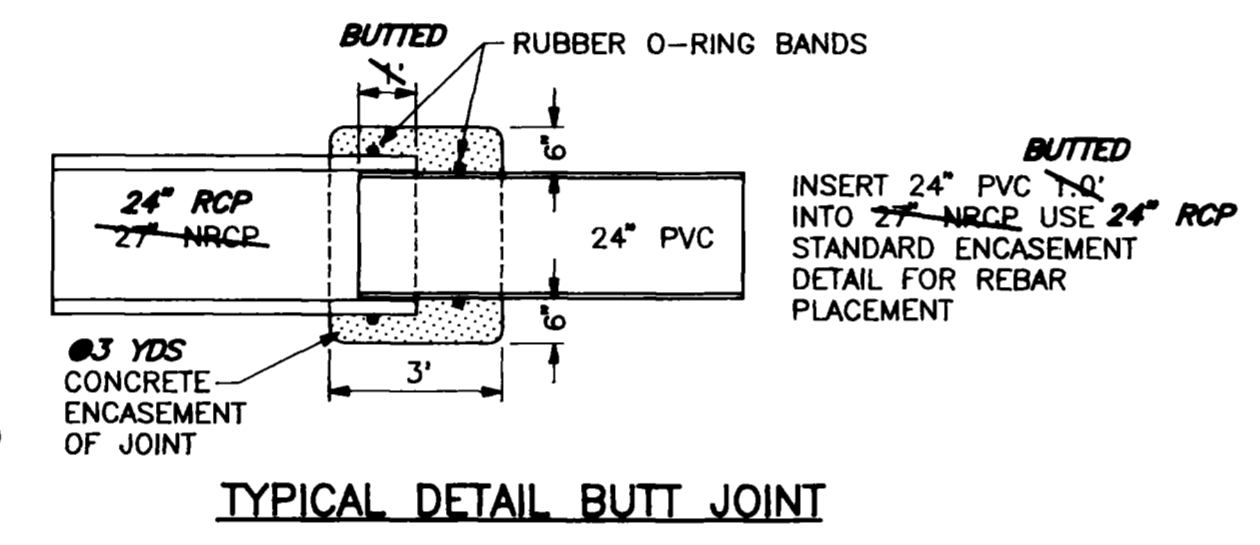

**CURVE DATA**  
R=500'  
Δ=11°27'33"  
L=120'  
PC=2+07.5  
PT=3+27.5

**PROFILE IS ALONG CENTERLINE OF NEW SEWER LINE**

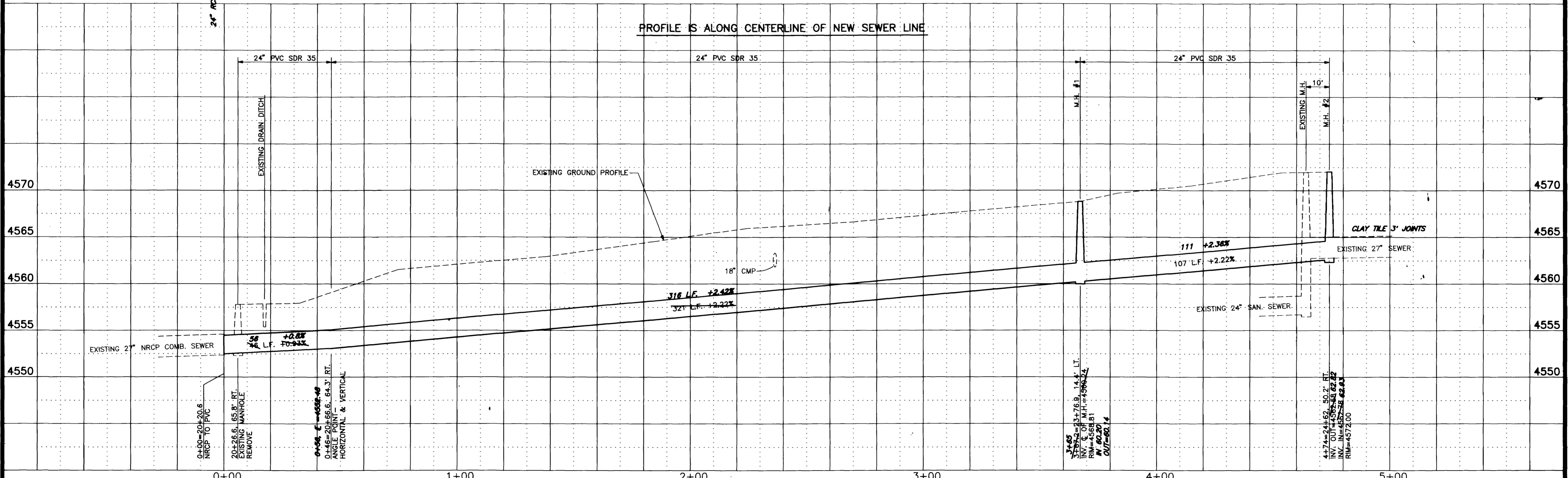

<p><b>DESCRIPTION</b> AS-BUILT, C.A.K.</p> <p><b>DATE</b> 9/14/92</p>	<p><b>DRAWN BY</b> KADEL <b>DATE</b> 7/90</p> <p><b>CHECKED BY</b> LESLEY <b>DATE</b> 7/90</p> <p><b>APPROVED BY</b> JWC <b>DATE</b> 7/90</p> <p><b>FIELD BOOK NO.</b> <b>PAGE</b></p>	<p><b>SCALE</b></p> <p><b>PLAN</b> HORIZ. 1"=20'</p> <p><b>PROFILE</b> HORIZ. 1"=20' VERT. 1"=5'</p>	<p><b>DEPARTMENT OF PUBLIC WORKS AND UTILITIES</b> <b>ENGINEERING DIVISION</b> <b>CITY OF GRAND JUNCTION, COLORADO</b></p>	<p><b>WEST GRAND SEWER REPAIR</b> <b>WEST GRAND AVE. AT HWY. 340</b> <b>Plan &amp; Profile</b></p>	<p><b>SHEET NO.</b> 4 <b>OF</b> 5 <b>FILE NO.</b> 99003.DWG</p>
---	--	--	--	--	---