

WATER AND SEWER REFERENCES												
WATER						SEWER						
LOT	PROPERTY OWNER	NO.	PROPERTY OWNER	NO.	PROPERTY OWNER	NO.	PROPERTY OWNER	NO.	PROPERTY OWNER	NO.	PROPERTY OWNER	
2	W	117	W	7	W	117	W	7	W	117	W	7
3	W	117	W	7	W	117	W	7	W	117	W	7
4	W	117	W	7	W	117	W	7	W	117	W	7
5	W	117	W	7	W	117	W	7	W	117	W	7
6	W	117	W	7	W	117	W	7	W	117	W	7
7	W	117	W	7	W	117	W	7	W	117	W	7
8	W	117	W	7	W	117	W	7	W	117	W	7
9	W	117	W	7	W	117	W	7	W	117	W	7
10	W	117	W	7	W	117	W	7	W	117	W	7
11	W	117	W	7	W	117	W	7	W	117	W	7
12	W	117	W	7	W	117	W	7	W	117	W	7
13	W	117	W	7	W	117	W	7	W	117	W	7
14	W	117	W	7	W	117	W	7	W	117	W	7
15	W	117	W	7	W	117	W	7	W	117	W	7
16	W	117	W	7	W	117	W	7	W	117	W	7

1 INSTALLED AS PART OF 1983 IMPROVEMENTS BY BECK AND ASSOC.

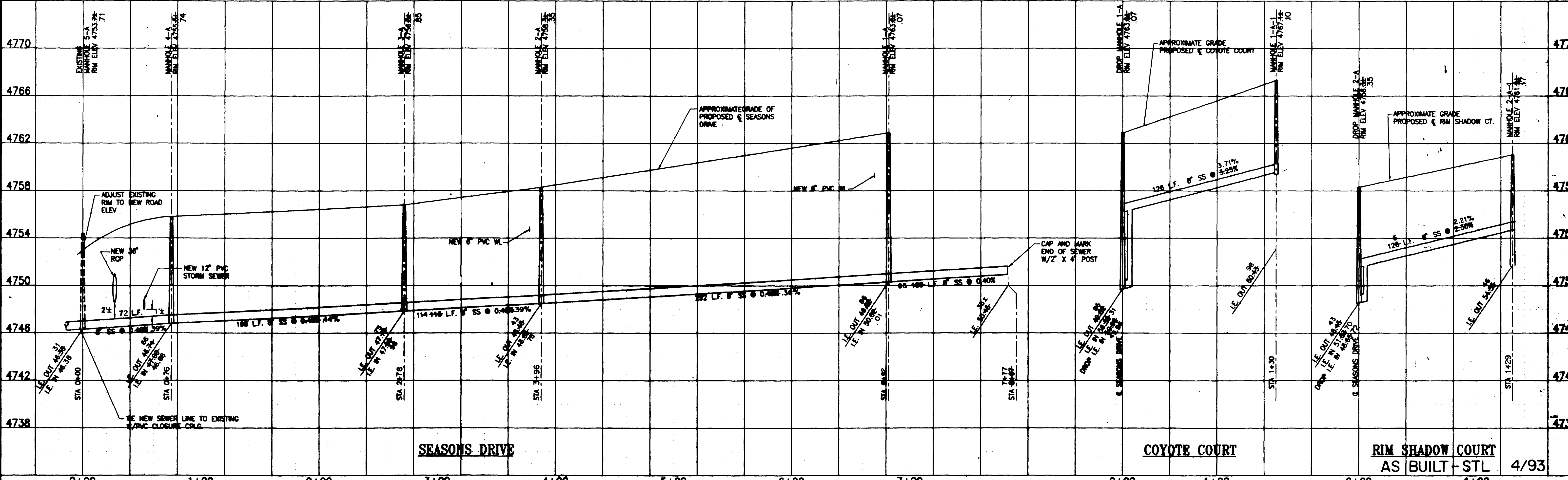

REVISIONS	DATE	SCALE
DROP MH 1-A; 2-A REVISIONS	1/83	1"=40' HORIZONTAL
AS BUILT - STL	4/93	1"=4' VERTICAL

- GENERAL NOTES**
- ALL SEWER CONSTRUCTION SHALL BE IN ACCORDANCE WITH THE CITY OF GRAND AVENUE'S ORDINANCES AND SPECIFICATIONS. ADJUST AS NECESSARY TO BE SHOWN BY LINES.
 - ALL SEWER PIPE SHALL BE 4 IN. DIA. 30 P.C.
 - ALL SEWER SEWER SERVICES SHALL BE 4 IN. DIA. 30 P.C.
 - SEWER SERVICES SHALL EXTEND 10 FT. BEYOND THE POINT OF USE AND BE CAPPED AND BURNED WITH A 24" POST EXTENDING TO THE GROUND SURFACE.
 - THE CONTRACTOR SHALL NOTIFY THE CITY OF GRAND AVENUE AND THE USE USER AGENCY 24 HOURS PRIOR TO THE BEGINNING OF CONSTRUCTION.
 - LOCATION OF EXISTING UTILITIES SHOWN IS APPROXIMATE ONLY, BASED ON INFORMATION FURNISHED BY THE UTILITY COMPANIES AND FIELD SURVEYS. THE CONTRACTOR SHALL BE RESPONSIBLE FOR VERIFYING ACTUAL UTILITY LOCATION AND PROVISION BEFORE CONSTRUCTION. GAS, ELECTRIC, TELEPHONE LINES, ETC. NOT SHOWN.
 - ALL MATERIALS SHALL BE COMPARED TO ONE AS DETERMINED BY AUSTRIAN 1-95.
 - ALL MATERIALS CONSTRUCTION SHALL BE IN ACCORDANCE WITH THE USE USER AGENCY'S ORDINANCES AND SPECIFICATIONS.
 - CONTRACTOR CAN CHECK TO GENERALLY ESTABLISHED TRENCH DEPTHS OR USE USER AGENCY FOR DETAIL ON SHEET 9 TO UNDERSTAND DIMENSIONS OF 80' COLLECTOR AND 12" P.C. SEWER SERVICE (IF NECESSARY).
 - SEWER SERVICES SHALL BE SUPPLIED BY THE USE USER AGENCY.
 - SEWER SERVICE SHALL BE 4 IN. DIA. 30 P.C. AND SHALL BE 4 IN. DIA. 30 P.C. AND SHALL BE 4 IN. DIA. 30 P.C.
 - CONTRACTOR SHALL NOTIFY THE USE USER AGENCY TO CLOSE IMMEDIATELY PRIOR TO INSTALLATION OF ALL THE EXISTING UTILITIES ON SEWER LINE.
 - CONTRACTOR SHALL NOTIFY THE USE USER AGENCY TO CLOSE IMMEDIATELY PRIOR TO INSTALLATION OF ALL THE EXISTING UTILITIES ON SEWER LINE.
 - SEWER AND SEWER LAYOUT AND DESIGN PER BECK AND SHULM AND APPROVED 10/13/92. REDRAWN BY WESTWATER ENGINEERING 11/92.
 - SEWER SERVICE LINES SHALL BE FLEXIBLE TYPE X COPPER AND BE 3/4" DIA.

WestWater Engineering
 P.O. Box 1470
 Palisade, Colorado 81526

THE SEASONS AT TIA RADO-FILING #3
UTILITY COMPOSITE
SEWER PLAN & PROFILE

Design By: R.C.L. Drafted By: R.C.L. Date: 11/92 Project No. 9226 Sheet 7 OF 9