

ENGINEER'S STATEMENT
 BANNER ASSOCIATES, INC. REVIEWED THE CONSTRUCTION OF THE SANITARY SEWER EXTENSION AT THE CENTRAL BANK DRIVE-THRU FACILITY AS SHOWN ON THIS PLAN AND THAT TO THE BEST OF OUR KNOWLEDGE IT CONFORMS TO THE CITY OF GRAND JUNCTION STANDARDS AND SPECIFICATIONS.

BANNER ASSOCIATES, INC.

DATE _____

CONSTRUCTION DRAWING OF RECORD

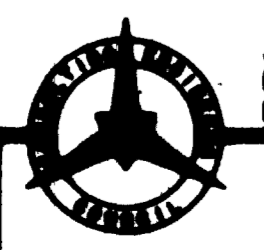
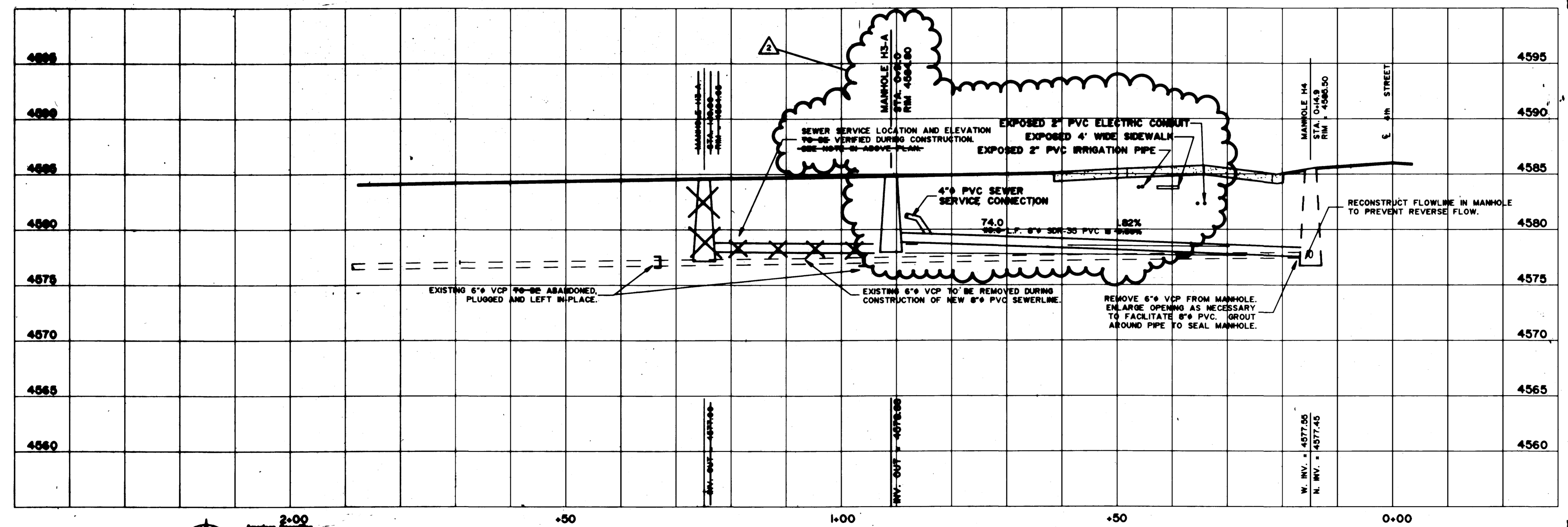

2-00
 Banner Associates, Inc.
 Professional Engineer
 Grand Junction, Colorado

BANNER

BANNER ASSOCIATES, INC. • CONSULTING ENGINEERS & SURVEYORS
 5777 CROSSROADS BOULEVARD • GRAND JUNCTION, CO 81504 • (970) 243-2242
 605 E. MAIN • SUITE 6 • ASPEN, CO 81611 • (970) 925-5557

REVISION	DATE	DESCRIPTION	BY	CHKD
L	06-16-93	ADD ADDITIONAL NOTES AS PER CITY REVIEW.	DEC	DEC
A	8-03-93	REVISE AS CONSTRUCTION DRAWING OF RECORD	FJK	DEC

ALPINE C.M., INC.

SANITARY SEWER RELOCATION
 CENTRAL BANK DRIVE-THRU FACILITY

GRAND JUNCTION, COLO.

SCALE: HORIZ: 1" = 10' VERT: 1" = 5'	Project No: 8284-00
DATE: 06-16-93	SHEET No: 1 of 1