

- NOTES:**
- 1). COMPACTION TESTING, STAKING OF SEWER LINE AND CURB & GUTTER STAKING BY WESTERN ENGINEERS INC., GRAND JUNCTION, COLORADO.
 - 2). CONSTRUCTION BY M.A. CONCRETE CONSTRUCTORS, MAYS CONCRETE AND UNITED SAND AND GRAVEL ALL OF GRAND JUNCTION, COLORADO.
 - 3). SHALLOW 10" SANITARY SEWER LINE COVERED WITH FLOWABLE FILL SAND CONCRETE FROM SPRING LINE, MINIMUM COVER = 2.0 FEET.
 - 4). 2.0' CONCRETE COLLARS PLACED ON 10" SEWER LINE AT C-900 WATER LINE PROTECTION JOINT, SEWER STATION 1+20.95 AND SEWER STATION 1+38.95.
 - 5). NO PROTECTION PROVIDED ON 10" SANITARY SEWER LINE FOR 6" FIRE LINE CROSSINGS.
 - 6). TRUST BLOCKS PLACED AT ELBOWS, FIRE HYDRANT TEES, FIRE HYDRANT RISER ELBOWS (WEEP HOLES NOT COVERED) AND UNDER INSTALLED VALVES.
 - 7). FROM WATER LINE STATION 1+47.83 TO WATER LINE STATION 2+55.20 COVER OVER WATER LINE IS OUT OF THE CITY OF GRAND JUNCTIONS 4.00' SPECIFICATION, MINIMUM DEPTH OF COVER IS 3.58'.
 - 8). INITIAL PRESSURE FOR 12" C-900 WATER LINE PRESSURE/LEAKAGE TEST WAS 206 PSI BETWEEN VALVES LOCATED AT STATION 0+39.06 AND STATION 11+98.41, AFTER 2 HOURS PRESSURE DROPPED TO 202 PSI, 1.21 GALLONS OF WATER NEEDED TO PRESSURE WATER LINE UP TO 208 PSI, 12" C-900 WATER LINE PASSED THE PRESSURE/LEAKAGE TEST (6/22/93). TESTS ON 12" WATER LINE WEST OF VALVE LOCATED AT STATION 0+39.06 WERE NOT OBSERVED.
 - 9). ALL ELBOWS, TEES, RISER ELBOWS, VALVES AND DRESSER COUPLINGS WERE ENCASED WITH POLYETHYLENE MATERIAL BEFORE PLACEMENT OF TRUST BLOCKS. TRACING WIRE TAPED EVERY 25.0' FOR THE FULL LENGTH OF THE WATER LINE.

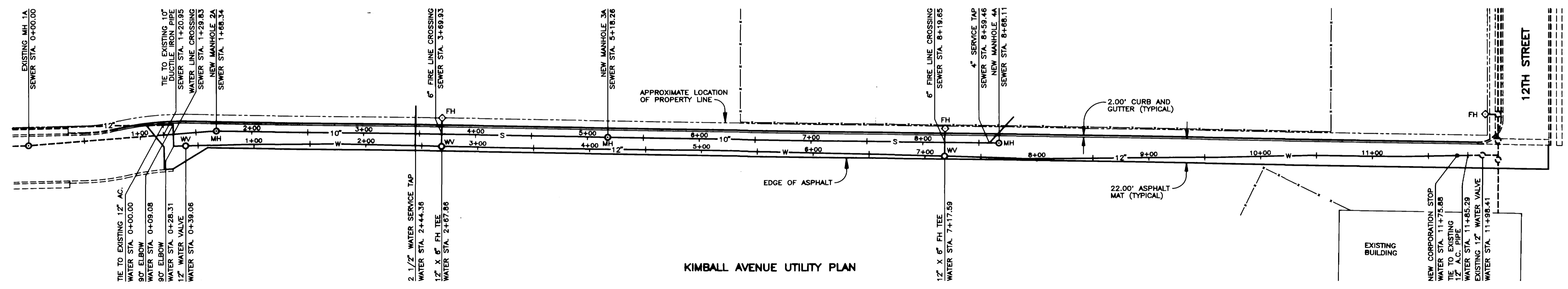
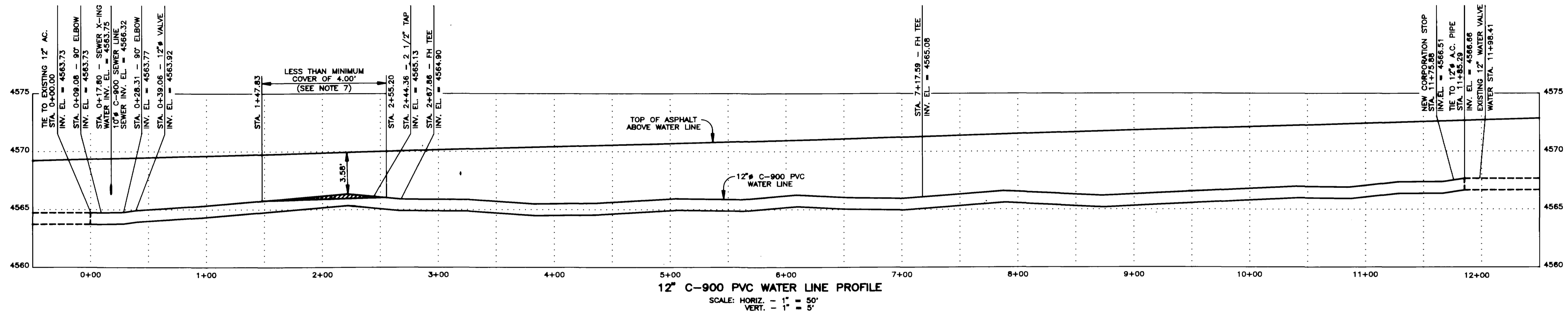

- MATERIALS LIST:**
- 1). 12" C-900 (BLUE BRUTE) PVC PIPE FOR WATER LINE.
 - 2). 6" C-900 (BLUE BRUTE) PVC PIPE FOR FIRE HYDRANT ASSEMBLY.
 - 3). 10" SDR-35 PVC PIPE FOR SEWER LINE EXCEPT 18.00' OF 10" C-900 SEWER LINE AT WATER MAIN CROSSING.
 - 4). 1 - 4" TAPPING SADDLE FOR SEWER SERVICE TAP AND 4" PVC PIPE TO TIE IN SERVICE.
 - 5). 2 - 12" SMITH BLAIR 400 SERIES FLANGED DRESSER COUPLINGS.
 - 6). 2 - 12" CLASS 350 FLANGED 90° ELBOWS.
 - 7). 1 - 12" 400 TEST MUELLER 200W FLANGED VALVE.
 - 8). 2 - 12" x 6" TYLER CLASS 350 D.I. FLANGED TEES.
 - 9). 2 - 6" 400 TEST MUELLER 200W FLANGED VALVES.
 - 10). 2 - 6" STANDARD FIRE HYDRANT ASSEMBLIES.
 - 11). 1 - 2 1/2" STANDARD BRASS WATER TAP AND SERVICE LINE.
 - 12). 1 - STANDARD CORPORATION STOP.

10" SANITARY SEWER TRAVERSE TABLE

SECTION OF SEWER LINE	BEARING	DISTANCE
MH1A-MH2A	N 85°31'56" E	168.34'
MH2A-MH3A	S 89°07'27" E	349.92'
MH3A-MH4A	S 89°07'27" E	349.85'

10" SANITARY SEWER LEAK TEST DATA

SECTION TESTED	LENGTH OF PIPE TESTED (FEET)	TIME (MIN) TEMPERATURE EQUILIBRIUM	INITIAL PRESSURE (PSI)	ENDING PRESSURE (PSI)	TEST TIME (MIN)	RESULT OF AIR TEST	RESULT OF LAMP TEST
MH1A-MH2A	166	1.0	4.0	0.0	2.5	FAIL	PASS
MH2A-MH3A	350	0.0	4.2	4.1	7.5	PASS	PASS
MH3A-MH4A	342	2.0	4.0	3.5	8.5	PASS	PASS

- LEGEND:**
- s- 10" SANITARY SEWER MAIN
 - w- 12" WATER MAIN
 - - - EXISTING FENCE LINE
 - MH - SANITARY SEWER MANHOLE
 - FH - FIRE HYDRANT
 - WV - WATER VALVE

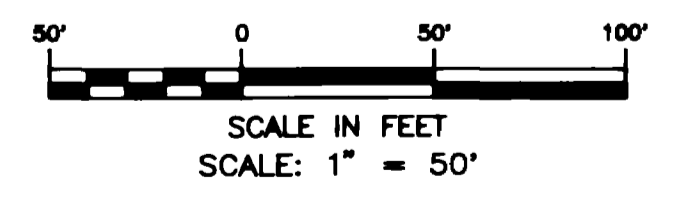

CITY OF GRAND JUNCTION APPROVAL

NAME	TITLE	DATE
------	-------	------

WESTERN CONSULTING ENGINEERS / LAND SURVEYORS
 ENGINEERS, INC. 2139 Hwy 6 & St, Grand Junction, CO (970)948-8888

AS-BUILT FOR
M.A. CONCRETE CONSTRUCTORS
 OF KIMBALL AVE. REPLACEMENT PROJECT
 WATER LINE, SEWER LINE AND ROADWAY
 CITY OF GRAND JCT., MESA COUNTY, COLORADO

SURVEYED R.A.M.	DRAWN M.J.L.	CHECKED B.D.M.
DATE 8-24-93	WEI DWG. NO. 3503-1120-2	