

LEGEND & NOTES

- Elevation control bench = 4708.15 on Mesa County Brass Cap SE corner NW1/4 Sec. 1

Also the rim elevation of the existing Manhole at the intersection of 15th Street and Ridge Drive is 4705.35

Manhole rim elevations are not set to finish grade as street has not been paved this date 11/18/92

NOTES:

All materials and workmanship shall be subject to inspection by the City of Grand Junction. The City of Grand Junction reserve the right to accept or reject any materials and workmanship that does not conform to the standards and specifications of the City of Grand Junction.

The Contractor shall have one signed copy of the Plans, and a copy of the City of Grand Junction's standards and specifications at the job site at all times.

SCALE: HOR. 1" = 50' FT
 VERT 1" = 5' FT

AS BUILTS
 11/18/92

NOTICE:

ACCORDING TO COLORADO LAW YOU MUST COMMENT ANY LEGAL ACTION BASED UPON ANY DEFECT IN THIS SURVEY WITHIN THREE YEARS AFTER YOU FIRST DISCOVER SUCH DEFECT. IN NO EVENT MAY ANY ACTION BASED UPON ANY DEFECT IN THIS SURVEY BE COMMENCED MORE THAN TEN YEARS FROM THE DATE OF THE CERTIFICATION SHOWN HEREON.

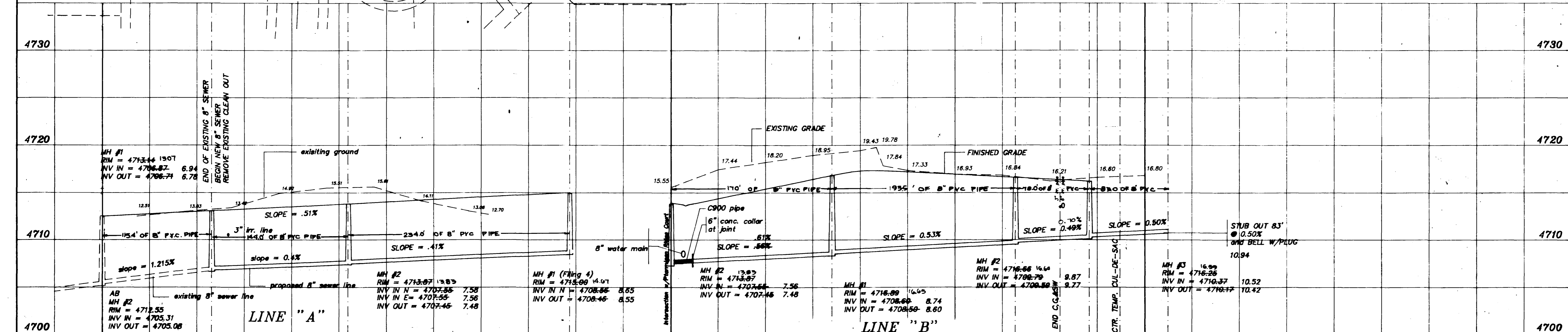

SEWER NOTES

- All construction & materials shall comply with the City of Grand Junction specifications & standard details
- Extend laterals inside Lot lines 14 feet
- Where sewerlines and water mains cross within 10 horizontal feet of each other, the sewer pipe shall be a minimum of 18 inches clear distance vertically below the water main; otherwise special sewerline construction is required which shall consist of: a) AWWA C-900 PVC sewer pipe with 6" thick concrete collars which shall extend at least 6 inches on either side of joints. If the sewer line crosses a water main, an 18 foot minimum length pipe section shall be centered with respect to the water main, having collared end joints; or b) 6" inch thick concrete encasement along the entire length of sewerline.

- Leave Rim elevations 3" below finish grade - road contractor to bring rims to grade after paving and grout per Grand Junction's specs.
- Sewer service laterals shall be installed 14' inside property line (Roadway Right-of-way line) and capped with water-tight plugs. They shall be marked with a 4"x4" buried vertically above the end of the pipe and extending 6" above the ground surface. The top 6" of the board shall be painted white.
- Cover sewer a minimum of 42"
- Pipe specifications: Main - PVC-ASTM D 3034 - SDR 35 8"
 PVC-AWWA C900
 Laterals - PVC-ASTM D 3034 - SDR 35 4"

WATER NOTES:

- All construction & materials shall comply with Ute Water and/or the City of Grand Junction specifications & standard details
- All water services 3/4" copper Type K
- Extend all water laterals 5' inside property lines
- Water service locations shall be installed 5' beyond the property line (Roadway right-of-way line) and capped with corporation stop. They shall be marked with a 4"x4" buried vertically above the end of the pipe and extending 6" above the ground surface. The top 6" of the board shall be painted blue.

- Cover minimum of 57" Ute Water depth
- Pipe specifications: 8" water - C-900 Class 150 DR 18

Trenches:
 Trench backfill shall be compacted to 95% standard Proctor density in 12" lifts (max) in R.O.W.

PTARMIGAN RIDGE FILING THREE
 SEWER LINE "A" & "B" PLAN & PROFILE (AS BUILTS)

FOR: PTARMIGAN INVESTMENTS

Q.E.D. SURVEYING SYSTEMS Inc.
 1018 COLO. AVE.
 GRAND JUNCTION, COLORADO 81501
 (303) 241-2370
 464-7558

SURVEYED BY: DAMN MF
 DRAWN BY: MEM
 ACAD ID: PRJSEWAS
 SHEET NO. 5 OF 6
 FILE: 90090

DATE: 11/18/92