

- SEWER NOTES**
- All construction & materials shall comply with the City of Grand Junction specifications & standard details
 - Sewer lines shall be located a minimum of 10' horizontally and 18" vertically from all water lines. At crossings with less than 18" vertical spacing a single length of pipe, 18" minimum shall be centered at the crossing. The crossing shall be encased in a 8" collar and extending 12" beyond the diameter of the water pipe on both sides.
 - Where sewerlines and water mains cross within 10 horizontal feet of each other, the sewer pipe shall be a minimum of 18 inches clear distance vertically below the water main; otherwise special sewerline construction is required which shall consist of: a) AWWA C-900 PVC sewer pipe with 6" thick concrete collars which shall extend at least 6 inches on either side of joints. If the sewer line crosses a water main, an 18 foot minimum length pipe section shall be centered with respect to the water main, having collared end joints; or b) 6" inch thick concrete encasement along the entire length of sewerline.
 - Sewer service laterals shall be installed 10' inside property line (Roadway Right-of-way line) and capped with water-tight plugs. They shall be marked with a 4"x2"x4" buried vertically above the end of the pipe and extending 6" above the ground surface. The top 6" of the board shall be painted white.
 - Cover sewer a minimum of 48"
 - Pipe specifications: Main - PVC-ASTM D 3034 - SDR 35 8"
Laterals - PVC-ASTM D 3034 - SDR 35 4"

ALL UTILITIES WERE INSTALLED IN FRONT OF LOTS WITHIN 14' UTILITY EASEMENT. GAS WAS INSTALLED WITHIN FRONT 3 FT.

INSTALLED WATER LINE IS 8" CV 900 (PVC) AT DEPTH OF APP. 52" COVER.

Trenches:
Trench backfill shall be compacted to 95% standard Proctor density in 8" lifts
Irrigation lines to be placed in same trench with sewer lines and laterals (N/B)

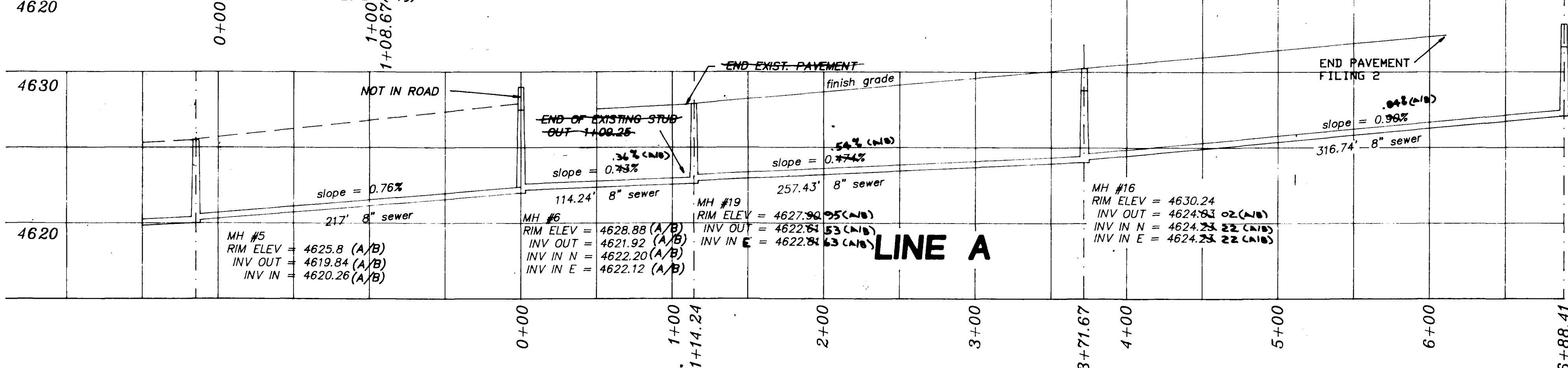
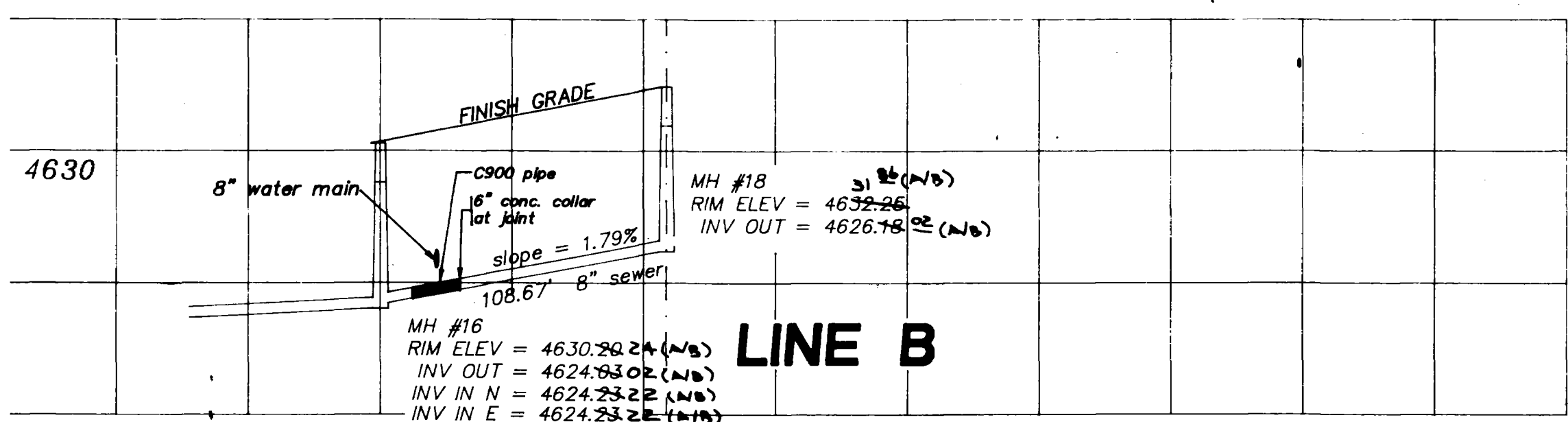

WILSON RANCH FILING NO. TWO SEWER PLANS

AS BUILT
4/20/93
Engineer: Terry Nichols

REV. 3/12/93 VAP
REV. 2/1/93

WILSON RANCH FILING NO. TWO
SITUATED IN THE NW1/4 SE1/4, SECTION 34, T1N, R1W, UTE MERIDIAN

FOR: GNT DEVELOPMENT CORP.		SURVEYED BY: DM, MF, DB
SCALE: 1" = 50'		DRAWN BY: DKB
DATE: 1/1/93	1018 COLO. AVE. GRAND JUNCTION COLORADO 81501 (303) 241-2370 464-7568	ACAD ID: WR2SEW
		SHEET NO.
		FILE: 91014.1