

- CONSTRUCTION NOTES:**
- ① ASPHALT IS 3 1/2" THICK ON CORTLAND AVE.
  - ② ALL CONSTRUCTION TO BE DONE IN ACCORDANCE WITH CITY OF GRAND JUNCTION STANDARDS AND SPECIFICATIONS.
  - ③ CONTRACTOR RESPONSIBLE FOR OBTAINING ALL APPROVALS AND PERMITS.
  - ④ CITY OF GRAND JUNCTION PUBLIC WORKS DEPARTMENT SHALL BE NOTIFIED 24 HOURS PRIOR TO THE START OF CONSTRUCTION.
  - ⑤ CHECK DEPTH OF UTE 8" A.C. WATER LINE PRIOR TO START OF CONSTRUCTION.
  - ⑥ UTILITY LOCATIONS AS SHOWN ARE APPROXIMATE ONLY CONTRACTOR TO FIELD VERIFY ALL UTILITIES PRIOR TO THE START OF CONSTRUCTION.

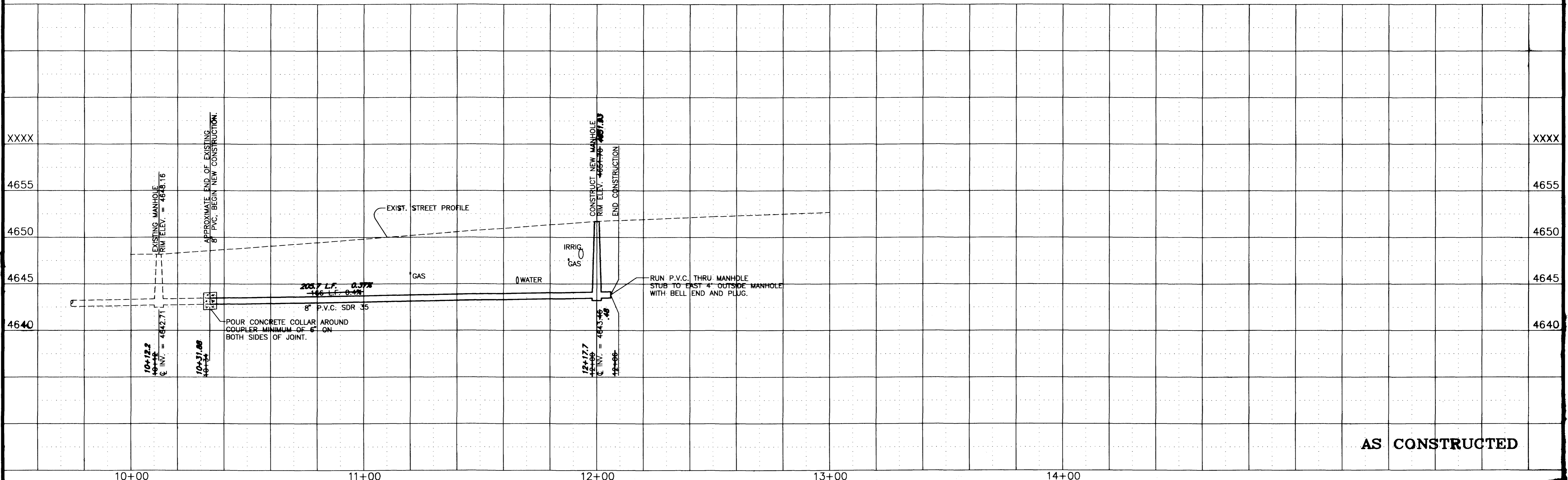

AS CONSTRUCTED

REVISION	DESCRIPTION	DATE
REVISION Δ		
REVISION Δ		
REVISION Δ		
REVISION Δ		

DRAWN BY	DATE
CHECKED BY	DATE
APPROVED BY	DATE
FIELD BOOK NO.	PAGE

SCALE	
PLAN	PROFILE
HORIZ. 1"=20'	HORIZ. 1"=20'
	VERT. 1"=5'

DEPARTMENT OF PUBLIC WORKS AND UTILITIES  
ENGINEERING DIVISION  
CITY OF GRAND JUNCTION, COLORADO

SANITARY SEWER EXTENSION 1992  
CORTLAND AVENUE  
Plan & Profile

SHEET NO.	1
OF	1
FILE NO.	CORTLAND