

VERT: 1" = 5'  
 SCALE:  
 HORZ: 1" = 50'

COORDINATES - SEWER LATERALS

PT NUM	NORTHING	EASTING	ELEVATION	DESCRIPTION
344	5001.32	4961.41	4691.33	STUBOUT
345	4927.64	4698.45	4690.93	STUBOUT
349	4997.37	4779.81	4692.34	STUBOUT
351	5039.58	4853.98	4692.54	STUBOUT
352	5142.48	4779.15	4693.88	STUBOUT
353	5188.52	4844.12	4693.70	STUBOUT
354	5199.78	4778.71	4694.22	STUBOUT
355	5301.03	4854.79	4695.81	STUBOUT
359	5295.59	4972.08	4695.33	STUBOUT
360	5226.30	4973.79	4693.52	STUBOUT
362	4923.41	4966.76	4690.05	STUBOUT
363	4831.05	4848.74	4689.60	STUBOUT
364	4757.31	4891.46	4689.50	STUBOUT
365	4723.08	4891.98	4689.90	STUBOUT
366	4689.45	4871.03	4689.00	STUBOUT
370	4691.28	4803.86	4688.94	STUBOUT
372	4745.74	4781.61	4689.27	STUBOUT
373	4787.56	4782.40	4689.76	STUBOUT
374	4853.59	4779.09	4691.22	STUBOUT
378	5112.95	4847.57	4692.95	STUBOUT
379	4768.40	4818.69	4689.16	APPROX STUBPIPE
380	4759.65	4821.24	4688.29	STUB PIPE
613	5297.64	4753.50	4699.89	GROUND ELEV.
614	5069.83	4778.73	4694.10	SEWER STUB APRX.

All materials and workmanship shall conform to the specifications of the Central Grand Valley Sanitation District. The Central Grand Valley Sanitation District reserves the right to accept or reject any materials and workmanship that do not conform to the standards and specifications of the Central Grand Valley Sanitation District.

The Contractor shall be responsible for the accuracy of the field data and a copy of the Central Grand Valley Sanitation District's specifications at the job site at all times.

The Contractor is responsible for the accuracy of the field data during construction of the manholes.

MH A-1 should be built around the existing sewer line by cutting the top of the existing sewer line and installing the side pipe for the new sewer line invert in.

All sewer mains shall be laid to grade utilizing a pipe laser.

All service line connections to the new main shall be accomplished with full-body wyes or tees. Tapping saddles will not be allowed.

WATER METER      WATER VALVE

AS BUILTS  
 11/16/93

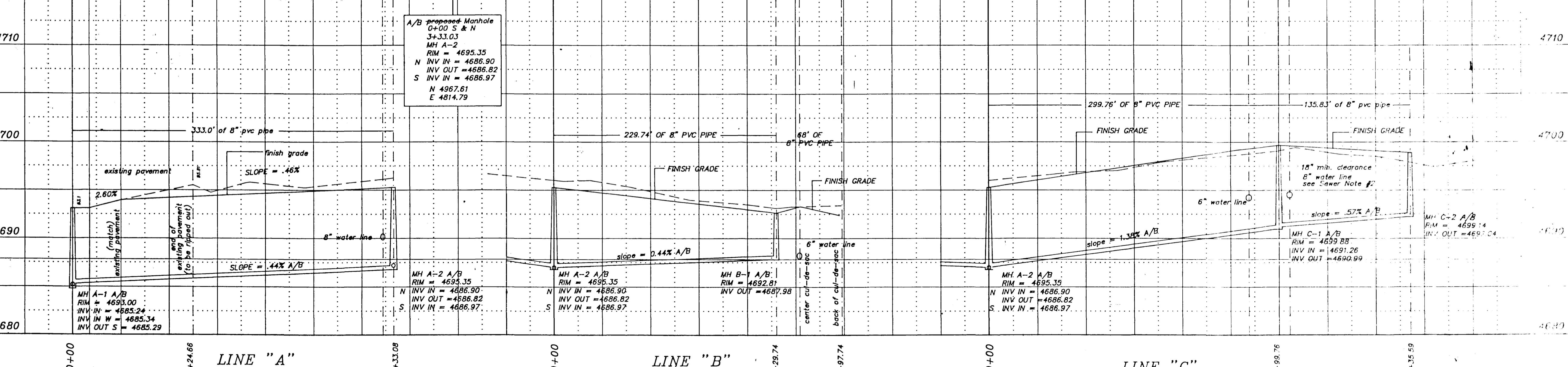

SEWER NOTES

- All construction & materials shall comply with the County of Mesa specifications & standard details
- Where sewerlines and water mains cross within 10 horizontal feet of each other, the sewer pipe shall be a minimum of 18 inches clear distance vertically below the water main; otherwise special sewerline construction is required which shall consist of: a) AWWA C-900 PVC sewer pipe with 6" thick concrete collars which shall extend at least 6 inches on either side of joints. If the sewer line crosses a water main, an 18 foot minimum length pipe section shall be centered with respect to the water main, having collared end joints; or b) 6" inch thick concrete encasement along the entire length of sewerline.

- Leave Rim elevations 3" below finish grade - road contractor to bring rims to grade after paving and grout per Central Grand Valley specs.
- Sewer service laterals shall be installed 14" inside property line (Roadway Right-of-way line) and glue capped with water-tight plugs. They shall be marked with a 4"x2"x4" buried vertically above the end of the pipe and extending 2' above the ground surface. The top 6" of the board shall be painted green.
- Cover sewer a minimum of 72" if grade permits.
- Pipe specifications: Main - PVC-ASTM D 3034 - SDR 35 8"  
 PVC-AWWA C900 8"  
 Laterals - PVC-ASTM D 3034 - SDR 35 4"

WATER NOTES:

- All construction & materials shall comply with Clifton Water and/or the Central Grand Valley San. District specifications & standard details
- All water services 3/4" copper Type K
- Extend all water laterals 5' inside property lines
- Water service locations shall be installed 5' beyond the property line (Roadway right-of-way line) and capped with corp. stops. They shall be marked with a 4"x2"x4" buried vertically above the end of the pipe and extending 8" above the ground surface. The top 8" of the board shall be painted blue.

- Cover minimum of 57" per. Clifton Water specs.
- Pipe specifications: 8" water - C-900 Class 150 DR 18  
 4" water - SDR 21

Trenches:  
 Trench backfill shall be compacted to 95% standard Proctor density in 12" lifts (max) in R.O.W.

EASTBROOK MEADOWS SUBDIVISION  
 SEWER LINE "A", "B" & "C" PLAN & PROFILE - AS BUILTS

FOR: PAGE	Q.E.D. SURVEYING	SURVEYED BY: [Signature]
SCALE: VERT. 1" = 5'	1018 COLG. AVE.	DRAWN BY: [Signature]
SCALE: HORZ. 1" = 50'	GRAND JUNCTION	ACAD ID: [Number]
DATE: 11/5/91	COLORADO 81501	SHEET NO: [Number]
	(303) 241-2370	FILE: [Number]
	464-7568	