

LEGEND

- W --- EXISTING WATER LINE
- S --- EXISTING SEWER MAIN, MANHOLE
- S --- PROPOSED SEWER MAIN, SERVICES, MANHOLES
- S --- SEWER SERVICE STATION FROM MANHOLE
- W --- PROPOSED WATERMAIN, FIREHYDRANT, VALVE
- S --- SEWER CONCRETE ENCASEMENT AT WATERMAIN CROSSINGS(SEE DETAIL SHEET)
- S --- FLOWMILL CAP OVER SEWER, 12" MIN. LIFT

GENERAL NOTES

1. All sewerline construction shall conform to Fruitvale Sanitation District's standards and specifications.
2. All materials and workmanship shall be subject to inspection by the District. The District reserves the right to accept or reject any materials and workmanship that does not conform to its standards and specifications.
3. The Contractor shall have one signed copy of the Plans and a copy of the District's Standards and Specifications at the job site at all times.
4. All sanitary sewer pipe shall be PVC SDR-35 unless otherwise specified. All pipe joints shall be 13 foot joints unless otherwise approved by the District Engineer.
5. All sewer mains shall be laid to grade utilizing a pipe laser.
6. All service line connections to the new main shall be accomplished with full body wyes or tees. Tapping saddles will not be allowed.
7. All trenches shall be compacted to 95% as determined by AASHTO T-99. Contractor shall be required to perform all necessary compaction tests through a certified soils lab.
8. A minimum 10-foot separation shall be maintained at all times between waterlines and sewer lines(except at specified crossings).
9. All sanitary sewer services to be 4" PVC SDR-35 unless otherwise specified.
10. The Contractor shall notify the District at least 48 hours prior to commencement of construction.
11. Manholes and concrete encasements shall be constructed as shown on the Fruitvale Sanitation District Standard Sanitary Sewer Detail sheet.
12. No service lines shall be connected directly into manholes.
13. The Contractor is responsible for all required sewer line testing to be completed in the presence of the District Engineer or their representative. Final testing is to be accomplished only after all other infrastructure has been installed. This includes waterlines, gas lines, electric lines, etc. Testing will be performed after all compaction of street subgrade and prior to street paving. Final lamping will also be accomplished after paving is completed to insure that the line is clean. These tests will be the basis for issuing Initial Acceptance of the sewer line extension.
14. Manholes constructed outside the street right-of-way shall be constructed so that the finish rim elevation is a minimum of 2 inches above surrounding ground.
15. Where center invert elevations are called out the pipe is to run through the manholes with the top half of pipe cut out to the springline to provide the invert channel in the manhole. The invert pipe shall also be notched to provide for the invert channels at the service branches. Pipe shall be adequately braced to avoid sagging. The grade of the sewer line shall be maintained through the manhole.

CONSTRUCTION DRAWING OF RECORD

ENGINEER'S STATEMENT

Banner Associates, Inc., provides this Construction Drawing of Record based on surveying information, by D.H. Survey, collected after installation of improvements. Banner Associates, Inc., only provided periodic inspection of the improvements as shown on this plan, and that to the best of our knowledge it conforms to the Fruitvale Sanitation District Standards and Specifications.

Banner Associates, Inc. _____ Date _____

NW 1/16 COR. SECTION 18 BENCHMARK ELEV.=4610.03
 N 9143.5300
 E 9961.2700

EXTEND EXISTING 8" PVC PIPE TO SANITARY SEWER MANHOLE MH-A1 BY USE OF LASER SET IN LAST MANHOLE WITHIN NIAGARA SUBDIVISION TO ASSURE PROPER GRADE AND ALIGNMENT.

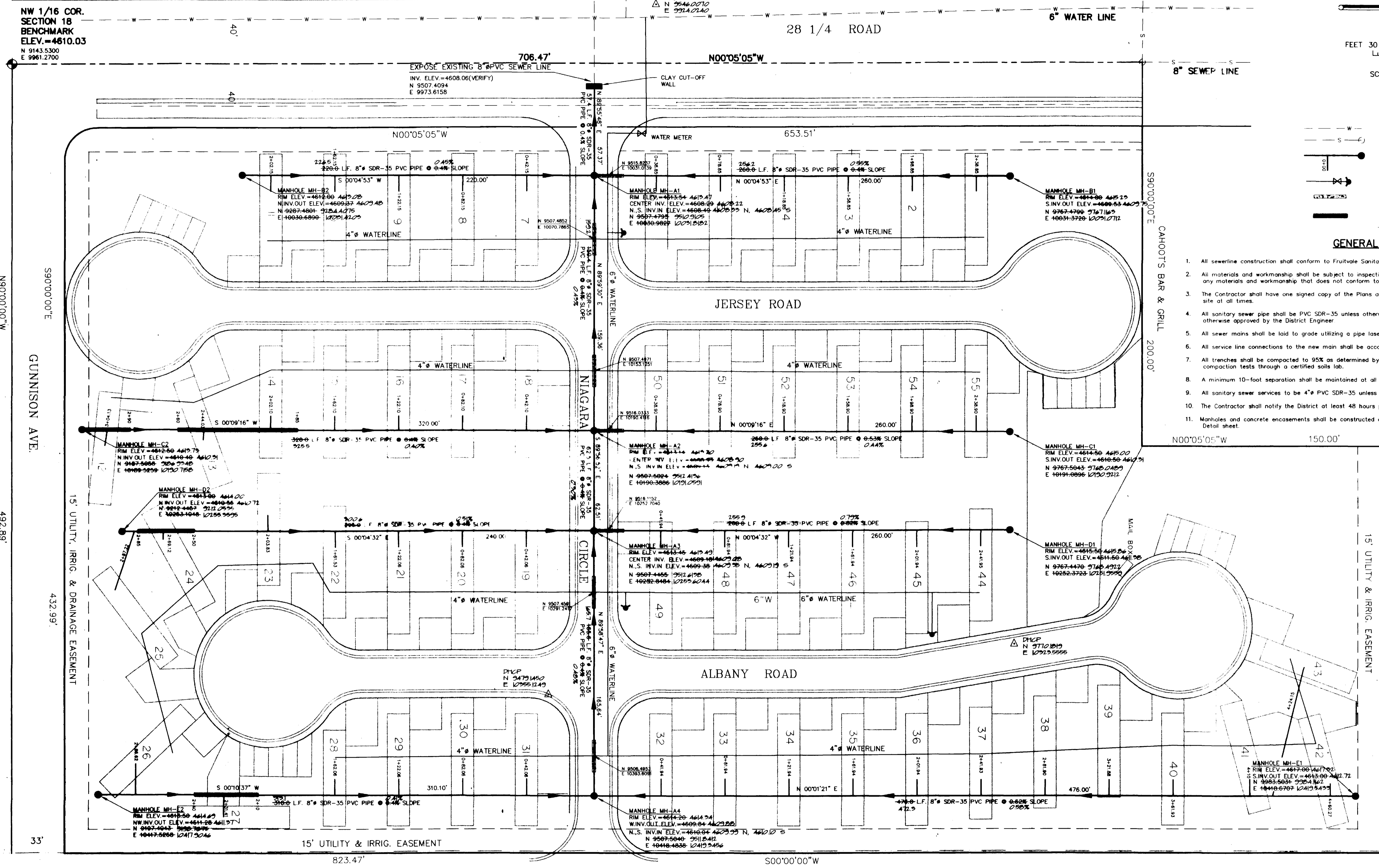

A & W TRAILER PARK

DESIGNED BY: BKR	REVIEWED DATE: _____ FOR _____
CHECKED BY: DEC	REVIEWED DATE: _____ FOR BANNER ASSOCIATES, INC.

AMERICAN CONSULTING ENGINEERS COUNCIL OF COLORADO

BANNER

BANNER ASSOCIATES, INC. • CONSULTING ENGINEERS & SURVEYORS
 2777 CROSSROADS BOULEVARD • GRAND JUNCTION, CO 81506 • (970) 243-2242
 605 E. MAIN • SUITE 6 • ASPEN, CO 81611 • (970) 925-5657

REVISION	DATE	DESCRIPTION	BY	CHK'D
1	2-08-09	CONSTRUCTION DRAWING OF RECORD	FJD	DEC

SONSHINE CONSTRUCTION, LLC	GRAND JUNCTION, COLORADO	SCALE: 1" = 30'	JOB NO: 8324-37	DATE: 10-08-96
SANITARY SEWER PLAN		SHEET NO: 1 of 1		
JAMES PARK SUBDIVISION				