

# SCHOOL DISTRICT 51

PLANS FOR  
CONSTRUCTION  
OF

# APPLETON SEWER LINE EXTENSION

MARCH 23, 1998

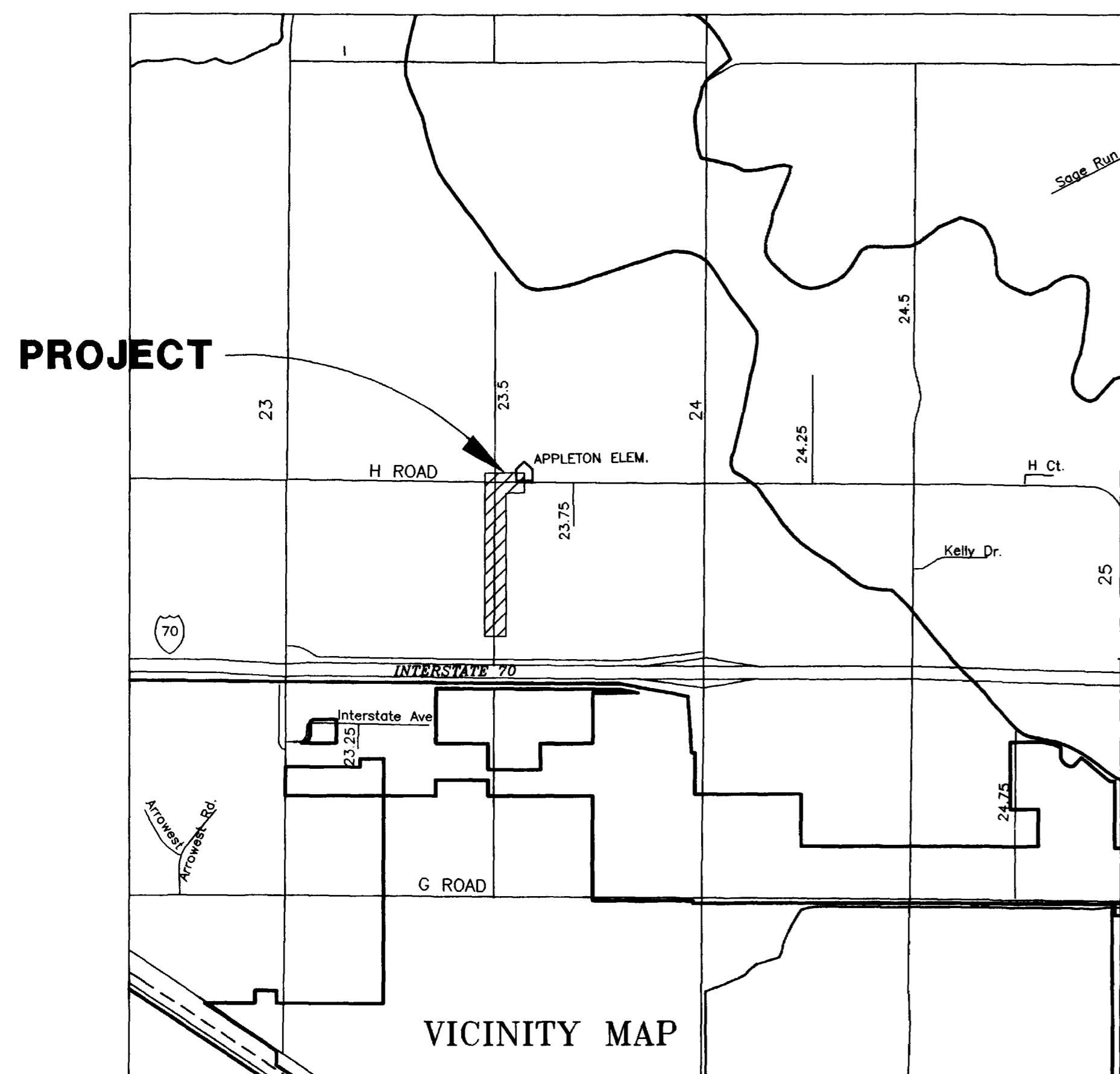

NO.	TITLE
SHEET 1 OF 9	COVER
SHEET 2 OF 9	GENERAL LEGEND AND CONSTRUCTION NOTES
SHEET 3 OF 9	SANITARY SEWER LINE-A (SHEET 3 OF 9)
SHEET 4 OF 9	SANITARY SEWER LINE-A (SHEET 4 OF 9)
SHEET 5 OF 9	SANITARY SEWER LINE-A (SHEET 5 OF 9)
SHEET 6 OF 9	SANITARY SEWER LINE-A (SHEET 6 OF 9)
SHEET 7 OF 9	SANITARY SEWER LINE-A (SHEET 7 OF 9)
SHEET 8 OF 9	SANITARY SEWER LINE-B (SHEET 8 OF 9)
SHEET 9 OF 9	SANITARY SEWER LINE-C (SHEET 9 OF 9)
SHEET 9A OF 9	EXHIBIT "I" SANITARY SEWER DETAILS

THOMPSON-LANGFORD CORP.  
529 25 1/2 RD., SUITE B210  
GRAND JUNCTION, COLORADO  
PH. (970) 243-6067

JOB NO. 0031-012

APPROVED FOR CONSTRUCTION
MESA COUNTY
Date
ACCEPTED AS CONSTRUCTED
MESA COUNTY
Date
APPROVED FOR CONSTRUCTION
CITY OF GRAND JUNCTION
Date
ACCEPTED AS CONSTRUCTED
CITY OF GRAND JUNCTION
Date

**LEGEND**

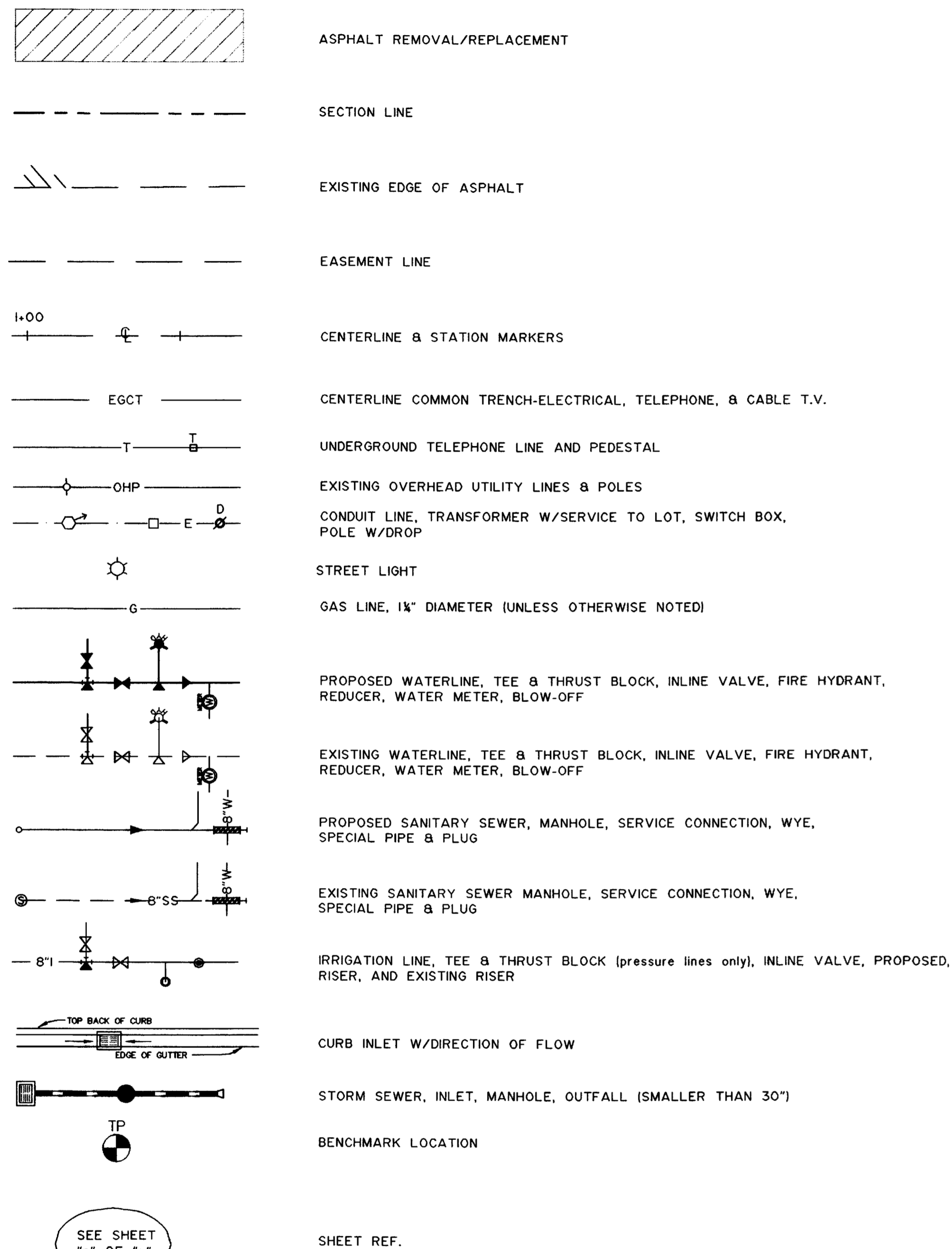

**GENERAL CONSTRUCTION NOTES**

- Locations of existing utilities shown on these plans are approximate only. Contractor is to contact affected utility for specific locations before digging.
- All satisfactory excess excavation from either utility or street construction shall be spread uniformly as directed by the owner or his or her designated representative. All unsatisfactory or waste material including vegetation, roots, concrete, rocks, or other debris, shall be hauled from the project by the Contractor. No separate pay.
- Contractor shall give 48 hour notice to all authorized inspectors, superintendents, or persons in charge of public and private utilities affected by his operations prior to commencement of work. Contractor shall assure himself that all construction permits have been obtained prior to commencement of work. All permits obtainable by the Contractor shall be obtained at the Contractor's expense.
- Contractor shall confine his construction operations to the rights-of-way, easements, and lots, as shown on Plans and Plat. Any damage to private facilities outside these limits shall be repaired by the Contractor at no expense to the Owner.
- All road construction, and related work, all materials, performance and quality of work, shall conform to the requirements of the Mesa County Standard Specifications and the applicable sections of the most current edition of the Division of Highways, State of Colorado Standard Specifications for Road and Bridge Construction, Colorado Standard Plans, Division of Highways M & S Standards.
- Sewer Lines are to be constructed in accordance with the technical specifications of the City of Grand Junction. Sewer lines must be tested and approved before paving.
- Water lines are to be constructed in accordance with the technical specifications of the Ute Water Conservancy District. Water lines must be tested and approved before paving.
- Contractor shall familiarize himself with the geotechnical testing requirements of Mesa county. The results of the required types of tests and numbers of passing tests shall be furnished to the Engineer for verification before final acceptance by the Owner will be granted. All failing tests shall be brought to the immediate attention of the Engineer and retests shall be performed until passing results are obtained. All utility lines, including service lines falling within Public rights-of-way or Public easements shall be tested.
- Only materials on which a proctor test can be performed and accurate nuclear density tests can be run are approved for utility trench backfill unless otherwise approved by the Engineer.

**SANITARY SEWER CONSTRUCTION NOTES**

- The Contractor shall obtain Mesa County and Colorado Department of Transportation underground utility permits for all work within existing County/State Right-of-way prior to construction.
- Service connections to manholes will not be permitted. The terminus of the services shall be located at the roadway centerline stationing shown on the Sanitary Sewer Plan and Profile sheets.
- Manholes are to be constructed in accordance with the typical details. Care shall be taken in forming the inverts, cones or slabs are to be rotated such that openings are aligned as nearly as possible with the inlets. There are to be no steps inside the manholes. Manhole inlets are to be adjusted to grade using pre-cast concrete grade rings or grout placed under the rim. Cast iron grade rings are not to be used. Include cost for adjusting manholes to final grade in unit bid price for manholes.
- Water stop gaskets and clamp assemblies are to be furnished and installed at all connections to manholes. No separate pay.
- Where sanitary sewers cross under waterline with less than 2-feet of vertical separation, and in all cases where the sanitary sewer crosses over the waterline at any depth, provide a 20-foot concrete encasement. Where sewer crosses over the waterline, the encasements are to be encased per City of Grand Junction Standard Details.
- Sanitary sewer lines are to be tested in accordance with current City of Grand Junction technical specifications. Contractor to furnish all materials and equipment and is responsible for all required sewer line testing in the presence of the City Inspector. Pressure testing will be performed after all compaction of street sub-grade and prior to street paving. Final lapping will be done after paving is completed. These tests shall be the basis of acceptance of the sewer line extension. Include cost in unit price bid for sanitary sewer lines.
- All materials and workmanship shall be subject to inspection by the City of Grand Junction. The City of Grand Junction reserves the right to accept or reject any materials or workmanship that does not conform to their standards and specifications.
- The contractor shall notify the City Inspection 48 hours prior to commencement of construction.
- The Contractor shall have one signed copy of the Plans and a copy of the City of Grand Junction standard Specifications at the job site at all times.
- Sewer service stub-outs shall extend 14 ft. beyond the property line, glue capped and marked with a steel fence post buried 1' below finished grade. As-built surveying required PRIOR to backfill.
- All sanitary sewer pipe to be PVC SDR 35 (ASTM 3034) unless otherwise specified.
- All sewer mains to be constructed to grade utilizing a pipe laser.
- All service line connections to the new main shall be accomplished with full body wyes or tees. Tapping saddles will not be allowed.
- A minimum of 10 ft. of separation shall be maintained at all times between the waterline and sewer line except at specified crossings.
- Only materials on which a proctor test can be performed and accurate nuclear density tests can be run are approved for sewer trench backfill unless otherwise approved by the Engineer.
- A clay cut-off wall shall be placed 10 feet upstream from all new manholes unless otherwise noted. The cut-off wall shall extend from 6 inches below to 6 inches above granular backfill material and shall be 2 feet wide. If native material is not suitable, the contractor shall import material approved by the engineer.

**PAVING CONSTRUCTION NOTES**

- All road widths, and radii are to face of curb or flowline unless noted otherwise. Any "spot" design elevations are to flowline of curb and gutter unless otherwise noted.
- TC = top of curb elevation  
BOW = back of sidewalk  
EOA = edge of asphalt elevation  
RIM = rim of manhole  
INV = invert elev. of manhole or inlet  
CL = centerline  
PL = property line  
FL = flowline  
EI = elevation
- The top 6" of existing ground or the top 6" of areas cut to final grade are to be scarified, moistened and recompacted to 95% of AASHTO T99 to a depth of 6" before starting up with embankments or before base is placed.
- Contractor to protect existing utilities and appurtenances. Manholes, drainage inlets, utility lines, etc., damaged, covered or filled with dirt or debris by the Contractor shall be cleaned and repaired at no expense to the Owner.
- Aggregate base course must be compacted 95% AASHTO T-180.
- Hot-mix asphaltic concrete to be CDOT Grading C. A mix design for the proposed pit must be approved by Engineer prior to placement of pavement.
- Where proposed pavement is to match existing pavement, existing pavement is to be square cut, full base thickness is to be brought to match line and existing surface is to be tack-coated before proposed surface is placed.
- Handicap ramps are to be constructed where indicated on the plans and in accordance with current City of Grand Junction Standard Details.
- Curb, gutter and drainage pans are to have expansion joints at each change in horizontal alignment of curb and gutter, but in no case at a greater distance apart than 100 feet. Locate dummy grooved joints between expansion joints at intervals not exceeding 10 feet.
- Include backing of curb and Gutter and or sidewalk with native fill material per the typical roadway section in the unit price bid for embankment.

**WATERLINE CONSTRUCTION**

- Ute water must have a signed copy of the Improvement Plans 48 hours prior to the commencement of construction.
- Water mains, services and other appurtenances are to be constructed in accordance with Ute Water Conservancy District details and technical specifications. Include cost for adjusting water valves to final pavement grade in unit bid price for gate valves and box's.
- All water mains to be C-900, Class 150.
- All waterlines to have a minimum cover of 54-inches.
- All pipe bends/angle points, both horizontal and vertical, as called for on the plans are to be thrust blocked per Ute Water Conservancy District details and Technical Specifications.
- Water services are to be extended 14' beyond the property line, capped and marked with a 2x4 post painted blue.
- Developer is responsible for installing meter pits and yokes at the time of construction. Ute Water will furnish the pits and yokes.
- Waterlines, Pipe Fittings, Valves, and Services are to be installed, tested, and disinfected in accordance with current Ute Water Conservancy District technical specifications. Contractor is to furnish all materials and equipment. Include cost in unit price bid for waterlines.
- Only materials on which a proctor test can be performed and accurate nuclear density tests can be run are approved for waterline trench backfill unless otherwise approved by the Engineer.
- Take care when installing water service lines where lot lines are not perpendicular to the right-of-way. Deflect service lines as shown or meter installations may fall on adjacent lots.
- The policies and fees of the Ute Water Conservancy District in effect at the time of application will apply to this property.

APPROVED FOR CONSTRUCTION	ACCEPTED AS CONSTRUCTED
MESA COUNTY ENGINEERING DATE	MESA COUNTY ENGINEERING DATE
APPROVED FOR CONSTRUCTION	APPROVED AS CONSTRUCTED
CITY OF GRAND JUNCTION ENGINEERING DATE	CITY OF GRAND JUNCTION ENGINEERING DATE

DRAWN BY:	REVIEWED _____
DESIGNED BY:	DATE: _____ FOR _____
CHECKED BY:	REVIEWED _____
DAT	DATE: _____

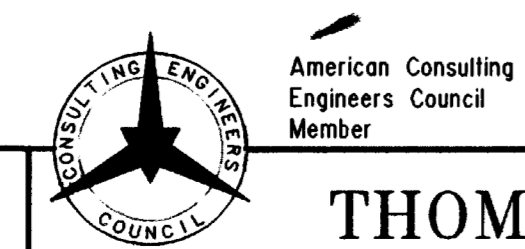

**THOMPSON-LANGFORD CORP.**  
529 25 1/2 RD., SUITE B210  
GRAND JUNCTION, COLORADO  
PH. (970) 243-6067

REVISION	DATE	DESCRIPTION	BY	CHKD

SCHOOL DISTRICT 51	MESA COUNTY, COLORADO	SCALE: N.T.S.	JOB NO: 0031-012	DATE: 3/23/98
<b>GENERAL LEGEND AND CONSTRUCTION NOTES</b>		2 of 9		

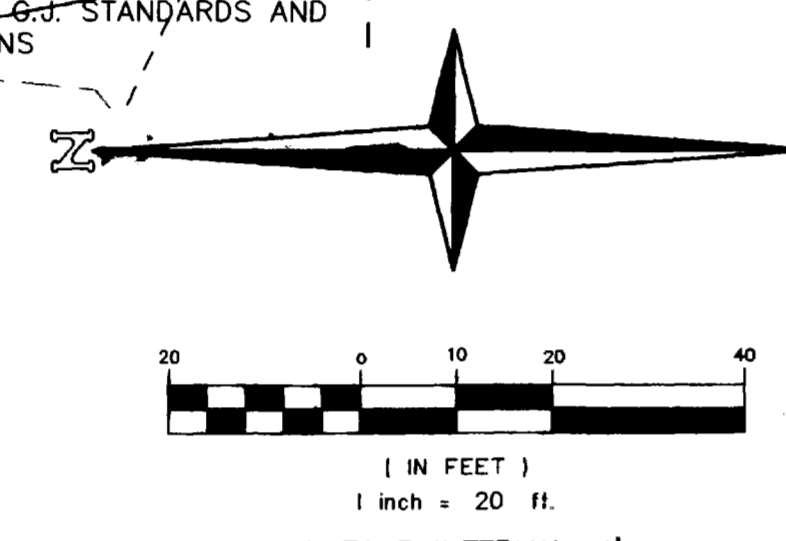
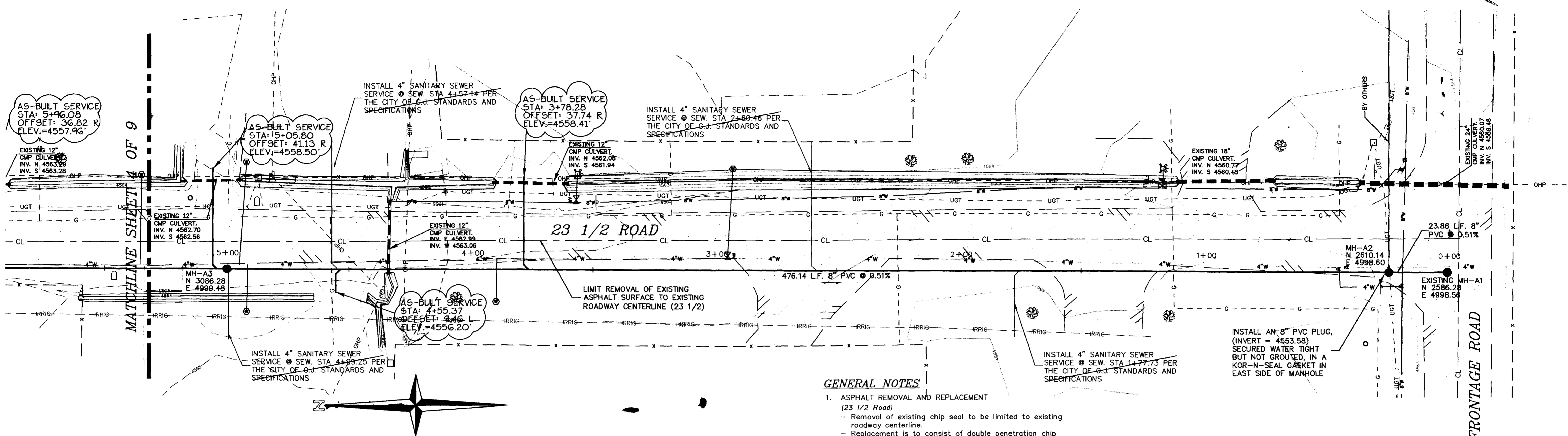

CALL UTILITY NOTIFICATION  
CENTER OF COLORADO  
**1-800-922-1987**  
OR **534-6700** IN METRO DENVER  
CALL 2 BUSINESS DAYS IN ADVANCE BEFORE YOU DIG, GRADE, OR EXCAVATE FOR THE MARKING OF UNDERGROUND MEMBER UTILITIES.

- GENERAL NOTES**
- ASPHALT REMOVAL AND REPLACEMENT (23 1/2 Road)
    - Removal of existing chip seal to be limited to existing roadway centerline.
    - Replacement is to consist of double penetration chip seal across entire roadway width.
    - One-way traffic is to be maintained during construction. A traffic control plan is to be submitted prior to construction.
  - (H Road)
    - Remove asphalt either side of centerline, as required for construction.
    - Replacement (patch) 3" HBP/6" class 6 to existing asphalt grade, then overlay entire roadway section with 1 1/2" HBP.
    - Traffic control plan is to be submitted prior to construction.
  - SEWER STUB-OUT (TAP) LOCATIONS ARE APPROXIMATE ONLY. CONTRACTOR SHALL COORDINATE WITH PROPERTY OWNER TO DETERMINE DESIRED TAP LOCATION.
  - ENDS OF SEWER SERVICE STUBS ARE NOT TO BE BACK FILLED UNTIL "AS-BUILT" HORIZONTALLY AND VERTICALLY BY SURVEYORS.
  - THE EXISTING 4" WATER LINE ON THE WEST SIDE OF H ROAD WILL BE ABANDONED PRIOR TO CONSTRUCTION OF SEWER LINE.

REVISED TO "AS-BUILT" CONDITIONS ON 7/31/98

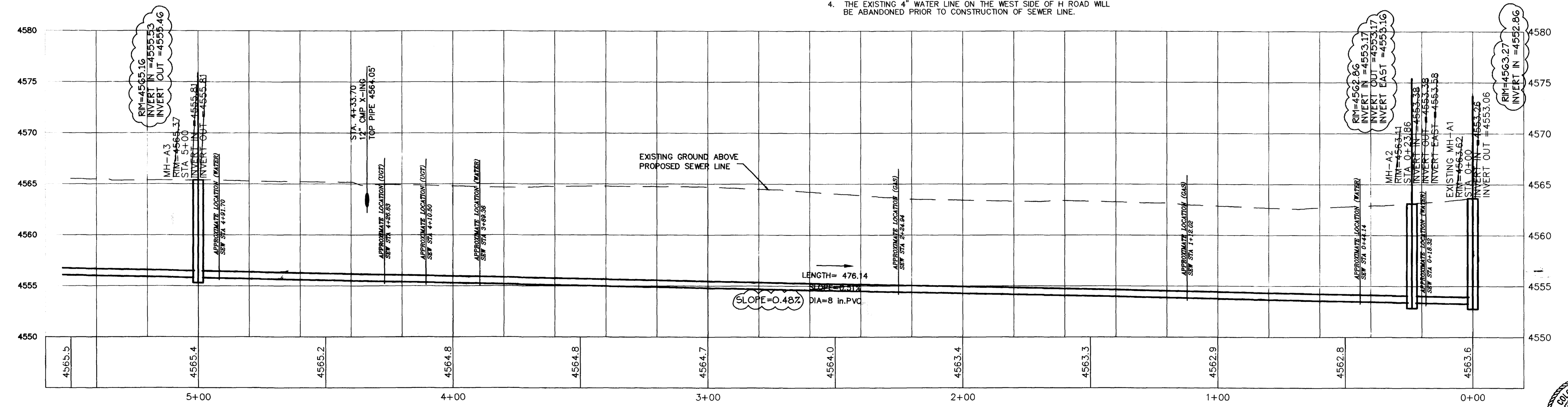

SANITARY SEWER LINE-A



American Consulting Engineers Council Member  
**THOMPSON-LANGFORD CORP.**  
529 25 1/2 RD., SUITE B210  
GRAND JUNCTION, COLORADO  
PH. (970) 243-6067

REVISION	DATE	DESCRIPTION	BY	CHK'D

SCHOOL DISTRICT 51  
GRAND JUNCTION  
SCALE: Horiz: 1" = 20'  
Vert: 1" = 5'  
DATE: 3/23/98  
SHEET NO: 3 OF 9

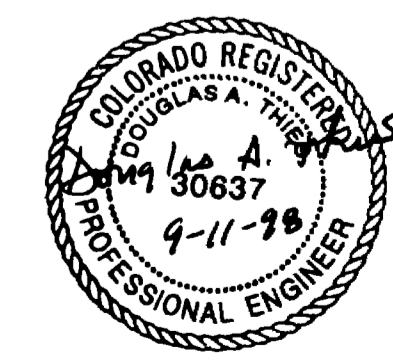

DRAWN BY: MWT  
PREPARED UNDER THE SUPERVISION OF DOUGLAS A THIES P.E. NO. 30637  
CHECKED BY: DAT  
REVIEWED: \_\_\_\_\_  
DATE: \_\_\_\_\_

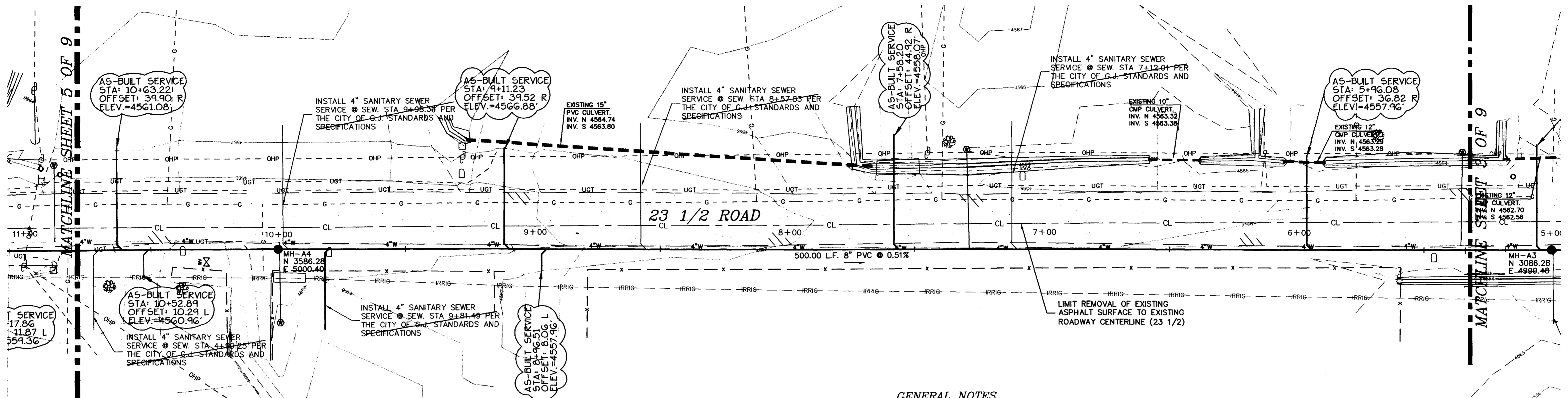

( IN FEET )  
1 inch = 20 ft.  
CONTOUR INTERVAL: 1'

PROJECT BENCHMARK:  
MCSM AT THE INTERSECTION OF 23 1/2 ROAD  
AND H ROAD.  
ELEVATION 4574.82

CALL UTILITY NOTIFICATION  
CENTER OF COLORADO  
**1-800-922-1987**  
OR **534-6700** IN METRO  
DENVER  
CALL 2 BUSINESS DAYS IN ADVANCE  
BEFORE YOU DIG, GRADE, OR EXCAVATE  
FOR THE MARKING OF UNDERGROUND  
MEMBER UTILITIES.

**GENERAL NOTES**

- ASPHALT REMOVAL AND REPLACEMENT  
(23 1/2 Road)  
- Removal of existing chip seal to be limited to existing roadway centerline.  
- Replacement is to consist of double penetration chip seal across entire roadway width.  
- One-way traffic is to be maintained during construction. A traffic control plan is to be submitted prior to construction.  
(H Road)  
- Remove asphalt either side of centerline, as required for construction.  
- Replacement (patch) 3" HBP/6" class 6 to existing asphalt grade, then overlay entire roadway section with 1 1/2" HBP.  
- Traffic control plan is to be submitted prior to construction.
- SEWER STUB-OUT (TAP) LOCATIONS ARE APPROXIMATE ONLY. CONTRACTOR SHALL COORDINATE WITH PROPERTY OWNER TO DETERMINE DESIRED TAP LOCATION.
- ENDS OF SEWER SERVICE STUBS ARE NOT TO BE BACK FILLED UNTIL "AS-BUILT" HORIZONTALLY AND VERTICALLY BY SURVEYORS.
- THE EXISTING 4" WATER LINE ON THE WEST SIDE OF H ROAD WILL BE ABANDONED PRIOR TO CONSTRUCTION OF SEWER LINE.

REVISED TO "AS-BUILT"  
CONDITIONS ON 7/31/98

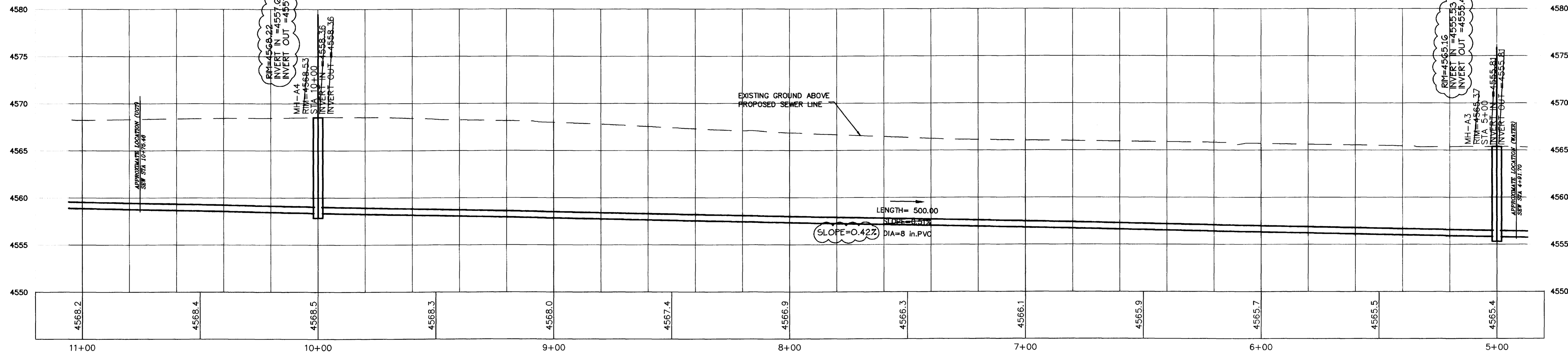
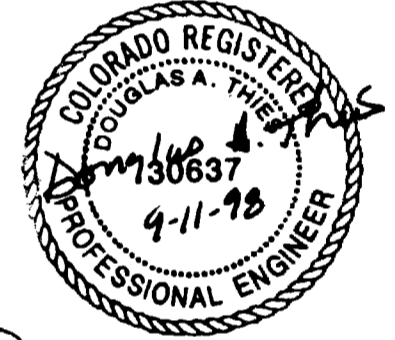

**SANITARY SEWER LINE-A**



American Consulting  
Engineers Council  
Member  
**THOMPSON-LANGFORD CORP.**  
529 25 1/2 RD., SUITE B210  
GRAND JUNCTION, COLORADO  
PH. (970) 243-6067

DRAWN BY: MWT	PREPARED UNDER THE SUPERVISION OF DOUGLAS A THIES P.E. NO. 30637
CHECKED BY: DAT	REVIEWED DATE:

REVISION	DATE	DESCRIPTION	BY	CHD

SCHOOL DISTRICT 5I	GRAND JUNCTION	SCALE: Horiz: 1" = 20' Vert: 1" = 5'	Project No: 0031-012
SANITARY SEWER LINE-A (SHEET 4 OF 9)		DATE: 3/23/98	SHEET NO: 4 OF 9

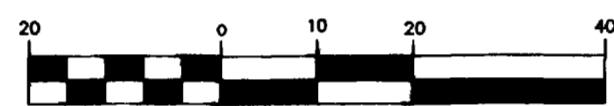
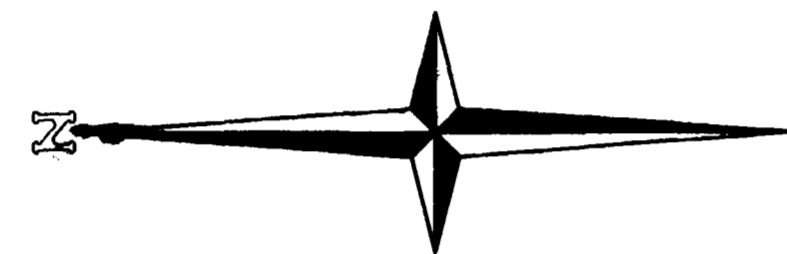
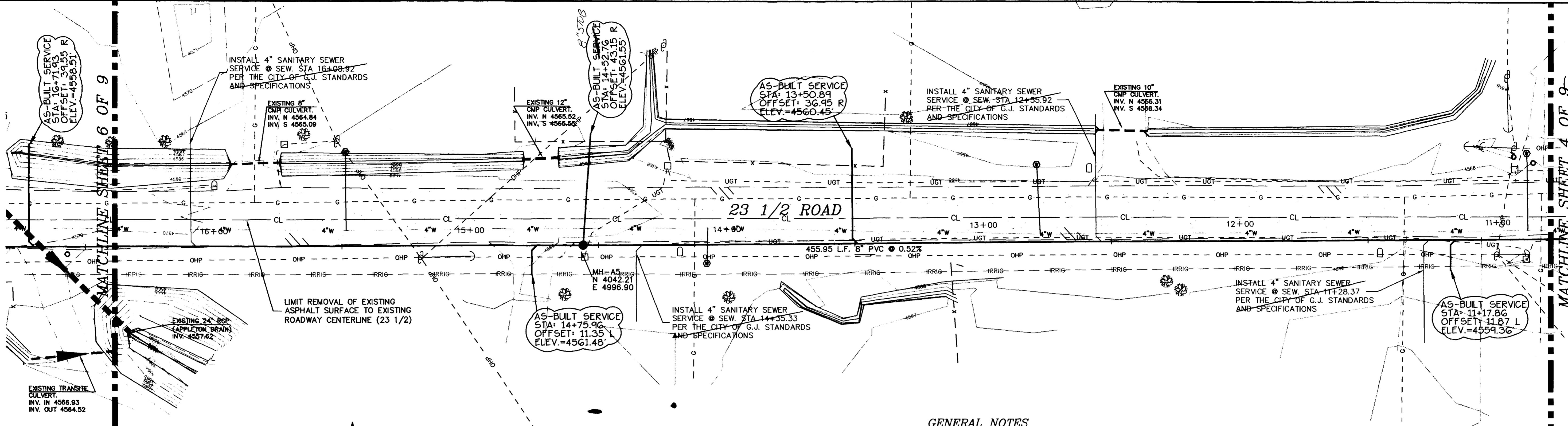

1 IN FEET  
1 inch = 20 ft.  
CONTOUR INTERVAL: 1'

PROJECT BENCHMARK:  
MCSM AT THE INTERSECTION OF 23 1/2 ROAD  
AND H ROAD.  
ELEVATION 4574.82

CALL UTILITY NOTIFICATION  
CENTER OF COLORADO  
**1-800-922-1987**

OR **534-6700** IN METRO DENVER

CALL 2 BUSINESS DAYS IN ADVANCE  
BEFORE YOU DIG, GRADE, OR EXCAVATE  
FOR THE MARKING OF UNDERGROUND  
MEMBER UTILITIES.

**GENERAL NOTES**

- ASPHALT REMOVAL AND REPLACEMENT (23 1/2 Road)
  - Removal of existing chip seal to be limited to existing roadway centerline.
  - Replacement is to consist of double penetration chip seal across entire roadway width.
  - One-way traffic is to be maintained during construction. A traffic control plan is to be submitted prior to construction.
- (H Road)
  - Remove asphalt either side of centerline, as required for construction.
  - Replacement (patch) 3" HBP/6" class 6 to existing asphalt grade, then overlay entire roadway section with 1 1/2" HBP.
  - Traffic control plan is to be submitted prior to construction.
- ENDS OF SEWER SERVICE STUBS ARE NOT TO BE BACK FILLED UNTIL "AS-BUILT" HORIZONTALLY AND VERTICALLY BY SURVEYORS.
- THE EXISTING 4" WATER LINE ON THE WEST SIDE OF H ROAD WILL BE ABANDONED PRIOR TO CONSTRUCTION OF SEWER LINE.

REVISED TO "AS-BUILT" CONDITIONS ON 7/31/98

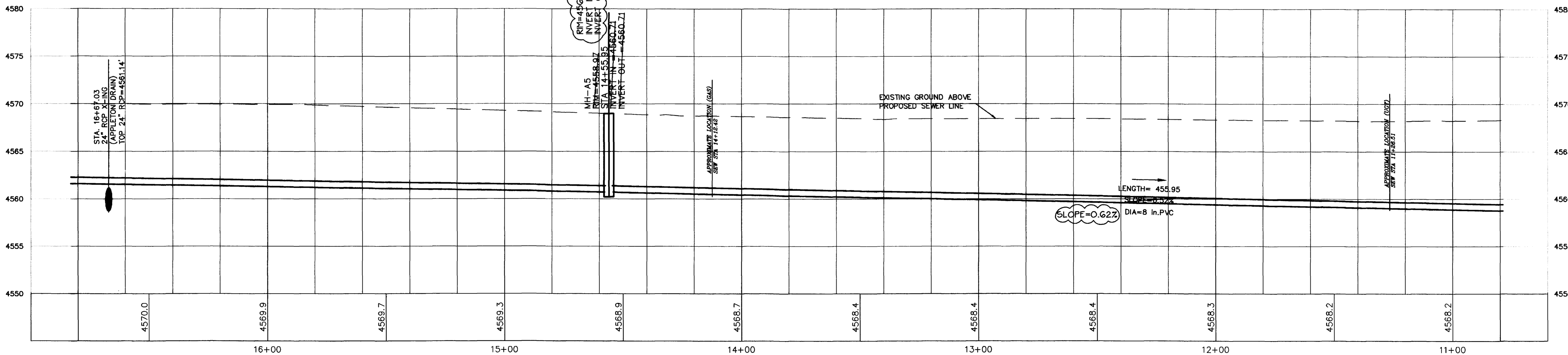

DRAWN BY: MWT	PREPARED UNDER THE SUPERVISION OF DOUGLAS A THIES P.E. NO. 30637
CHECKED BY: DAT	REVIEWED _____ DATE _____

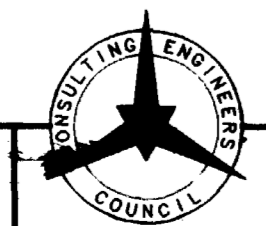

American Consulting Engineers Council Member  
**THOMPSON-LANGFORD CORP.**  
529-25 1/2 RD., SUITE B210  
GRAND JUNCTION, COLORADO  
PH. (970) 243-6067

REVISION	DATE	DESCRIPTION	BY	CHKD

SCHOOL DISTRICT 5I	GRAND JUNCTION	SCALE: Horiz: 1" = 20' Vert: 1" = 5'	Project No: 0031-012
SANITARY SEWER LINE-A (SHEET 5 OF 9)		DATE: 3/23/98	SHEET NO: 5 OF 9

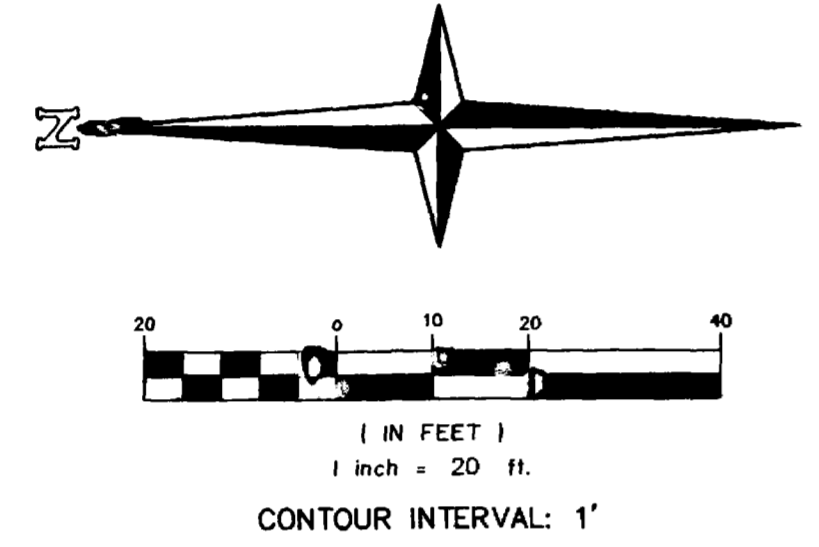
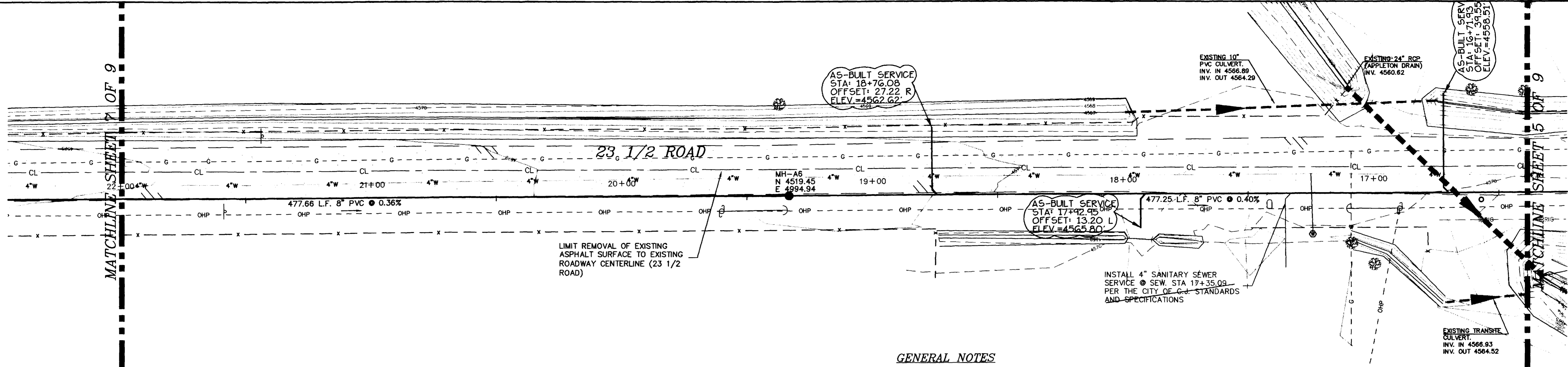

PROJECT BENCHMARK:  
MCSM AT THE INTERSECTION OF 23 1/2 ROAD  
AND H ROAD.  
ELEVATION 4574.82

CALL UTILITY NOTIFICATION  
CENTER OF COLORADO  
**1-800-922-1987**  
OR **534-5700** IN METRO DENVER  
CALL 2 BUSINESS DAYS IN ADVANCE  
BEFORE YOU DIG, GRADE, OR EXCAVATE  
FOR THE MARKING OF UNDERGROUND  
MEMBER UTILITIES.

**GENERAL NOTES**

- ASPHALT REMOVAL AND REPLACEMENT  
(23 1/2 Road)  
- Removal of existing chip seal to be limited to existing roadway centerline.  
- Replacement is to consist of double penetration chip seal across entire roadway width.  
- One-way traffic is to be maintained during construction. A traffic control plan is to be submitted prior to construction.  
(H Road)  
- Remove asphalt either side of centerline, as required for construction.  
- Replacement (patch) 3" HBP/6" class 6 to existing asphalt grade, then overlay entire roadway section with 1 1/2" HBP.  
- Traffic control plan is to be submitted prior to construction.
- SEWER STUB-OUT (TAP) LOCATIONS ARE APPROXIMATE ONLY. CONTRACTOR SHALL COORDINATE WITH PROPERTY OWNER TO DETERMINE DESIRED TAP LOCATION.
- ENDS OF SEWER SERVICE STUBS ARE NOT TO BE BACK FILLED UNTIL "AS-BUILT" HORIZONTALLY AND VERTICALLY BY SURVEYORS.
- THE EXISTING 4" WATER LINE ON THE WEST SIDE OF H ROAD WILL BE ABANDONED PRIOR TO CONSTRUCTION OF SEWER LINE.

REVISED TO 'AS-BUILT'  
CONDITIONS ON 7/31/98

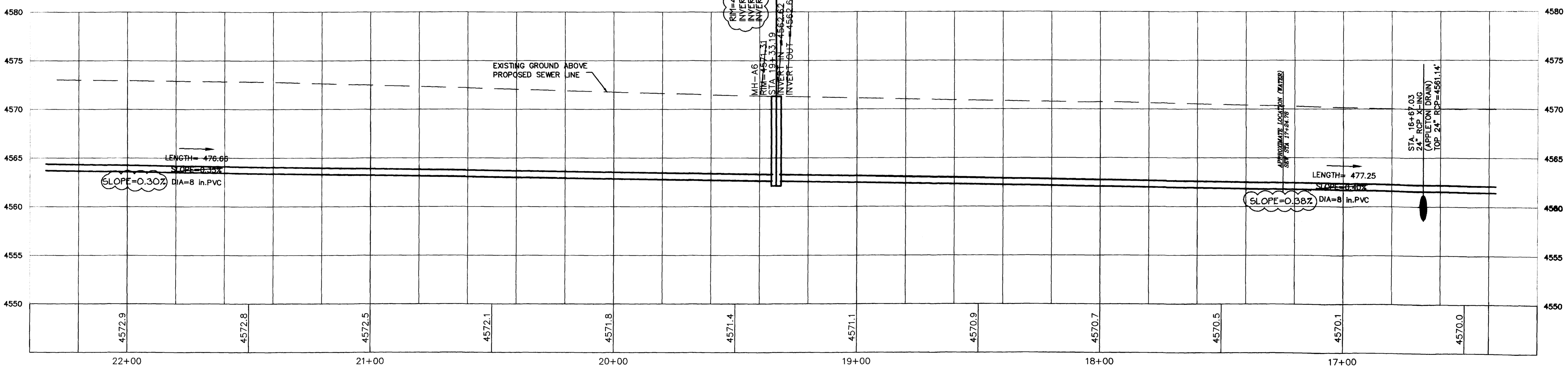
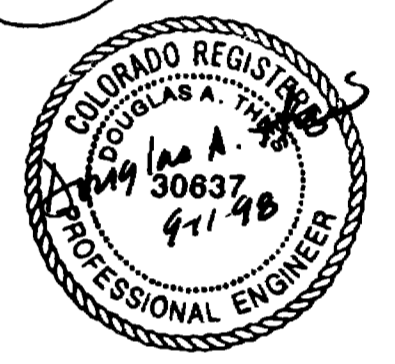

SANITARY SEWER LINE-A

DRAWN BY: MWT	PREPARED UNDER THE SUPERVISION OF DOUGLAS A THIES P.E. NO. 30637
CHECKED BY: DAT	REVIEWED _____ DATE: _____

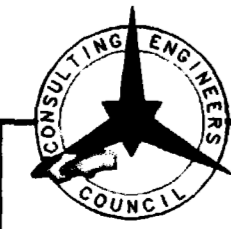

American Consulting  
Engineers Council  
Member  
**THOMPSON-LANGFORD CORP.**  
529 25 1/2 RD., SUITE B210  
GRAND JUNCTION, COLORADO  
PH. (970) 243-6067

REVISION	DATE	DESCRIPTION	BY	CHD

SCHOOL DISTRICT 51  
GRAND JUNCTION  
SANITARY SEWER LINE-A (SHEET 6 OF 9)

SCALE: Horiz: 1" = 20' Vert: 1" = 5'	Project No: 0031-012
DATE: 3/23/98	SHEET NO: 6 OF 9

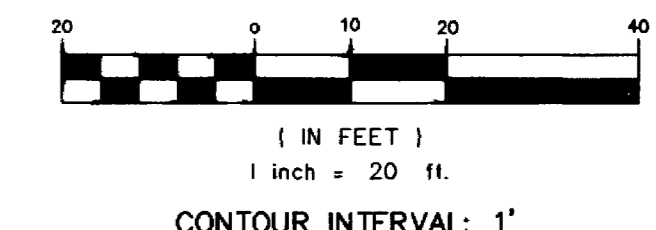
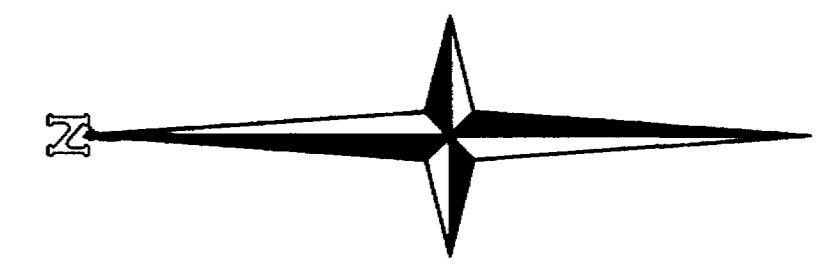
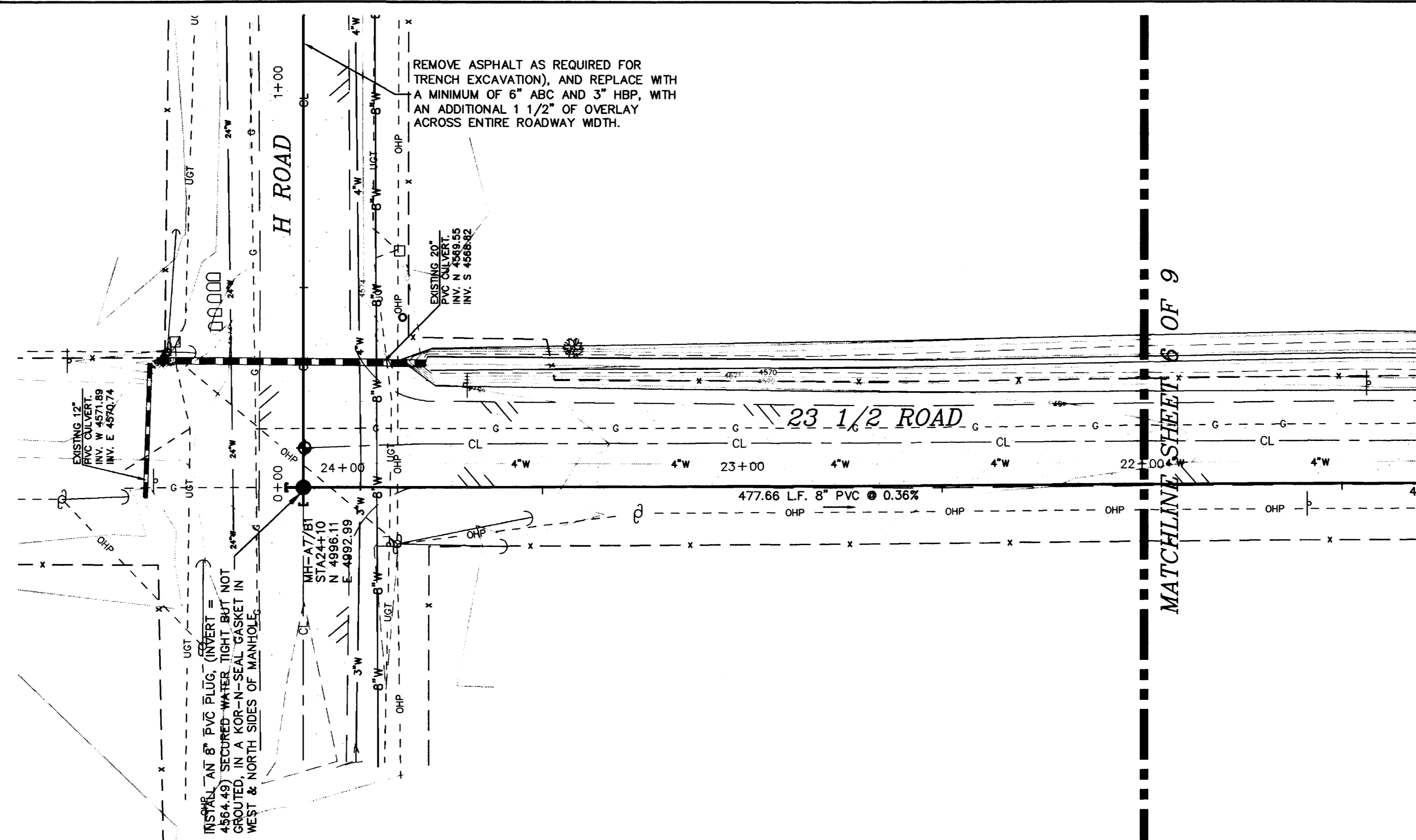

PROJECT BENCHMARK:  
MCSM AT THE INTERSECTION OF 23 1/2 ROAD  
AND H ROAD.  
ELEVATION 4574.82

CALL UTILITY NOTIFICATION  
CENTER OF COLORADO  
**1-800-922-1987**  
OR **534-6700** IN METRO DENVER  
CALL 2 BUSINESS DAYS IN ADVANCE  
BEFORE YOU DIG, GRADE, OR EXCAVATE  
FOR THE MARKING OF UNDERGROUND  
MEMBER UTILITIES.

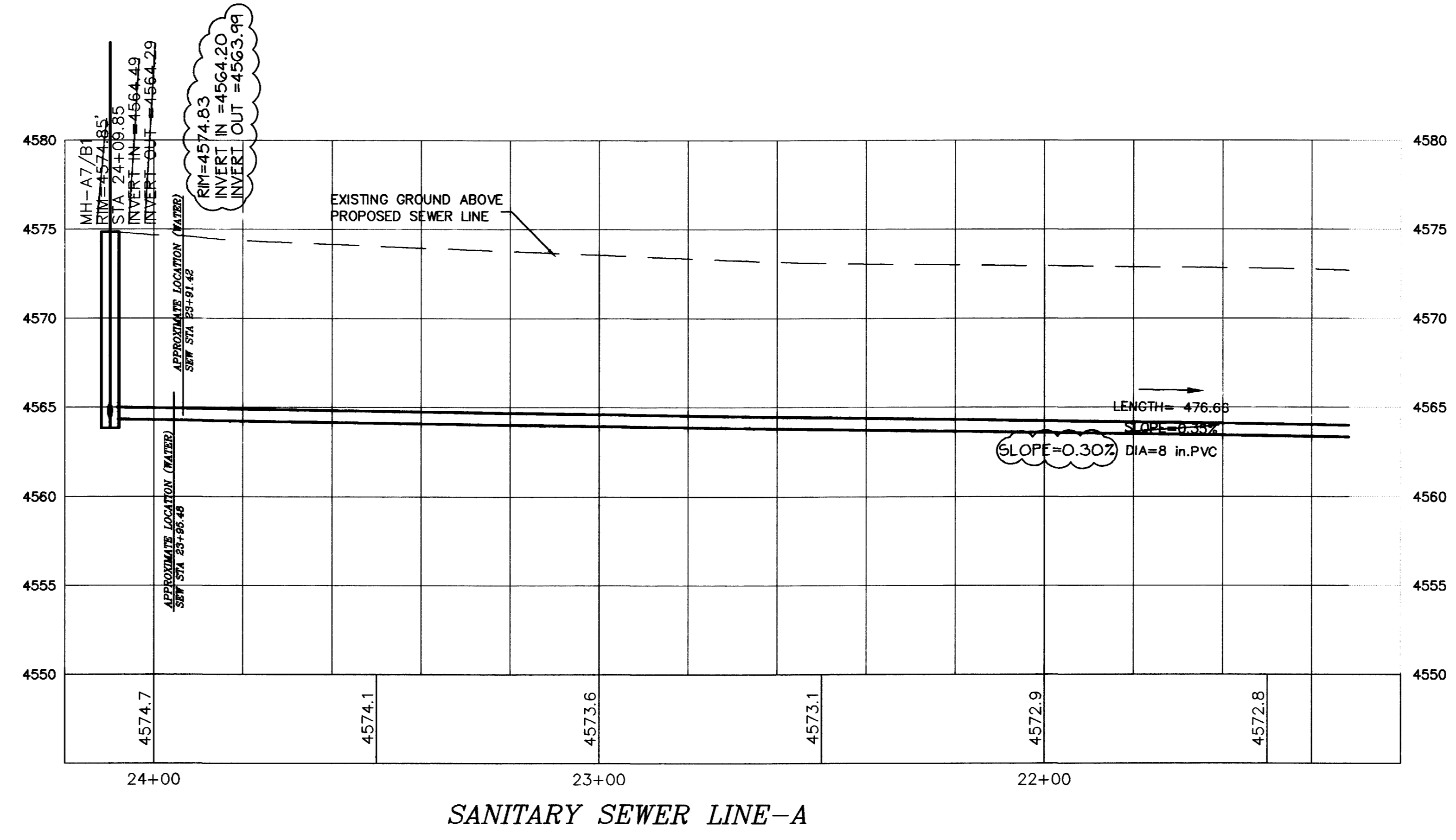

**GENERAL NOTES**

- ASPHALT REMOVAL AND REPLACEMENT  
(23 1/2 Road)  
- Removal of existing chip seal to be limited to existing roadway centerline.  
- Replacement is to consist of double penetration chip seal across entire roadway width.  
- One-way traffic is to be maintained during construction. A traffic control plan is to be submitted prior to construction.
- (H Road)  
- Remove asphalt either side of centerline, as required for construction.  
- Replacement (patch) 3" HBP/6" class 6 to existing asphalt grade, then overlay entire roadway section with 1 1/2" HBP.  
- Traffic control plan is to be submitted prior to construction.
- SEWER STUB-OUT (TAP) LOCATIONS ARE APPROXIMATE ONLY. CONTRACTOR SHALL COORDINATE WITH PROPERTY OWNER TO DETERMINE DESIRED TAP LOCATION.
- ENDS OF SEWER SERVICE STUBS ARE NOT TO BE BACK FILLED UNTIL "AS-BUILT" HORIZONTALLY AND VERTICALLY BY SURVEYORS.
- THE EXISTING 4" WATER LINE ON THE WEST SIDE OF H ROAD WILL BE ABANDONED PRIOR TO CONSTRUCTION OF SEWER LINE.

REVISED TO 'AS-BUILT'  
CONDITIONS ON 7/31/98

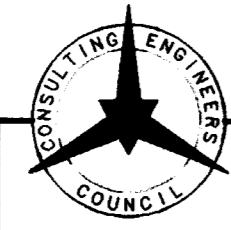
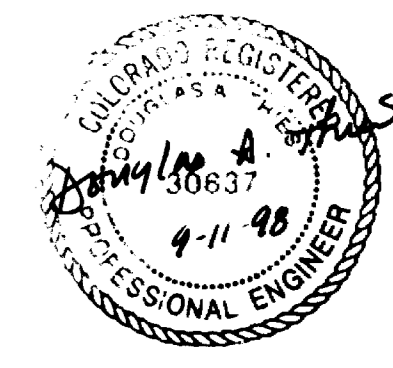

American Consulting  
Engineers Council  
Member  
**THOMPSON-LANGFORD CORP.**  
529 25 1/2 RD., SUITE B210  
GRAND JUNCTION, COLORADO  
PH. (970) 243-6067

DRAWN BY: MWT	PREPARED UNDER THE SUPERVISION OF DOUGLAS A THIES P.E. NO. 30637
CHECKED BY: DAT	REVIEWED _____ DATE: _____

REVISION	DATE	DESCRIPTION	BY	CHK'D

SCHOOL DISTRICT 51	GRAND JUNCTION	SCALE: Horiz: 1" = 20' Vert: 1" = 5'	Project No: 0031-012
SANITARY SEWER LINE-A (SHEET 7 OF 9)		DATE: 3/23/98	SHEET NO: 7 OF 9

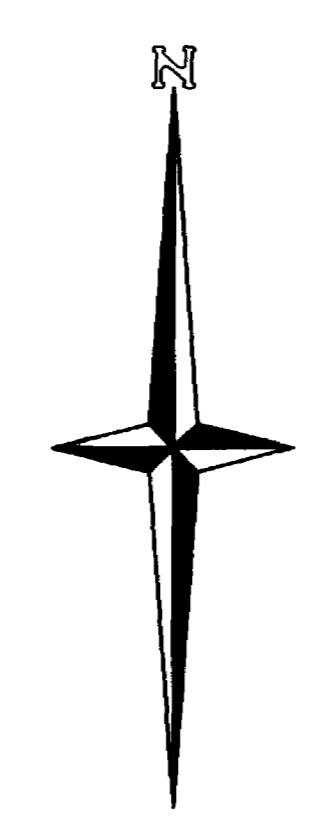
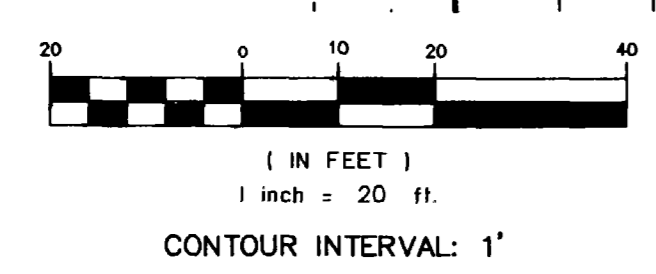
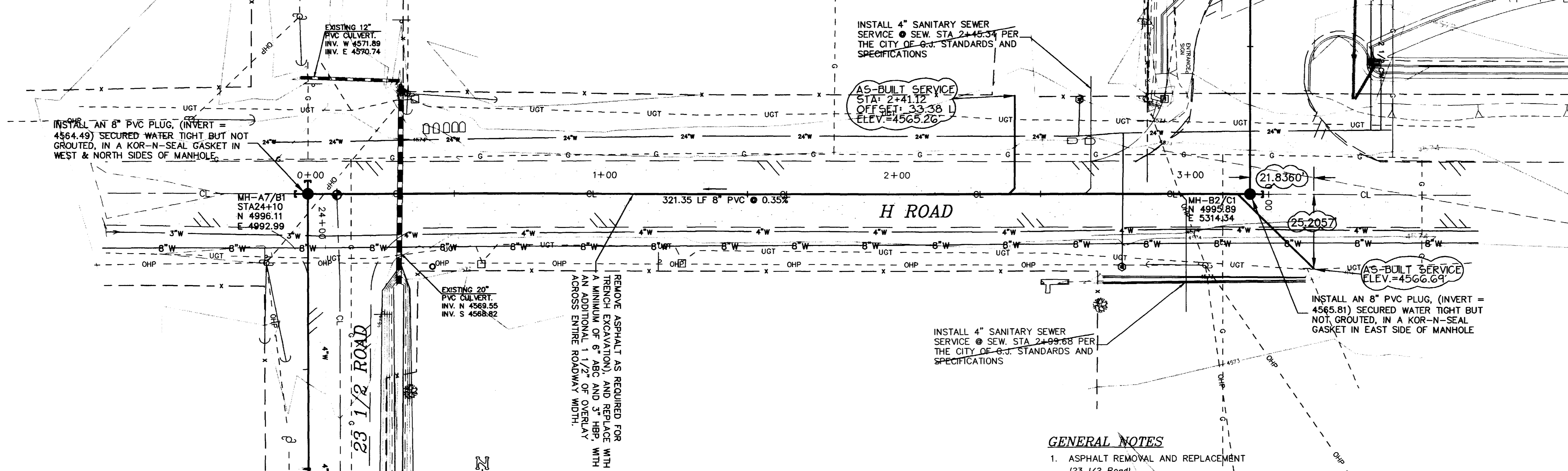

PROJECT BENCHMARK:  
MCSM AT THE INTERSECTION OF 23 1/2 ROAD  
AND H ROAD.  
ELEVATION 4574.82

CALL UTILITY NOTIFICATION  
CENTER OF COLORADO  
**1-800-922-1987**  
OR **534-6700** IN METRO DENVER  
CALL 2 BUSINESS DAYS IN ADVANCE  
BEFORE YOU DIG, GRADE, OR EXCAVATE  
FOR THE MARKING OF UNDERGROUND  
MEMBER UTILITIES.

**GENERAL NOTES**

- ASPHALT REMOVAL AND REPLACEMENT  
(23 1/2 Road)  
- Removal of existing chip seal to be limited to existing roadway centerline.  
- Replacement is to consist of double penetration chip seal across entire roadway width.  
- One-way traffic is to be maintained during construction. A traffic control plan is to be submitted prior to construction.
- (H Road)  
- Remove asphalt either side of centerline, as required for construction.  
- Replacement (patch) 3" HBP/6" class 6 to existing asphalt grade, then overlay entire roadway section with 1 1/2" HBP.  
- Traffic control plan is to be submitted prior to construction.
- SEWER STUB-OUT (TAP) LOCATIONS ARE APPROXIMATE ONLY. CONTRACTOR SHALL COORDINATE WITH PROPERTY OWNER TO DETERMINE DESIRED TAP LOCATION.
- ENDS OF SEWER SERVICE STUBS ARE NOT TO BE BACK FILLED UNTIL "AS-BUILT" HORIZONTALLY AND VERTICALLY BY SURVEYORS.
- THE EXISTING 4" WATER LINE ON THE WEST SIDE OF H ROAD WILL BE ABANDONED PRIOR TO CONSTRUCTION OF SEWER LINE.

REVISED TO "AS-BUILT"  
CONDITIONS ON 7/31/98

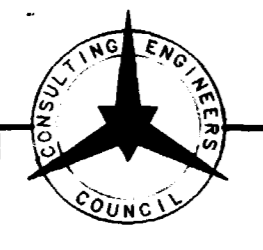
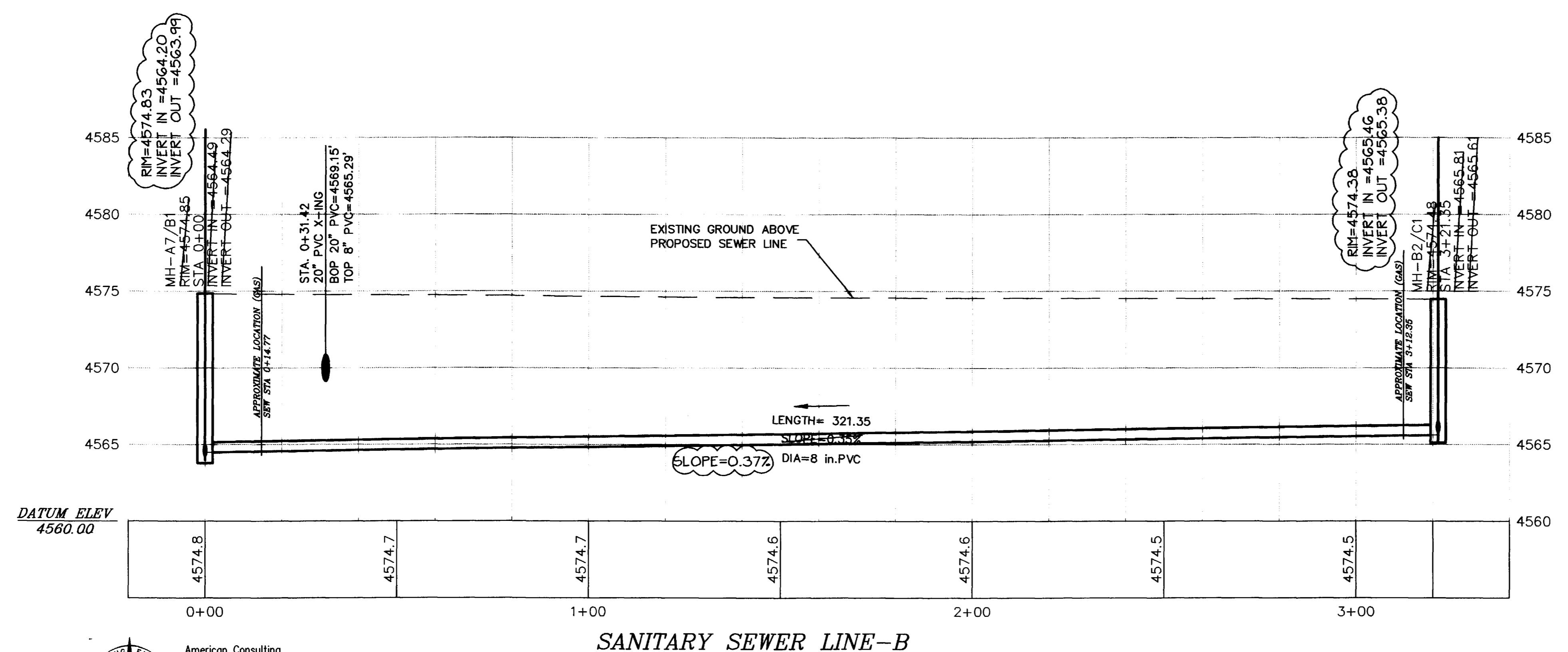

American Consulting  
Engineers Council  
Member  
**THOMPSON-LANGFORD CORP.**  
529 25 1/2 RD., SUITE B210  
GRAND JUNCTION, COLORADO  
PH. (970) 243-6067

REVISION	DATE	DESCRIPTION	BY	CHK'D

SCHOOL DISTRICT 51  
GRAND JUNCTION  
SANITARY SEWER LINE-B (SHEET 8 OF 9)

SCALE: Horiz: 1" = 20' Vert: 1" = 5'	Project No: 0031-012
DATE: 3/23/98	SHEET NO: 8 OF 9

DRAWN BY: MWT	PREPARED UNDER THE SUPERVISION OF DOUGLAS A THIES P.E. NO. 30637
CHECKED BY: DAT	REVIEWED _____ DATE: _____



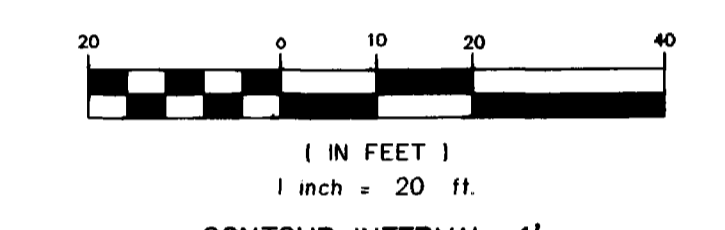
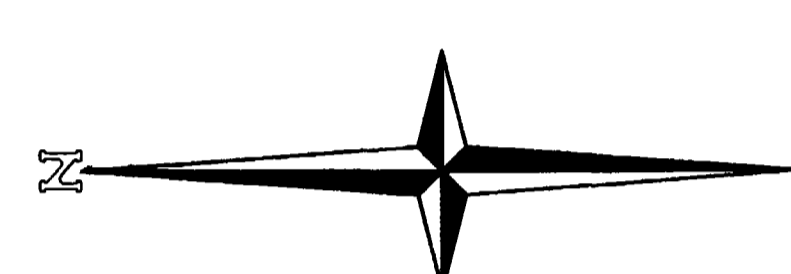
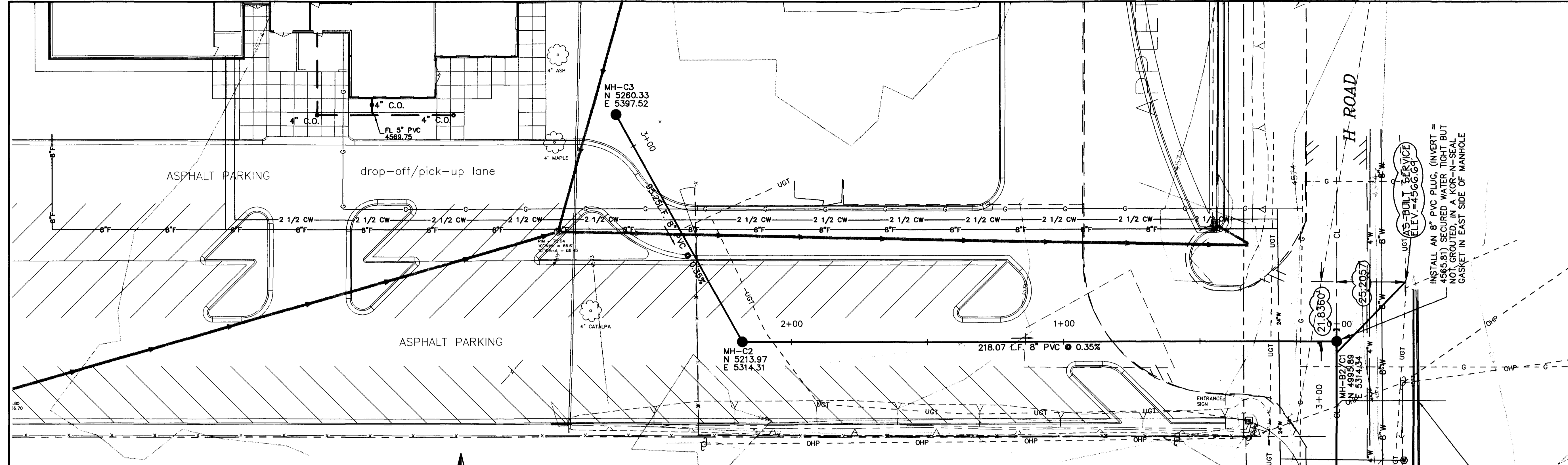

PROJECT BENCHMARK:  
MCSM AT THE INTERSECTION OF 23 1/2 ROAD  
AND H ROAD.  
ELEVATION 4574.82

**NOTE: APPLETON PARKING LOT IMPROVEMENTS  
ARE PROPOSED (NOT EXISTING)**

CALL UTILITY NOTIFICATION  
CENTER OF COLORADO  
**1-800-922-1987**  
OR **534-6700** IN METRO  
DENVER  
CALL 2 BUSINESS DAYS IN ADVANCE  
BEFORE YOU DIG, GRADE, OR EXCAVATE  
FOR THE MARKING OF UNDERGROUND  
MEMBER UTILITIES.

**GENERAL NOTES**

- ASPHALT REMOVAL AND REPLACEMENT (23 1/2 Road)
  - Removal of existing chip seal to be limited to existing roadway centerline.
  - Replacement is to consist of double penetration chip seal across entire roadway width.
  - One-way traffic is to be maintained during construction. A traffic control plan is to be submitted prior to construction.
- SEWER STUB-OUT (TAP) LOCATIONS ARE APPROXIMATE ONLY. CONTRACTOR SHALL COORDINATE WITH PROPERTY OWNER TO DETERMINE DESIRED TAP LOCATION.
- ENDS OF SEWER SERVICE STUBS ARE NOT TO BE BACK FILLED UNTIL "AS-BUILT" HORIZONTALLY AND VERTICALLY BY SURVEYORS.
- THE EXISTING 4" WATER LINE ON THE WEST SIDE OF H ROAD WILL BE ABANDONED PRIOR TO CONSTRUCTION OF SEWER LINE.

REVISED TO 'AS-BUILT'  
CONDITIONS ON 7/31/98

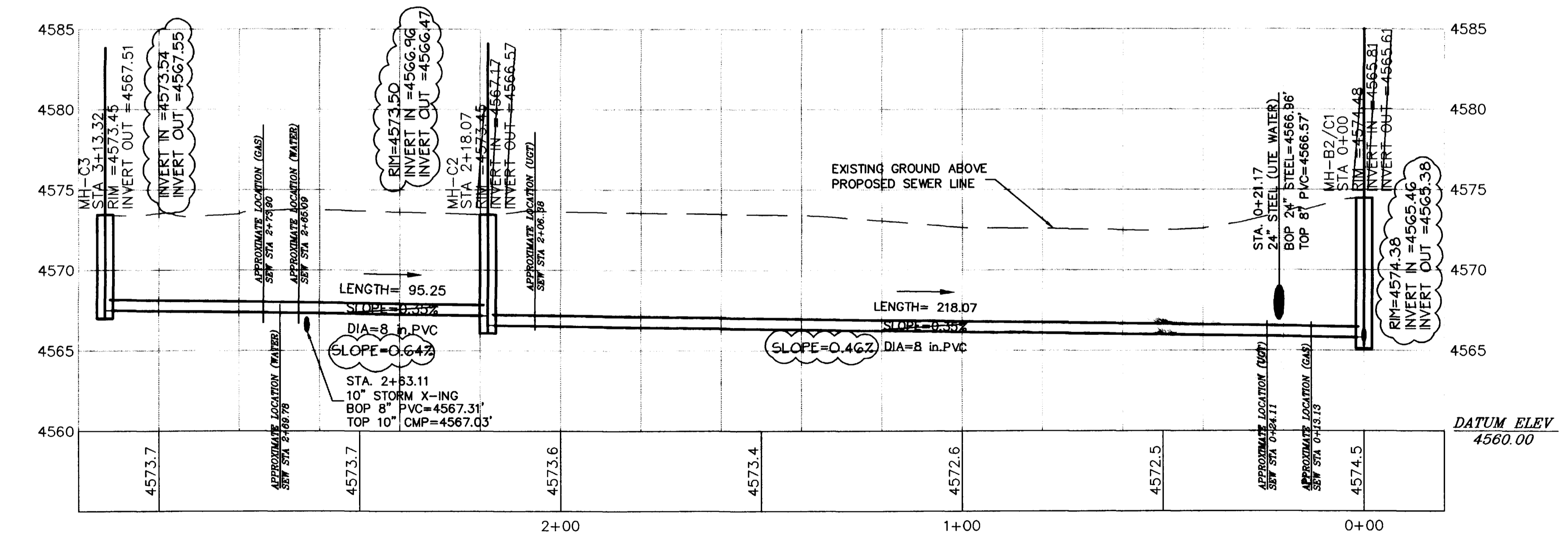

**SANITARY SEWER LINE-C**

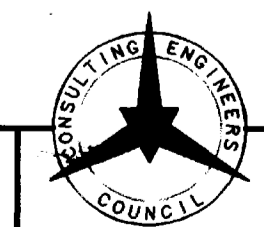

American Consulting  
Engineers Council  
Member  
**THOMPSON-LANGFORD CORP.**  
529 25 1/2 RD., SUITE B210  
GRAND JUNCTION, COLORADO  
PH. (970) 243-6067

REVISION	DATE	DESCRIPTION	BY	CHD

DRAWN BY: MWT	PREPARED UNDER THE SUPERVISION OF DOUGLAS A THIES P.E. NO. 30637	SCHOOL DISTRICT 51	GRAND JUNCTION	SCALE: Horiz: 1" = 20' Vert: 1" = 5'	Project No: 0031-012
CHECKED BY: DAT	REVIEWED DATE:	SANITARY SEWER LINE-C (SHEET 9 OF 9)		DATE: 3/23/98	SHEET NO. 9 OF 9