

NW COR SW 1/4 SEC 15  
FOUND BRASS CAP NO 114

NORTH

NORTH 382

S 49° 30' E  
118 to building

N 56° 34' 30" W  
70

N 70° 33' 30" W  
533.8

N 39° 16' 30" W  
114

N 75° 20'

380

N 50° 35' W  
97.5

141  
N 75° 30' W

N 78° 35' W  
218.8

S 8° 32' E  
132

10

260

COLORADO RIVER

WESTERN MEAT  
PACKING PLANT

HOUSE

SHED



SCALE 1 = 100

MAP OF  
WESTERN MEAT PACKING INC  
LOCATION OF BUILDING ON PROPERTY

MAY 21 1968

02094301.tif

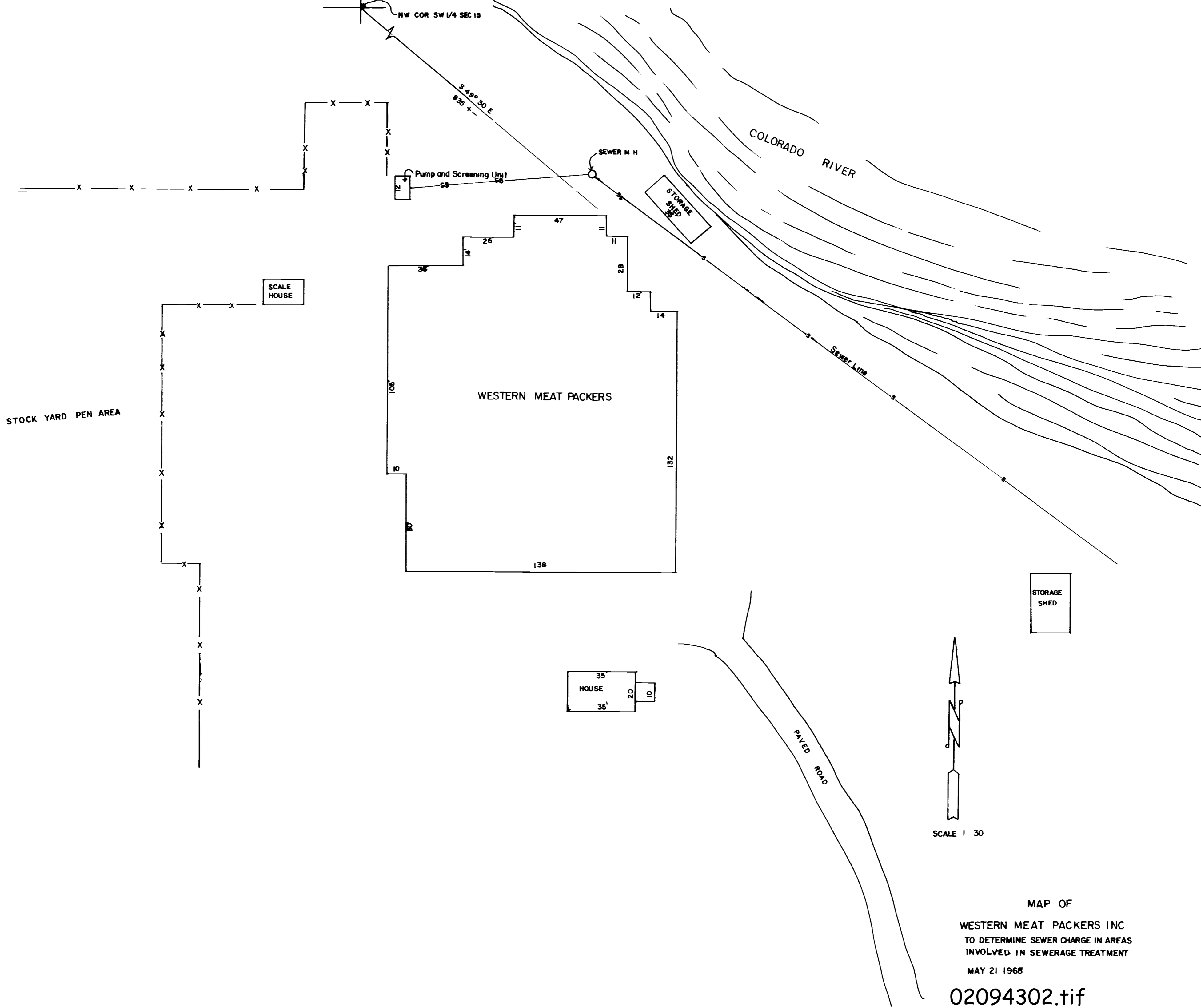

MAP OF  
 WESTERN MEAT PACKERS INC  
 TO DETERMINE SEWER CHARGE IN AREAS  
 INVOLVED IN SEWERAGE TREATMENT  
 MAY 21 1968

02094302.tif

PLAN	DATE	
	BY	
NO. 1	DATE	
	BY	
SUBMITTAL PROTECT ALIQUANT. CHG. KED RT. O. WAY. C. L. ED		

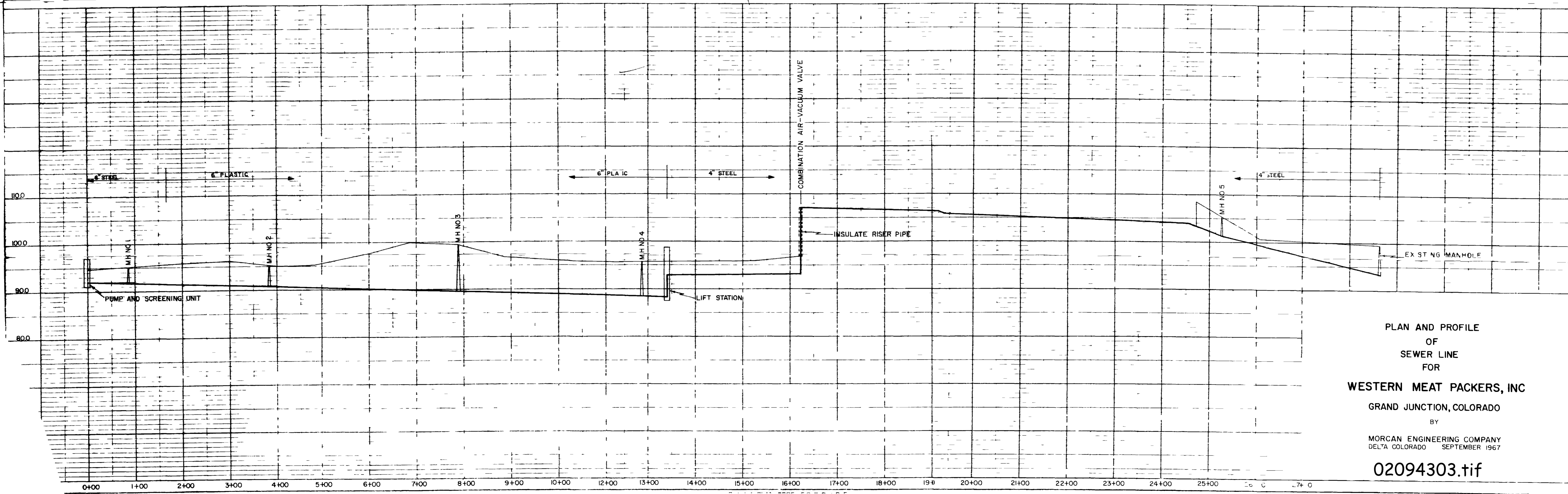
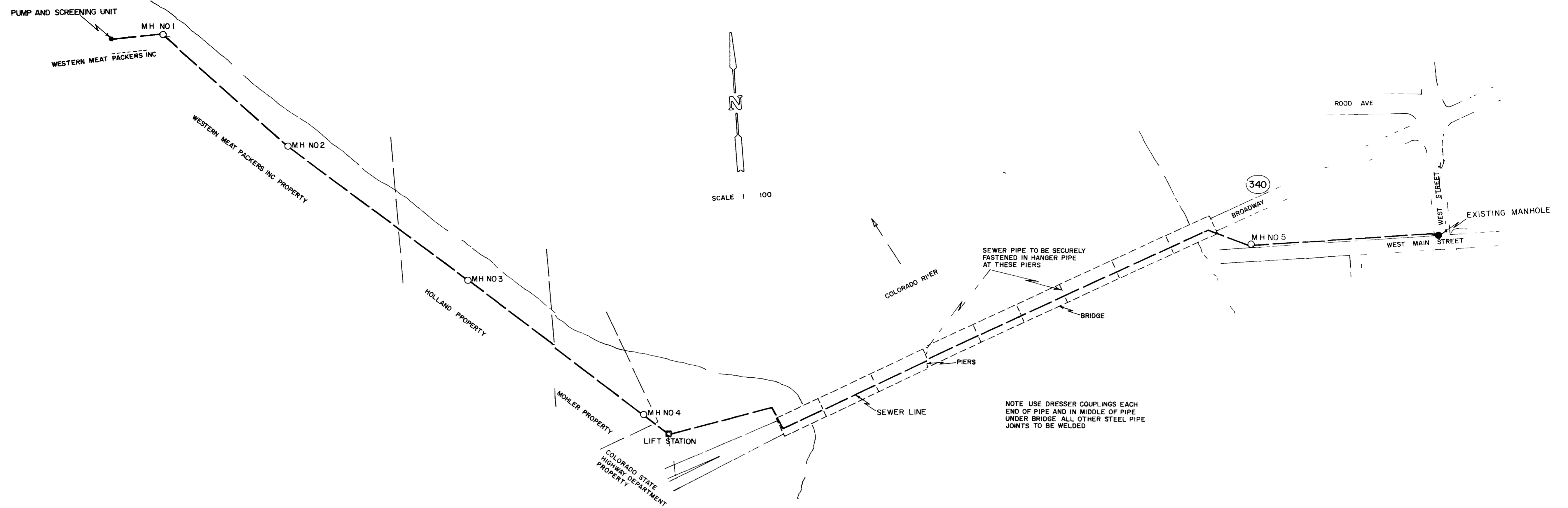

PLAN AND PROFILE  
 OF  
 SEWER LINE  
 FOR  
**WESTERN MEAT PACKERS, INC**  
 GRAND JUNCTION, COLORADO  
 BY  
 MORCAN ENGINEERING COMPANY  
 DELTA COLORADO SEPTEMBER 1967  
**02094303.tif**