

CONSTRUCTION NOTES

- ① ALLEY RESTORATION BY OTHERS.
- ② DRIVEWAY RESTORATION BY OTHERS.
- ③ NOTIFY PUBLIC SERVICE COMPANY 48 HOURS PRIOR TO EXCAVATIONS THAT WILL EXPOSE GAS OR ELECTRIC LINES.
- ④ FUTURE 3" DOMESTIC WATER SERVICE AND FUTURE 6" FIRE SPRINKLER WATER SERVICE BY OTHERS.
- ⑤ GAS SERVICE BY OTHERS.
- ⑥ FUTURE 12" STORM SEWER BY OTHERS.
- ⑦ 202.00 ABANDON EXISTING SANITARY SEWER SERVICE USING A CALDER COUPLING AND 6" OF 4" SDR-35 PVC GLUE-CAPPED ON THE OUTSIDE END. NO ENCASEMENTS NECESSARY. SEE DETAIL THIS SHEET.
- ⑧ POT HOLE THE EXISTING TAP LOCATION AS NECESSARY TO ENSURE NEW TAP IS INSTALLED DOWNSTREAM OF THE EXISTING SERVICE CONNECTION.
- 102.90 ALL SERVICE LINE CONNECTIONS TO THE NEW PVC SEWER MAIN SHALL BE ACCOMPLISHED WITH FULL BODY PVC WYE FITTINGS, 4" SDR 35 PVC PIPE, AND 45° BENDS. TAPPING SADDLES WILL NOT BE ALLOWED. EXTEND NEW SDR-35 PVC SERVICE LINE TO ROW.
- 210.00 RECONNECT EXISTING SERVICE LINE TO THE NEW 4" SDR-35 PVC USING A CALDER COUPLING. ENCASE JOINT WITH CONCRETE OR USE A MISSION COUPLING WITH OUT ENCASMENT. ALL EXISTING SERVICE LINE CONNECTIONS ENCOUNTERED NOT SHOWN ON THESE PLANS SHALL BE ABANDON PER CONSTRUCTION NOTE 7 UNLESS DIRECTED OTHERWISE BY PROJECT ENGINEER.
- ⑨ 102.90 ALL SERVICE LINE CONNECTIONS TO THE NEW PVC SEWER MAIN SHALL BE ACCOMPLISHED WITH FULL BODY PVC WYE FITTINGS, 4" SDR 35 PVC PIPE, AND 45° BENDS. TAPPING SADDLES WILL NOT BE ALLOWED.
- ⑩ EXISTING MANHOLE, THE FOLLOWING WORK SHALL BE DONE TO THIS MANHOLE: CLEAN EXISTING BASE AND POUR A NEW SMOOTH INVERT BETWEEN THE EXIST 6" SERV. IN AND THE NEW INVERT OUT.
- 210.00 REMOVE EXISTING STEPS FLUSH WITH BARREL SECTION AND REMOVE. REMOVE EXISTING BRICKS ABOVE CONE SECTION AND BRING EXIST RING AND COVER TO GRADE WITH GRADE RINGS.
- 202.00 CUT EXISTING STEPS FLUSH WITH BARREL SECTION AND REMOVE.
- 210.00 REMOVE EXISTING BRICKS ABOVE CONE SECTION AND BRING EXIST RING AND COVER TO GRADE WITH GRADE RINGS.

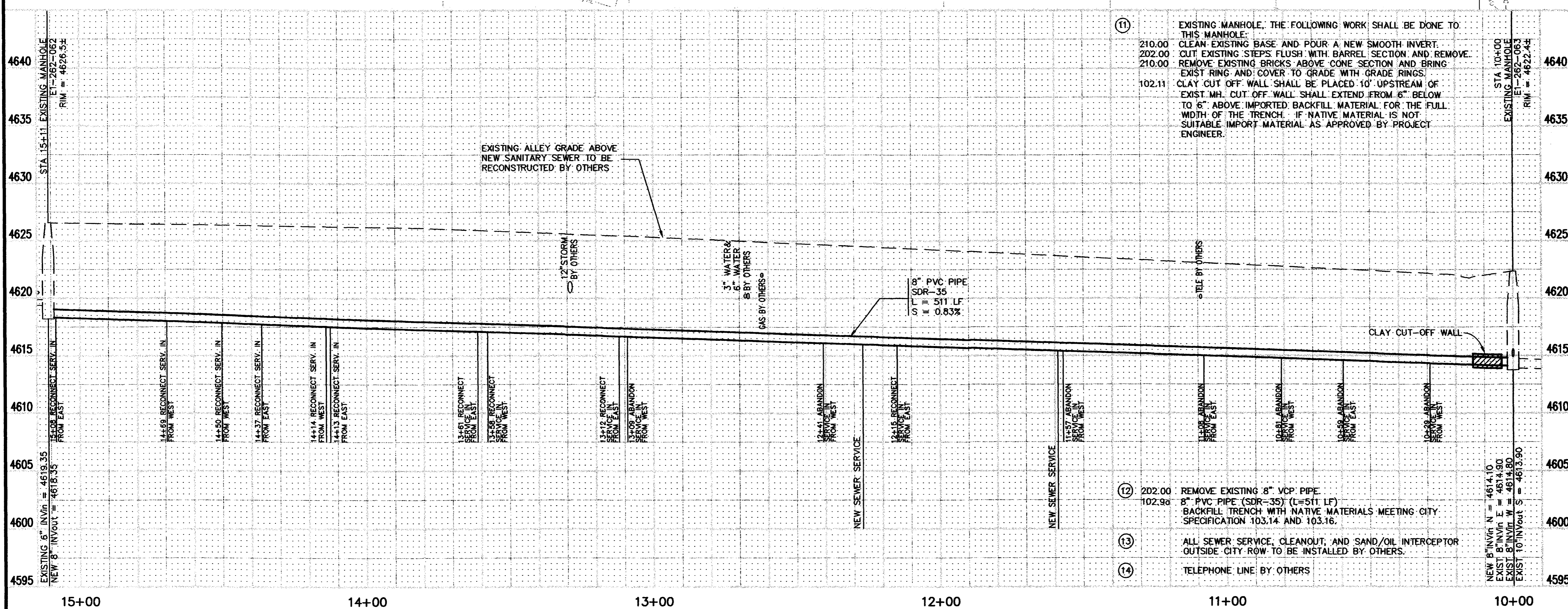
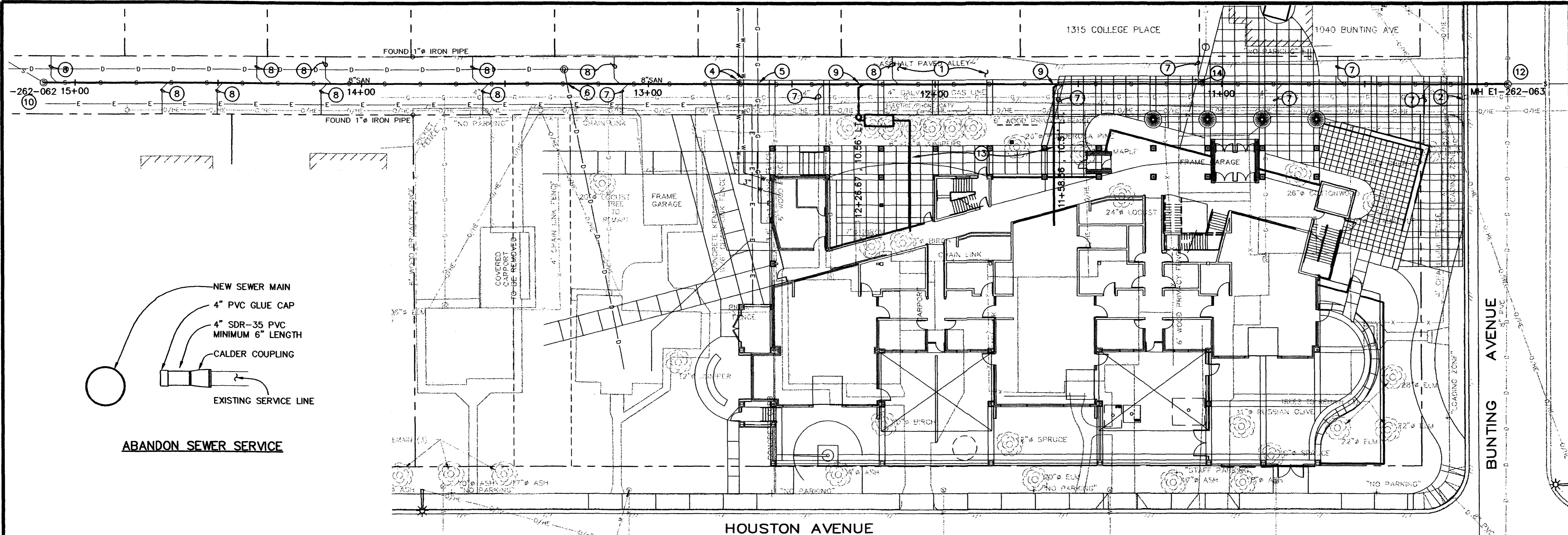

REVISION	DESCRIPTION	DATE	DRAWN BY	DATE	SCALE
REVISION Δ			JCS	11-2-2000	PLAN 1"=20'
REVISION Δ			JCS	11-2-2000	PROFILE 1"=20'
REVISION Δ			SBG	11-2-2000	HORIZ. 1"=20'
REVISION Δ					VERT. 1"=5'

**DEPARTMENT OF PUBLIC WORKS AND UTILITIES
ENGINEERING AND TECHNICAL SERVICES DIVISIONS
CITY OF GRAND JUNCTION, COLORADO**

**MESA STATE COLLEGE FINE ARTS BUILDING
SEWER LINE REPLACEMENT PLAN AND PROFILE 1
STA 10+00 TO STA 15+15**