

COLORADO AVENUE
EXIST 24" SAN.

CONSTRUCT NEW 8" PVC SEWER LINE FROM EXISTING MANHOLE TO NEW MANHOLE #1 PER THIS PLAN SHEET AND SPECIFICATIONS FOR 1998 SEWER REPLACEMENTS

COAT THE ENTIRE INTERIOR OF THE EXISTING MH. WITH EPOXY-COLDTAR. THE COATING SHALL BE A MINIMUM OF 16MILS THICK, WITH 2 COATS OR 1 COAT OF HIGH-BUILD POLYAMIDES SUCH AS SHERWIN-WILLIAMS HI-MIL SHER-TAR EPOXY, OR APPROVED EQUAL. APPLICATION SHALL BE PER MANUFACTURES SPECIFICATIONS.

THE EXISTING 8" PVC LINE RUNS NORTH TO SOUTH THROUGH THE MH. CUT THE EXISTING 8" PVC 4" FROM THE NORTH MANHOLE WALL AND FLUSH WITH THE SOUTH MANHOLE WALL TO ALLOW FLOW TO DISCHARGE TO THE EXISTING 24" RCP LINE. FILL THE SOUTH 8" OUTLET PIPE WITH NON-SHRINK GROUT TO ABANDON THE LINE. APPLY EPOXY TO GROUT SURFACE AFTER GROUT IS CURED.

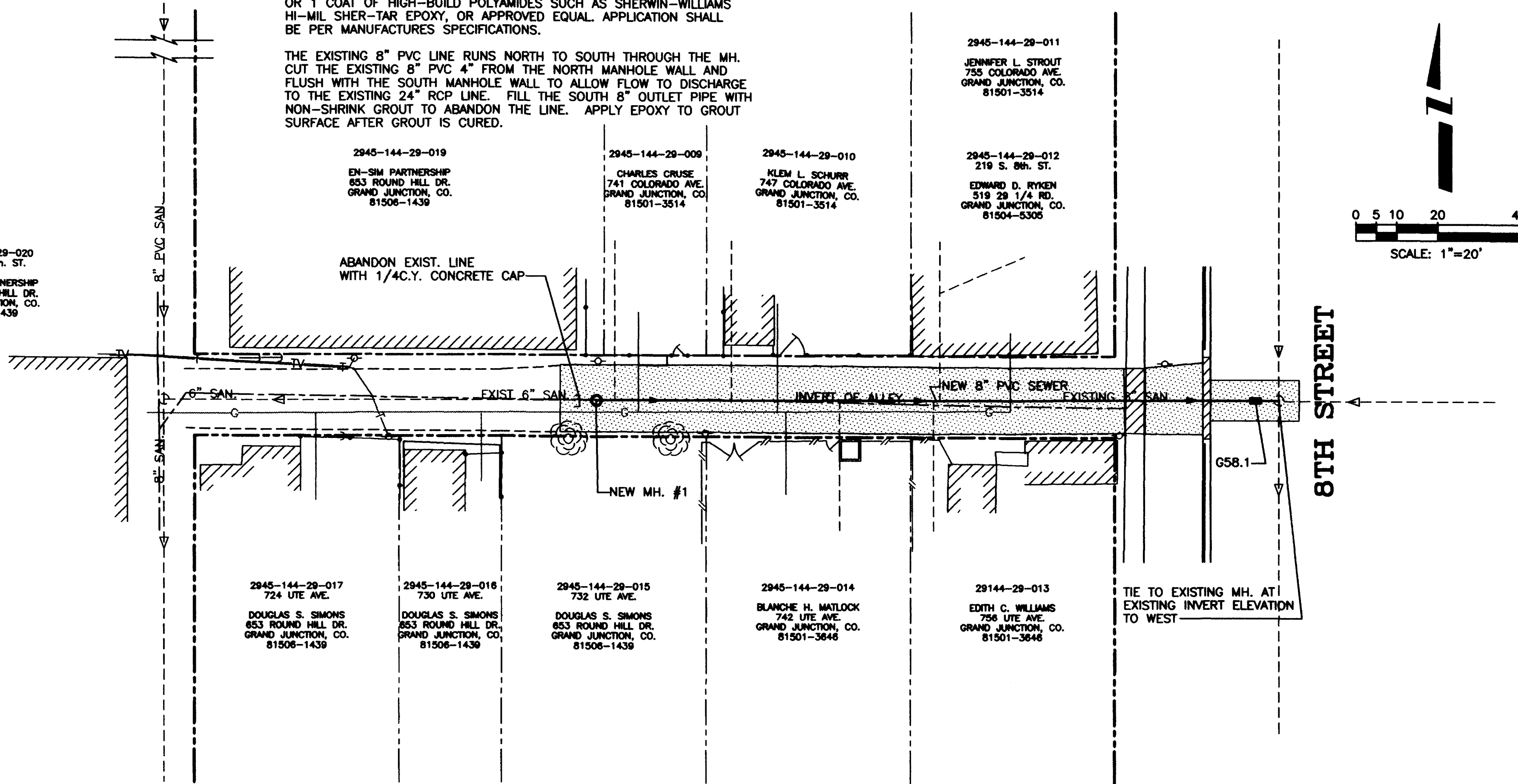

CONSTRUCTION NOTES:

- 20.1 CONSTRUCT 8" SDR 35 PVC SANITARY SEWER.
- 21.1 CONNECT THE PROPOSED SEWER LINE TO THE EXISTING MH. AND GROUT SEAL AROUND PIPE.
- 24.2 REPLACE ALL EXISTING ACTIVE SEWER SERVICE FROM THE NEW SEWER TAP TO THE ALLEY ROW OR AT 3 FEET MAXIMUM LENGTH IN THE STREET ROW.
- 24.8 INSTALL FULL BODY WYE SEWER TAP AND CONNECT TO ALL ACTIVE EXISTING SEWER SERVICES (INCLUD WYE, RISER PIPE, AND BEND).
- G58.1 CONSTRUCT CUT-OFF WALL PER STANDARD SPECIFICATIONS.
- 202.37 REMOVE CONCRETE CURB, GUTTER, SIDEWALKS, DRIVEWAYS, PAVEMENT AND/OR SLABS TO JOINTS OR DIMENSIONS WHERE SHOWN; OTHERWISE, REMOVE AS REQUIRED FOR CONSTRUCTION. SAWCUT AS NECESSARY.
- 202.42 REMOVE ASPHALT PAVEMENT AS REQUIRED FOR CONSTRUCTION.
- G202.42 THIS ALLEY MAY HAVE ASPHALT PAVEMENT, THE REMOVAL OF WHICH IS UNCLASSIFIED, AND SHALL BE PAID FOR UNDER THE APPLICABLE BID SCHEDULE ITEM.
- G202.53 REMOVE SANITARY SEWER.
- 608.31 CONSTRUCT CONCRETE DRIVEWAY.
- 609.0 CONSTRUCT CONCRETE VALLEY PAN GUTTER.

UTE AVENUE

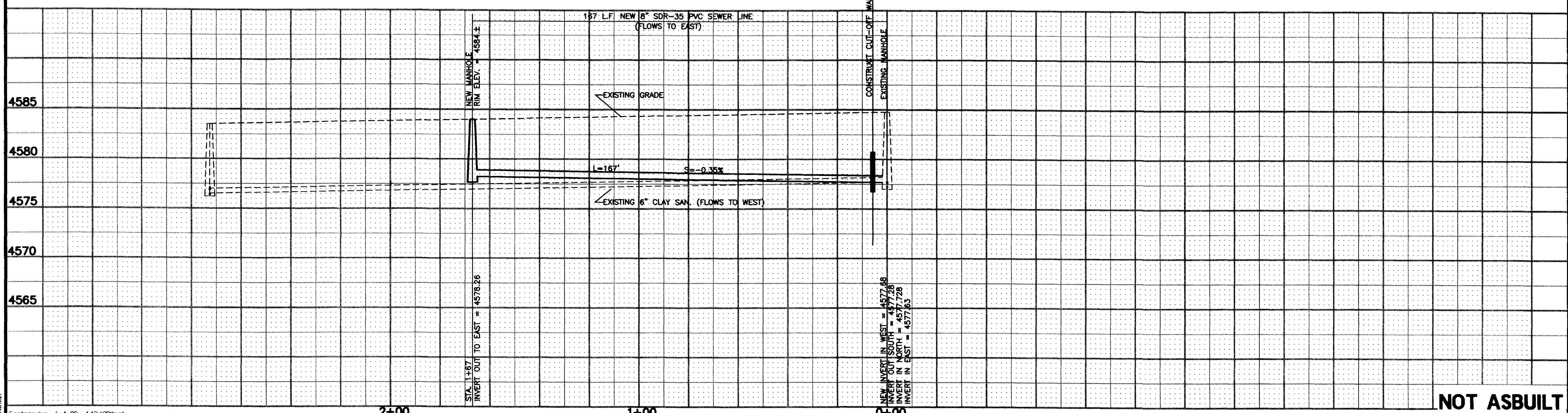

NOT ASBUILT

Enstrom.dwg 6-4-98 4:43:48Pmst	2+00	1+00	0+00
REVISION Δ	DESCRIPTION	DATE	
REVISION Δ			
REVISION Δ			
REVISION Δ			
REVISION Δ			
DRAWN BY	L. MARTIN	DATE	6/4/98
DESIGNED BY	B.G.	DATE	6/4/98
CHECKED BY	B.G.	DATE	6/4/98
APPROVED BY		DATE	
SCALE			
PLAN	1"=20'	PROFILE	1"=20'
HORIZ.	1"=20'	HORIZ.	1"=20'
VERT.	1"=5'	VERT.	1"=5'

**DEPARTMENT OF PUBLIC WORKS AND UTILITIES
ENGINEERING AND TECHNICAL SERVICES DIVISIONS
CITY OF GRAND JUNCTION, COLORADO**

**1998 SEWER LINE REPLACEMENTS
ENSTROM ALLEY
Plan & Profile**