

2701-353-13-014
DAVID P. & LEANORE N.
LEHMANN
720 IVANHOE WAY
GRAND JUNCTION, CO.
81506-8359

2701-353-13-004
FARSTER W. BELGARD
718 IVANHOE WAY
GRAND JUNCTION, CO.
81506-8359

2701-353-13-015
716 IVANHOE WAY
RUSSELL D. & TAMI L.
PARKER
PO BOX 3407
GRAND JUNCTION, CO.
81502-3407

2701-353-13-005
GARY LOREN & GAYDRA LEA
MCCALLISTER
714 IVANHOE WAY
GRAND JUNCTION, CO.
81506-8359

2701-353-13-019
SUZANNE M. POTRATZ &
JACK ANTHONY PESTELLO
712 IVANHOE WAY
GRAND JUNCTION, CO.
81506-8359

2701-353-17-014
STEVE & ROSALIE TRUJILLO
719 IVANHOE WAY
GRAND JUNCTION, CO.
81506-8338

2701-353-17-013
JAMES R. & CHERYL A.
MOE
717 IVANHOE WAY
GRAND JUNCTION, CO.
81506-8338

2701-353-17-012
RUSSELL E. & CYNTHIA A. TURNER
715 IVANHOE WAY
GRAND JUNCTION, CO.
81506-8338

2701-353-17-011
SANDRA J. COOPER
713 IVANHOE WAY
GRAND JUNCTION, CO.
81506-8338

CONSTRUCTION NOTES:

- 1a INSTALL 6" C900, CLASS 150 PVC PIPE W/TRACER WIRE. MINIMUM SLOPE +0.4%, MINIMUM 48" COVER.
- 1b CONTRACTOR SHALL VERIFY DEPTH OF EXISTING FORCEMAIN PRIOR TO PLACEMENT OF NEW FORCEMAIN. DEPTH OF EXISTING FORCEMAIN IS APPROX. 7'.
- 1c CLEANOUT PER DETAIL SHEET NO. 2
- 2a ASPHALT PATCH - 6" AGGREGATE BASE COURSE, 3" HOT BITUMINOUS PAVEMENT.
- 2b ASPHALT CUT & PATCH - CUT ASPHALT TO A STRAIGHT LINE ONE FOOT FROM THE TOP OF TRENCH. CUT ASPHALT PERPENDICULAR TO THE EXISTING EDGE. THE MINIMUM WIDTH OF PATCH OR OF EXISTING ASPHALT TO REMAIN BETWEEN THE EDGE AND THE PATCH SHALL BE 4 FEET.
- 2c SHOULDER REPAIR - 6" AGGREGATE BASE COURSE. MAXIMUM PAY WIDTH - 6'. THE SHOULDER AREA OUTSIDE THE PAY WIDTH SHALL BE PROTECTED FROM CONTAMINATION OR RESTORED BY THE CONTRACTOR. IF EXISTING GRAVEL IS NOT ALL AGGREGATE BASE COURSE CONSULT WITH PROPERTY OWNER AND MATCH EXISTING MATERIAL OR INSTALL A.B.C. AS THEY DESIRE.
- 3a REMOVE & REPLACE BARRICADE AS NEEDED.
- 4a TIE INTO EXISTING LIFT STATION, COORDINATE WITH LARRY BROWN AT THE PERSIGO WASTEWATER TREATMENT PLANT 244-1590.

NOT AS BUILT

REVISION	DESCRIPTION	DATE	DRAWN BY	DATE	SCALE
REVISION Δ			L. MARTIN	11/15/95	PLAN 1"=20'
REVISION Δ			I. PRALL	11/15/95	PROFILE 1"=20'
REVISION Δ			I. PRALL	11/15/95	VERT. 1"=5'
REVISION Δ					

DEPARTMENT OF PUBLIC WORKS AND UTILITIES
ENGINEERING DIVISION
CITY OF GRAND JUNCTION, COLORADO

JASMINE LIFT STATION
FORCEMAIN REPLACEMENT
Plan Sheet No. 1

SHEET NO. 1
OF 2
FILE NO. ?DWG

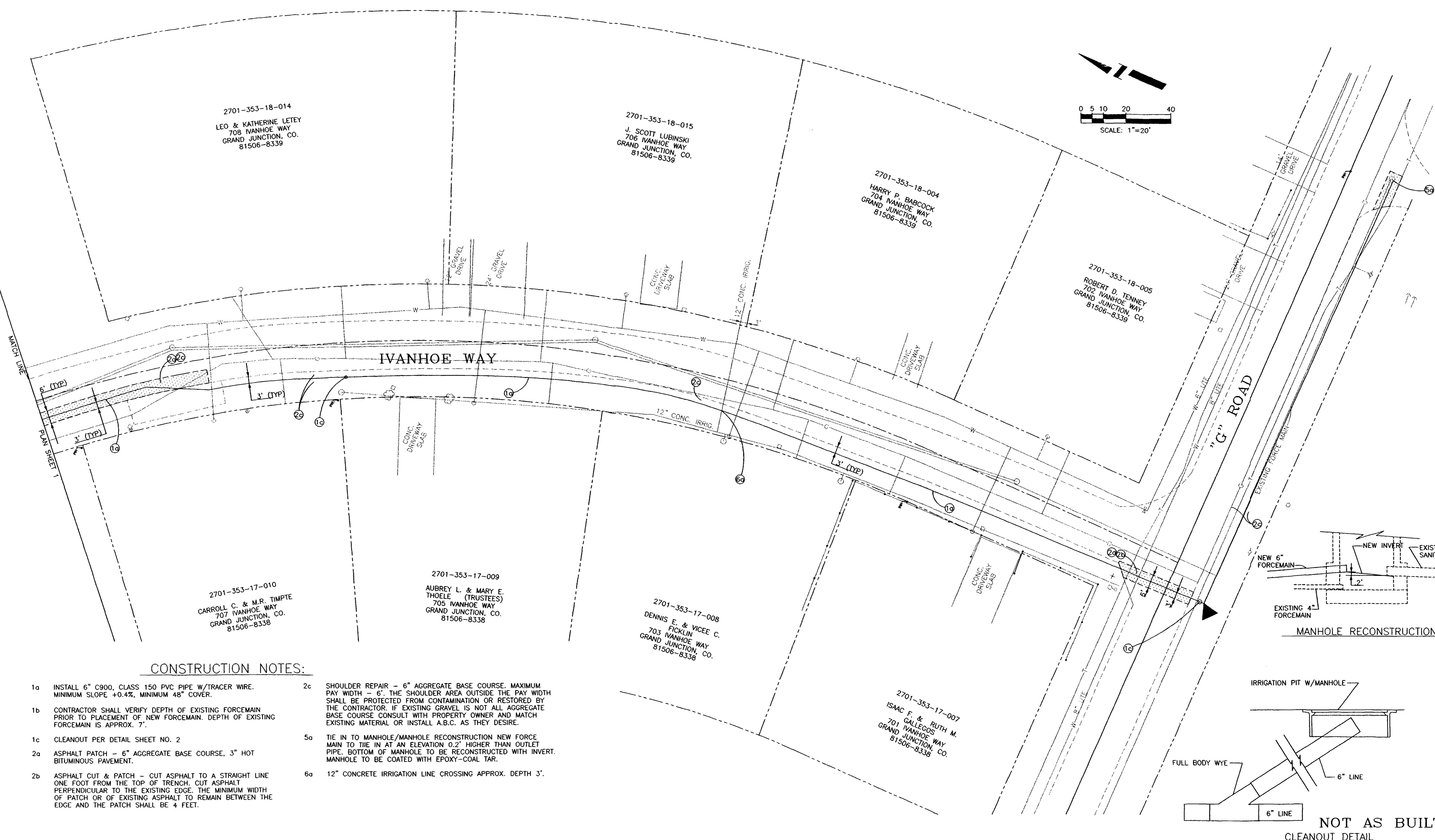

CONSTRUCTION NOTES:

- 1a INSTALL 6" C900, CLASS 150 PVC PIPE W/TRACER WIRE. MINIMUM SLOPE +0.4%, MINIMUM 48" COVER.
- 1b CONTRACTOR SHALL VERIFY DEPTH OF EXISTING FORCEMAIN PRIOR TO PLACEMENT OF NEW FORCEMAIN. DEPTH OF EXISTING FORCEMAIN IS APPROX. 7'.
- 1c CLEANOUT PER DETAIL SHEET NO. 2
- 2a ASPHALT PATCH - 6" AGGREGATE BASE COURSE, 3" HOT BITUMINOUS PAVEMENT.
- 2b ASPHALT CUT & PATCH - CUT ASPHALT TO A STRAIGHT LINE ONE FOOT FROM THE TOP OF TRENCH. CUT ASPHALT PERPENDICULAR TO THE EXISTING EDGE. THE MINIMUM WIDTH OF PATCH OR OF EXISTING ASPHALT TO REMAIN BETWEEN THE EDGE AND THE PATCH SHALL BE 4 FEET.
- 2c SHOULDER REPAIR - 6" AGGREGATE BASE COURSE. MAXIMUM PAY WIDTH - 6'. THE SHOULDER AREA OUTSIDE THE PAY WIDTH SHALL BE PROTECTED FROM CONTAMINATION OR RESTORED BY THE CONTRACTOR. IF EXISTING GRAVEL IS NOT ALL AGGREGATE BASE COURSE CONSULT WITH PROPERTY OWNER AND MATCH EXISTING MATERIAL OR INSTALL A.B.C. AS THEY DESIRE.
- 5a TIE IN TO MANHOLE/MANHOLE RECONSTRUCTION NEW FORCE MAIN TO TIE IN AT AN ELEVATION 0.2' HIGHER THAN OUTLET PIPE. BOTTOM OF MANHOLE TO BE RECONSTRUCTED WITH INVERT. MANHOLE TO BE COATED WITH EPOXY-COAL TAR.
- 6a 12" CONCRETE IRRIGATION LINE CROSSING APPROX. DEPTH 3'.

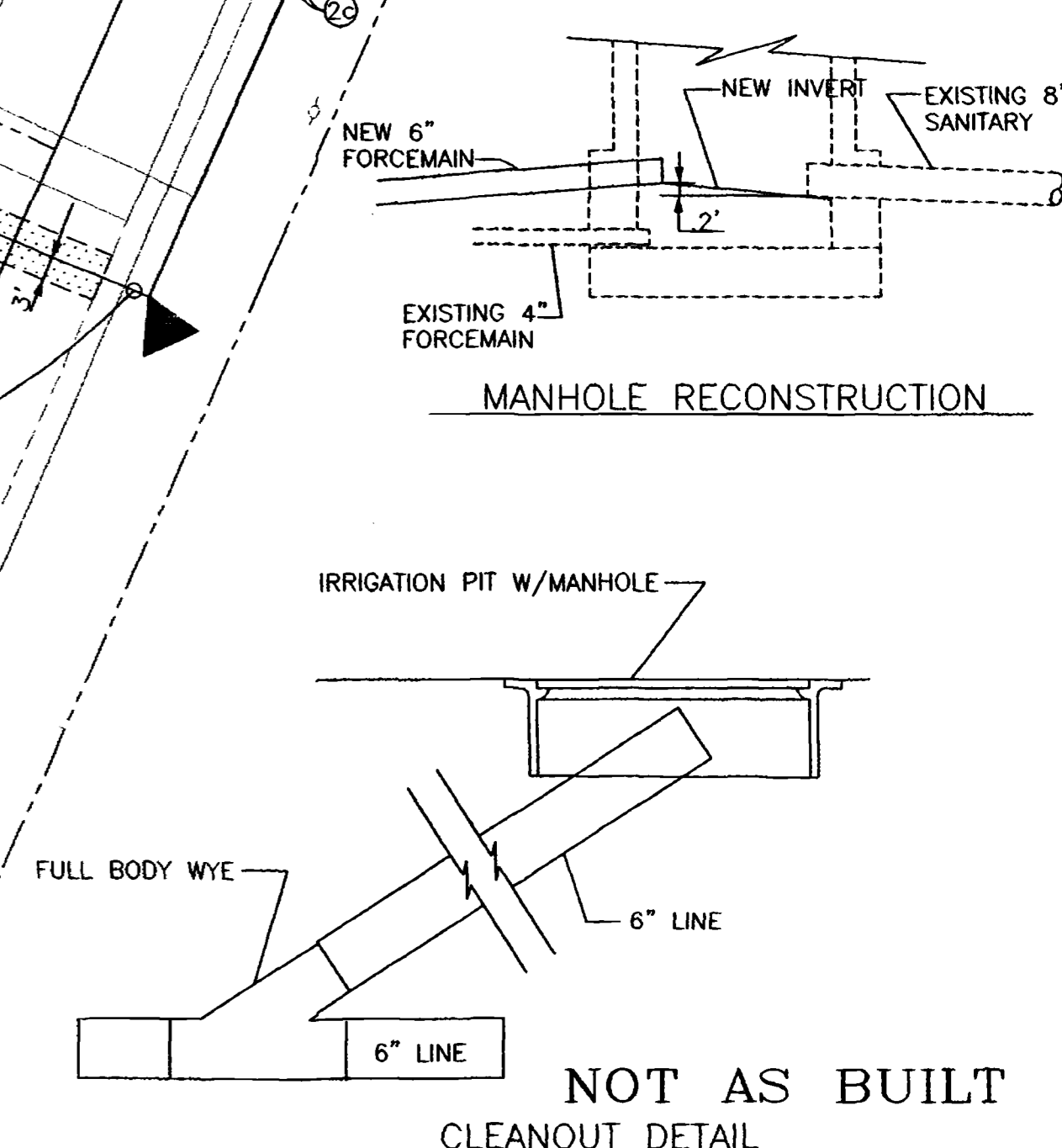

NOT AS BUILT
CLEANOUT DETAIL

REVISION	DESCRIPTION	DATE	DRAWN BY	DATE	SCALE
REVISION Δ			L. MARTIN	11/15/95	PLAN 1"=20'
REVISION Δ			T. PRALL	11/15/95	PROFILE 1"=20'
REVISION Δ			T. PRALL	11/15/95	VERT. 1"=5'
REVISION Δ					

DEPARTMENT OF PUBLIC WORKS AND UTILITIES
ENGINEERING DIVISION
CITY OF GRAND JUNCTION, COLORADO

JASMINE LIFT STATION
FORCEMAIN REPLACEMENT
Plan Sheet No.2

SHEET NO. 2
OF 2
FILE NO. IVANHOE2.DWG