

NOTE:
 DAKOTA DRIVE IS A MESA COUNTY ROAD. A MESA COUNTY PERMIT WILL BE REQUIRED FOR EXCAVATION. PAVEMENT WILL BE REPLACED IN ACCORDANCE WITH MESA COUNTY STANDARDS.
 JOINT FOR NEW PAVEMENT IS NOT TO BE IN "TIRE LANE" OF ROAD.

NOTE:
 UTILITY SERVICE LINES WERE NOT ALL FIELD LOCATED. IT IS THE CONTRACTOR'S RESPONSIBILITY TO LOCATE THESE IN THE FIELD PRIOR TO CONSTRUCTION.

EX. MH CI-221-003

N: 400.82 T: 999.00
 E: 897.45 C: 602.42
 SET MANHOLE 6' FROM CENTER TO EDGE OF PAVEMENT

L=129.85'
 R=379.00'
 $\Delta=19^{\circ}37'51''$
 C LEN=129.22'
 BRG=S23^{\circ}37'37''W

L=39.77'
 R=221.00'
 $\Delta=10^{\circ}18'38''$
 C LEN=39.72'
 BRG=N71^{\circ}01'00''W

RECORD DRAWING

NOTES

- CERTIFICATION OF THESE RECORD DRAWINGS BY THE REGISTERED PROFESSIONAL ENGINEER SHOWN DOES NOT CONSTITUTE CERTIFICATION THAT THE IMPROVEMENTS SHOWN ON THESE DRAWINGS WERE BUILT IN ACCORDANCE WITH THE APPROVED PLANS OR IN ACCORDANCE WITH THE STANDARDS AND REQUIREMENTS OF THE ACCEPTING AGENCY OR ENTITY. THE INTENT OF THESE RECORD DRAWINGS IS TO PROVIDE REPRESENTATION OF THE PHYSICAL LOCATION OF THE IMPROVEMENTS AND THE TYPES OF MATERIALS INSTALLED.
- CERTIFICATION OF THESE RECORD DRAWINGS BY THE REGISTERED PROFESSIONAL ENGINEER SHOWN DOES NOT INCLUDE CERTIFICATION OF THE AS-BUILT ELEVATIONS SHOWN. THE AS-BUILT ELEVATIONS OF IMPROVEMENTS SHOWN ON THESE DRAWINGS WERE PROVIDED BY THE SURVEY DEPARTMENT AT LANDesign, LLC.

SEWER COLLECTION SYSTEM IMPROVEMENTS SHOWN ON THIS SHEET WERE INSTALLED AUGUST 7, 2006 BY PROFESSIONAL PIPELINE & CONCRETE OF GRAND JUNCTION, COLORADO

NOTE:
 COORDINATES GIVEN ARE NOT ON MESA COUNTY COORDINATE SYSTEM

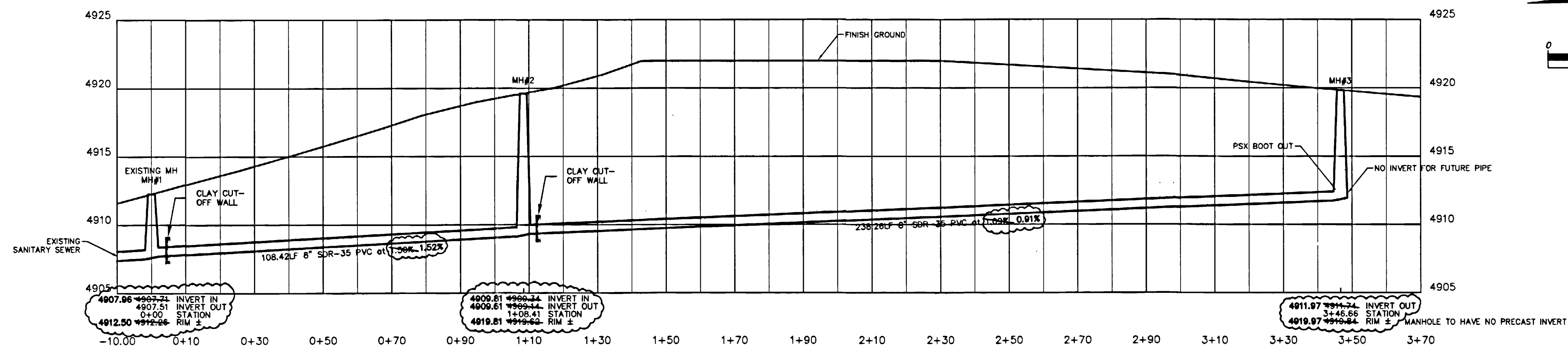
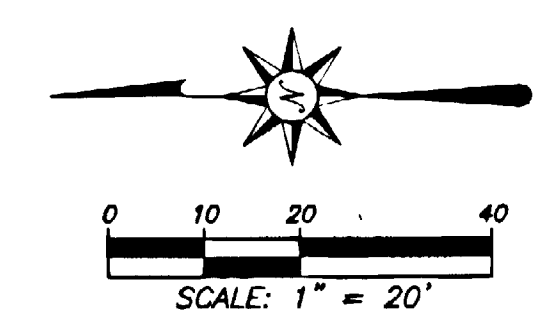

SANITARY SEWER LINE
 HORIZONTAL SCALE: 1" = 20'
 VERTICAL SCALE: 1" = 5'

CITY OF GRAND JUNCTION
 ACCEPTED FOR CONSTRUCTION FOR ONE YEAR FROM THIS DATE.
 BY: _____ DATE: _____
 ACCEPTED AS CONSTRUCTED
 _____ DATE: _____

DATE:	NO:	REVISION:	BY:

RECORD DRAWINGS
 SANITARY SEWER PLAN
 & PROFILE

WILLIAM MCNEESE
 and SHERRON HELMS
 2202 E. MORRISON CT.

LANDesign
 Consulting Engineers
 326 MAIN STREET SUITE 100
 GRAND JUNCTION, COLORADO 81501 (970) 245-4099

PROJECT NO.: 206023 FILE NAME: 206023-MCNEESE
 DRAWN: ARC
 CHK'D: WSW
 DATE: 4/28/06

COLORADO REGISTERED PROFESSIONAL ENGINEER
 No. 38264
 6/22/06

SHEET 1 OF 1