

NOTE: HORIZONTAL LOCATION IS SCHEMATIC. ONLY DISTANCES WERE MEASURED BETWEEN MANHOLE STRUCTURES FOR THE COMPUTATION OF SLOPE GRADIENTS.

	CONSULTING ENGINEERS/LAND SURVEYORS 2150 Hwy. 6 & 50, Grand Junction, CO 81505 • 303/242-5202
	SEWER INVERT ELEV. CHECKS PIPELINE CONSTRUCTION AT GRAND JUNCTION HIGH SCHOOL for M.A. CONCRETE
SURVEY 6/15/89 RAM	W.O. 2426

02.113200/02113201

5th STREET

GLENWOOD AVE.

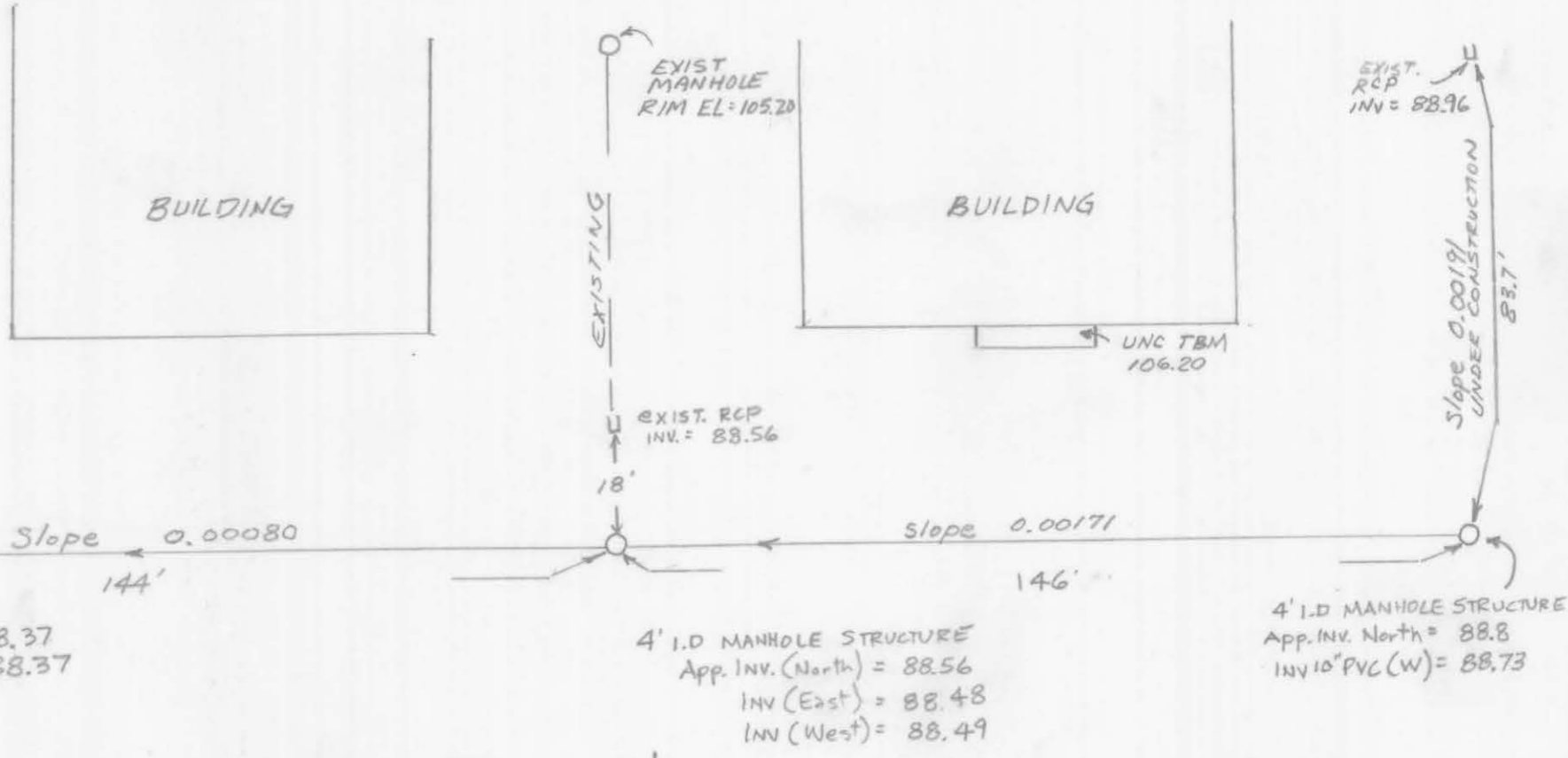

NOTE: HORIZONTAL LOCATION IS SCHEMATIC. ONLY DISTANCES WERE MEASURED BETWEEN MANHOLE STRUCTURES FOR THE COMPUTATION OF SLOPE GRADIENTS.

SCALE 1" = 30'

	CONSULTING ENGINEERS/LAND SURVEYORS <small>2150 Hwy. 6 & 50, Grand Junction, CO 81505 • 303/242-5202</small>
	SEWER INVERT ELEV. CHECKS PIPELINE CONSTRUCTION AT GRAND JUNCTION HIGH SCHOOL
By	M.A. CONCRETE
SURVEY 7/5/89 RAM	W.O. 2426

02113202