

LEGEND

- () FOUND 1 1/2" ALUMINUM CAP STAMPED "LS 17485"
- * FOUND BRASS TAG IN WALK STAMPED "LS 17485"
- FOUND 2" ALUMINUM CAP STAMPED "WESTERN ENG LS 18468"
- WM WATER METER
- K FIRE HYDRANT
- W WATER VALVE
- T TELEPHONE PEDESTAL
- x UTILITY POLE
- E SIGN
- FENCE LINE
- SEWER LINE
- EDGE OF ASPHALT
- WATER LINE
- GAS LINE
- OVERHEAD UTILITY LINE
- CONCRETE

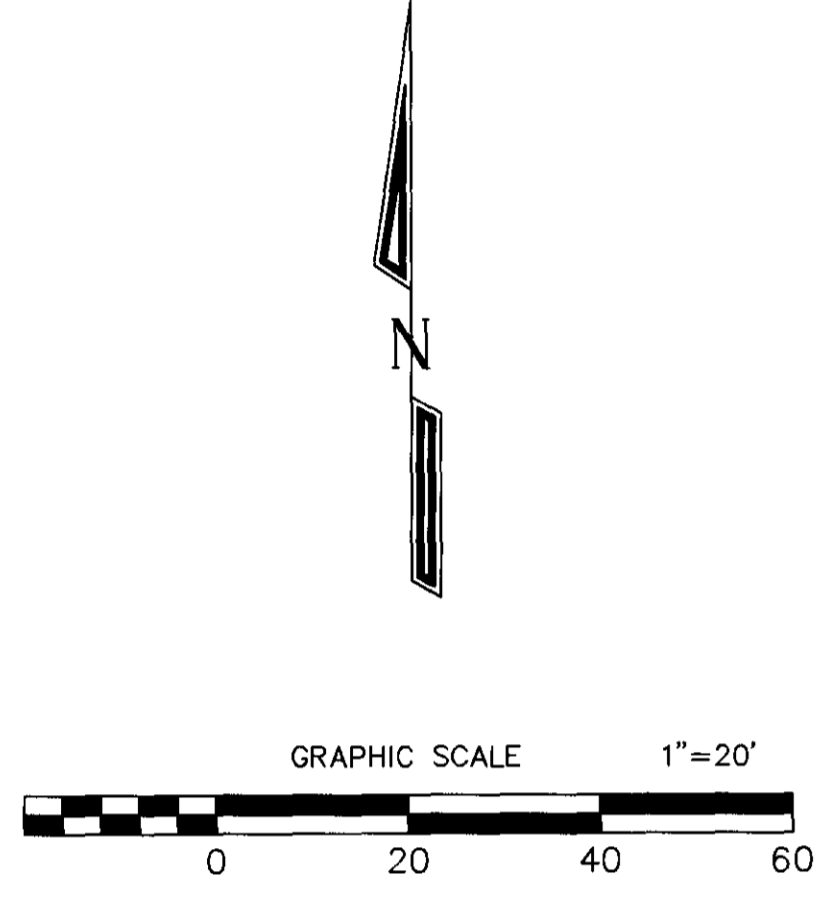

DESIGNED BY	DRH
DRAWN BY	DRH
SURVEY DATE	

REVISIONS	BY	REMARKS	DATE			
			1	2	3	4

2498 INDUSTRIAL BOULEVARD
AS BUILT DRAWING

PROFESSIONAL ENGINEERS
Grand Junction, Colorado 81501 Phone: 970-985-9865

518 28 Road, Suite 4000

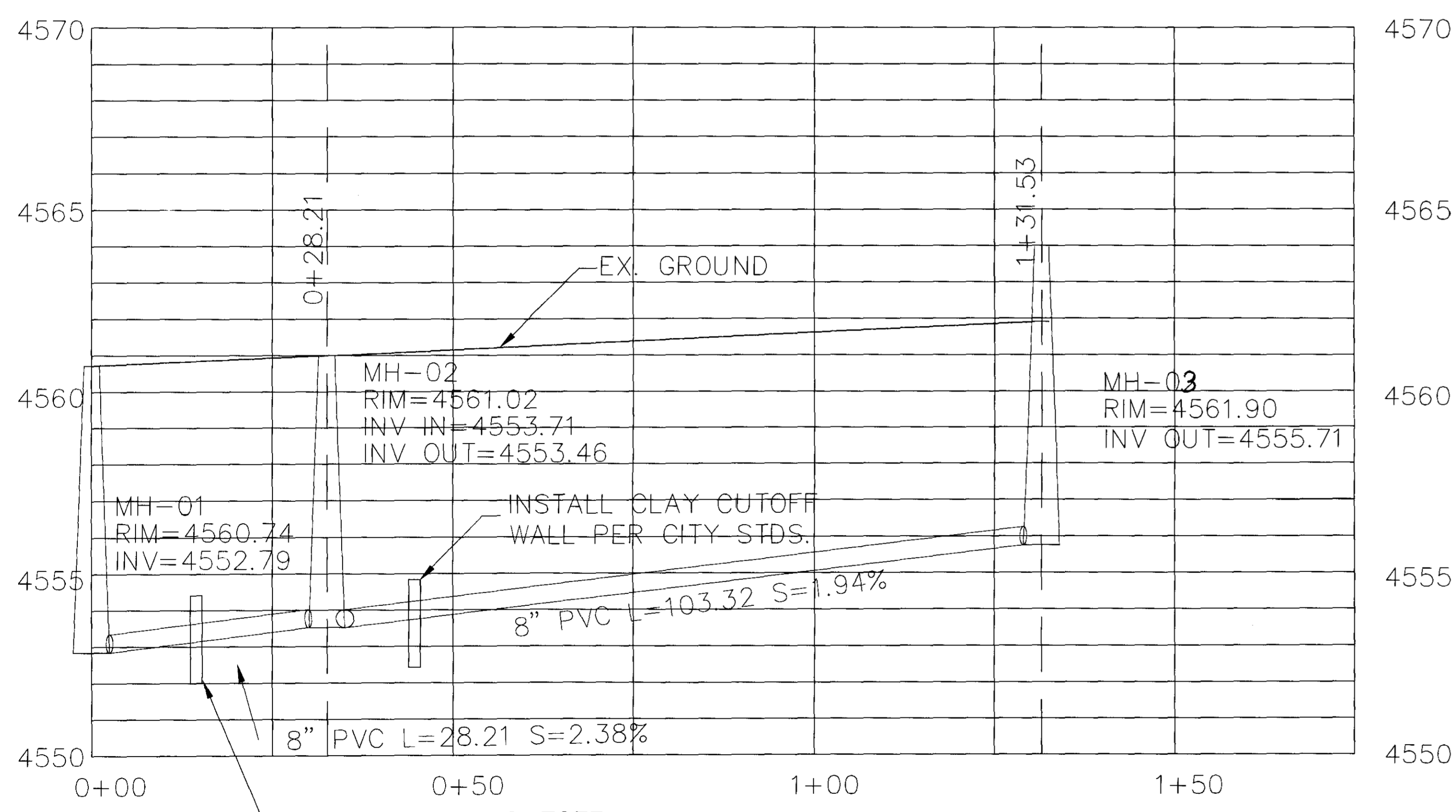

PROFILE

MH SCHEDULE

STRUCTURE NUMBER	NORTHING	EASTING	STRUCTURE TYPE	RIM ELEVATION	INVERT ELEVATION
MH-01	43714.12	83900.32	48" MH	4560.74	4552.79
MH-02	43734.04	84920.28	48" MH	4561.02	4553.59
MH-03	43733.04	84023.60	48" MH	4561.90	N/A

- NOTES: FIELD VERIFY INVERT ELEVATION OF MH-01. CONTACT ENGINEER IN CASE OF DISCREPANCY BORE 12" DIA. HOLE IN MH-01 TO EXTEND SEWER.
- LOCATION OF UTILITIES PROVIDED BY OTHERS. CONTRACTOR MUST VERIFY ALL EXISTING UTILITIES PRIOR TO CONSTRUCTION.
- ALL CONSTRUCTION SHALL BE IN ACCORDANCE WITH CITY OF GRAND JUNCTION JUNE 2007 STANDARD CONTRACT DOCUMENTS FOR CAPITAL IMPROVEMENTS CONSTRUCTION.

APPROVED FOR CONSTRUCTION	ACCEPTED AS CONSTRUCTED FOR ONE YEAR FROM THIS DATE
CITY OF GRAND JUNCTION - ENGINEER	CITY OF GRAND JUNCTION - ENGINEER
DATE	DATE
CITY OF GRAND JUNCTION - COMMUNITY DEVELOPMENT	CITY OF GRAND JUNCTION - COMMUNITY DEVELOPMENT
DATE	DATE

UTILITY PLAN & PROFILE

D. HILLEARY ENGINEERING

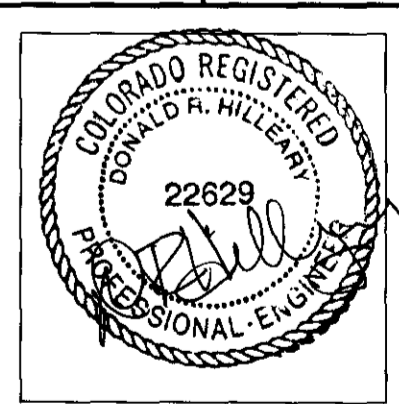

DATE DRAWN	07/02/07
SCALE	1" = 20'
PROJECT NUMBER	
SHEET NUMBER	1 OF 1